

## PT419W-PTZ-NDI-TMN



19" PTZ POE++ NDI Teleprompter & NDI Talent Monitor w/ Full NDI Encoding/Decoding & IP Tally Light



## OVERVIEW

Our NDI PTZ Teleprompter features Full NDI (Network Device Interface) encoding/decoding, as well as traditional 3G-SDI, HDMI, Composite and VGA, inputs. NDI is a video-over-IP protocol that allows for high-quality, low-latency video transmission over standard Ethernet networks. Our NDI teleprompter can be connected to a network using standard Ethernet cables, eliminating the need for dedicated video cables or specialized hardware. In addition, the teleprompter utilizes PoE++ technology that allows both power and NDI data to be transmitted through a single Ethernet cable. By using a single cable for power, tally lights, and data transmission, you can reduce the overall cost of materials, as well as the cost of installation and maintenance.

The included teleprompter hood fully encloses the PTZ camera allowing it to move freely inside the hood. The teleprompter features a 65/35 reflective glass that makes the reflection easier to see for the presenter. The lightweight aluminum teleprompter has multiple 1/4-20" and 3/8-16" threads for mounting to a tripod or pedestal.



## What's Included

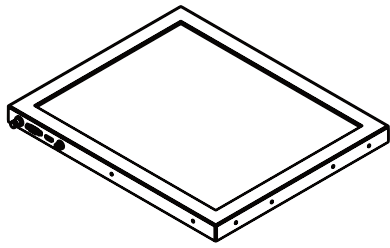

**NDI Monitor**

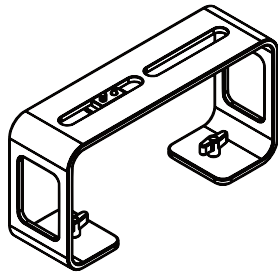

**Tall Riser**

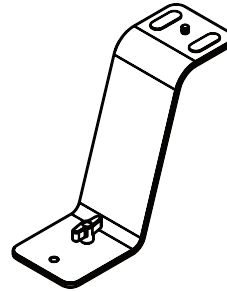

**DSLR/Mirrorless Riser**

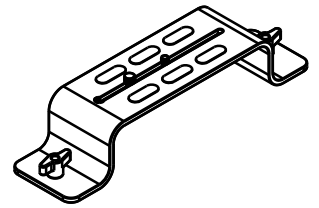

**Short Riser**

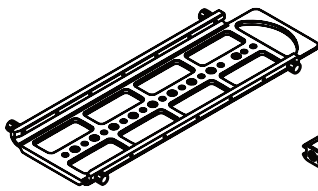

**Sled**

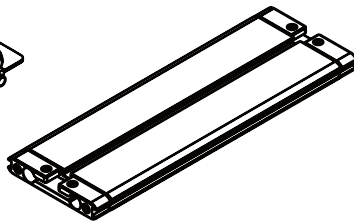

**Base**

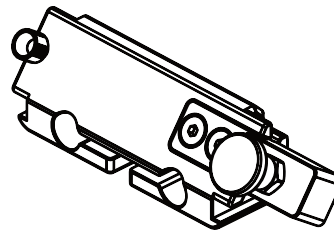

**Glass Frame Holder Bracket  
w/ Rod Clamps**

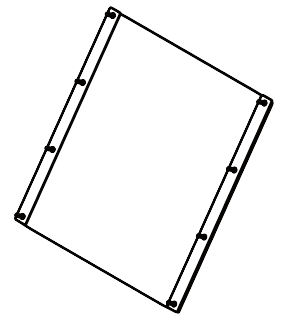

**Glass**

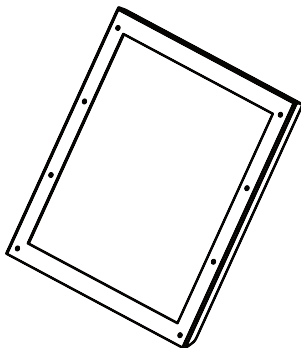

**Hood Attachment Frame**

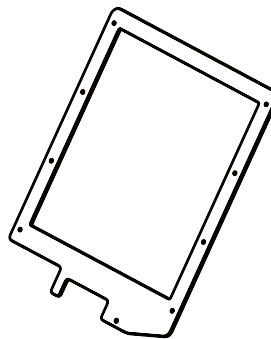

**Glass Holder**

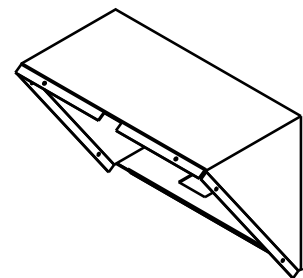

**Standard Hood**

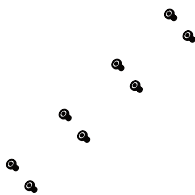

**Glass Frame Screws**

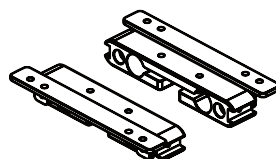

**15mm Rod Clamps**

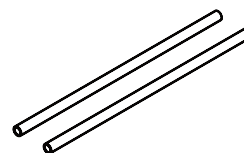

**15mm Rods**

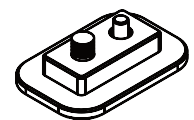

**Tall Camera  
Riser Mount**

## What's Included

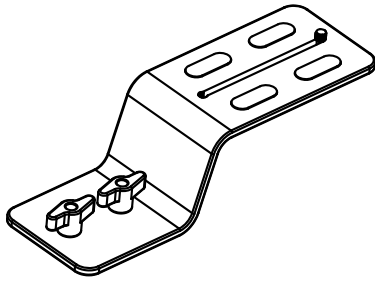

PTZ Camera Riser

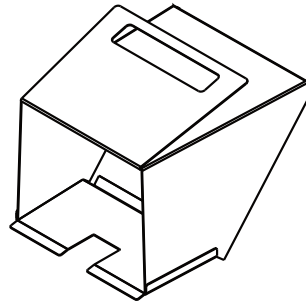

PTZ Hood

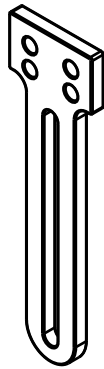

Height Adjustment  
Plate

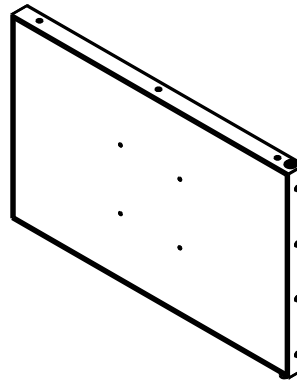

NDI Talent Monitor

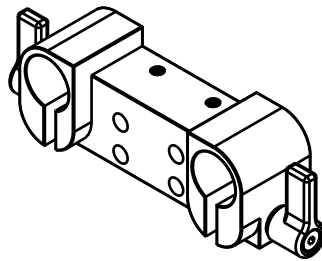

Rod Adapter

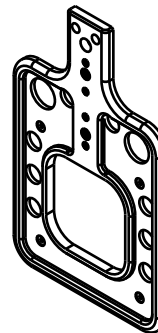

VESA Adapter



Thumb  
Screws



Screws

# Teleprompter Assembly Setup

## Step 1

Place the Hood Attachment Frame over the Glass Holder. Then place the glass against the Glass Holder. Make sure the screws pass through the holes on the both the Hood Attachment Frame and the Glass Holder.

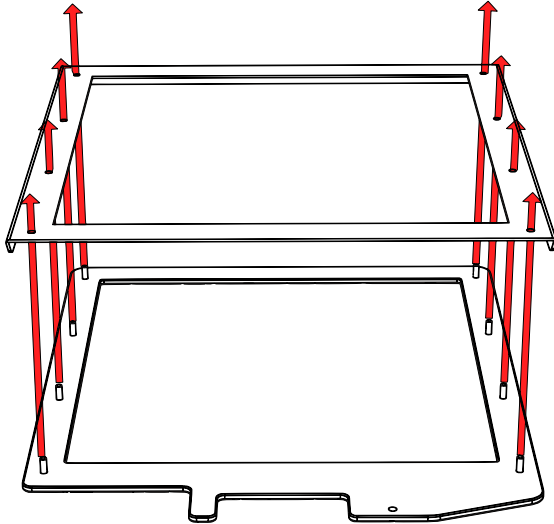

## Step 2

Secure the Glass Holder by fastening the knurled nuts to the screws as pictured below.

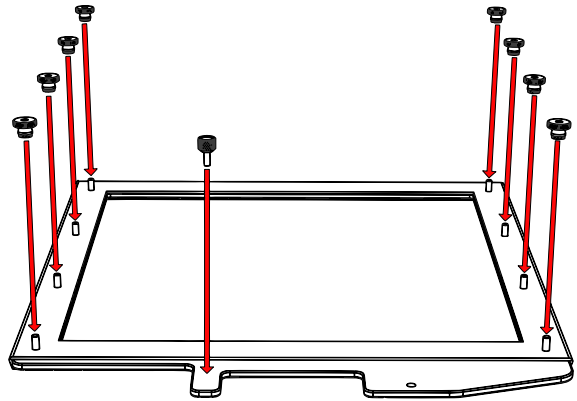

## Step 3

Remove the monitor mounts from the teleprompter base using the included larger 4mm hex key to loosen from the 15mm rods.

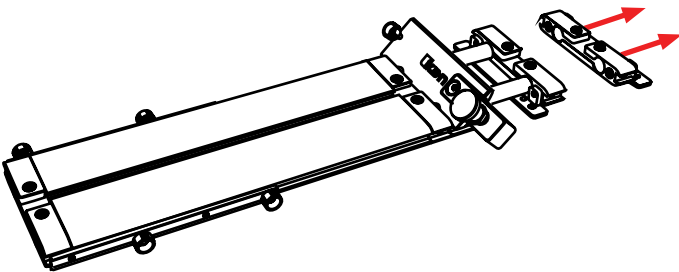

## Step 4

Put the washers on before tightening the screws. The washers and 4 additional screws are inside a bag on the bottom foam.

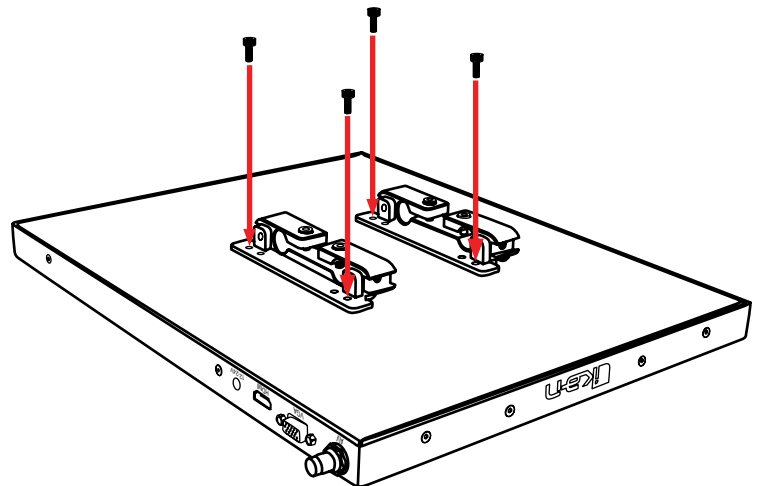

## Step 5

After the monitor mounts are attached, adjust the 15mm rods to accommodate the monitor. Leave about 1 inch of room for the teleprompter bracket. Make sure the 15mm rods go through both set of monitor mounts. Please ensure that all screws are properly tightened after inserting the monitor.

**\*SAFETY NOTE\*** Make sure to leave at least 2 inches of the rods inside the teleprompter base.

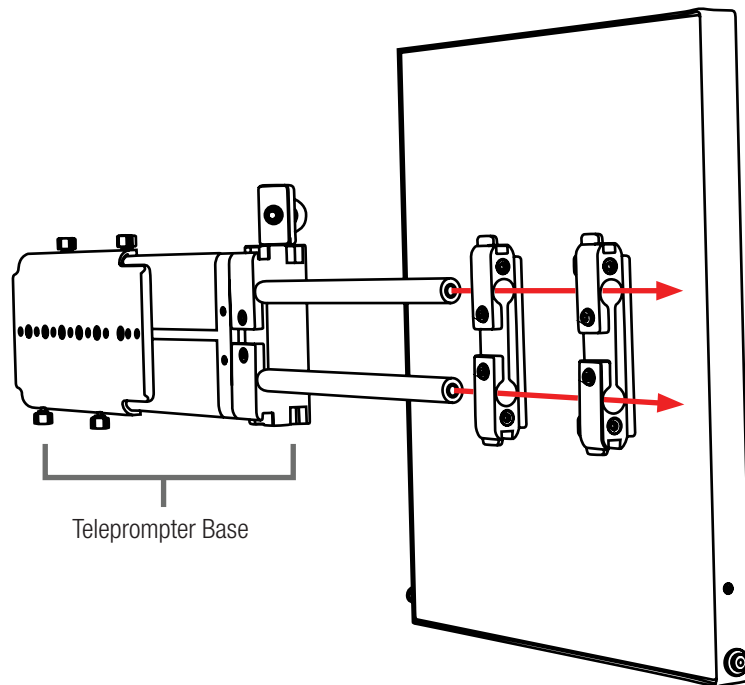

## Step 6

While sliding the teleprompter bracket into the slot of the Glass Frame Holder Bracket, pull on the red knob to allow the bracket to fully slide in.

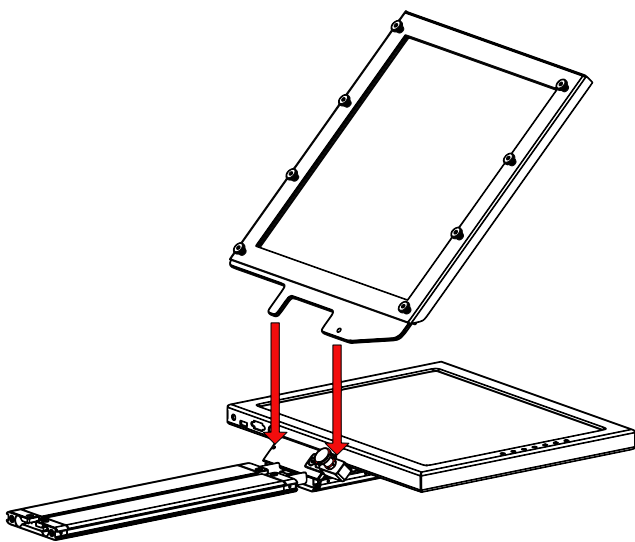

## Step 7

Once the bracket is in place, tighten the side screw to lock in place. Double check and make sure all the screws are tightened with the included hex keys.

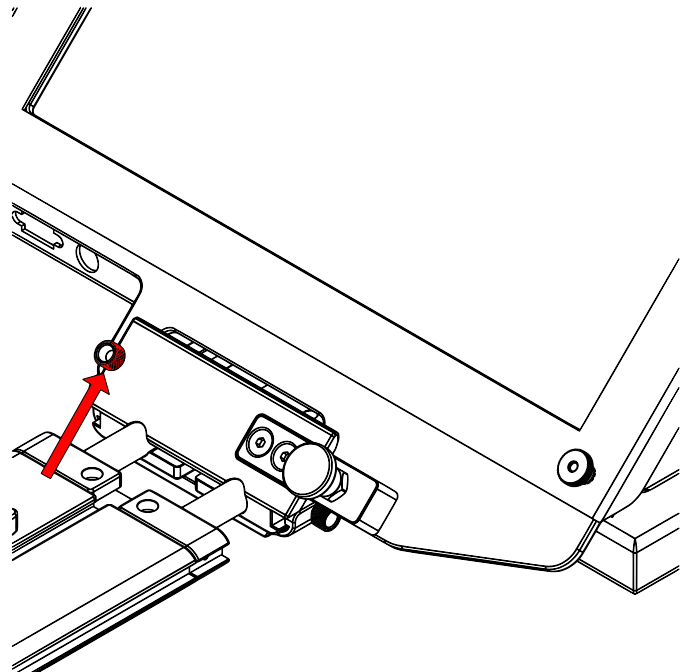

## Step 8

Fold the flaps of the Hood alongside the edges of the Hood Attachment Frame. The flaps of the Hood are magnetic so they will automatically attach. Connect the bottom part of the hood by attaching the magnetic flap to glass frame holder. Connect the Velcro straps to the sides of the hood.

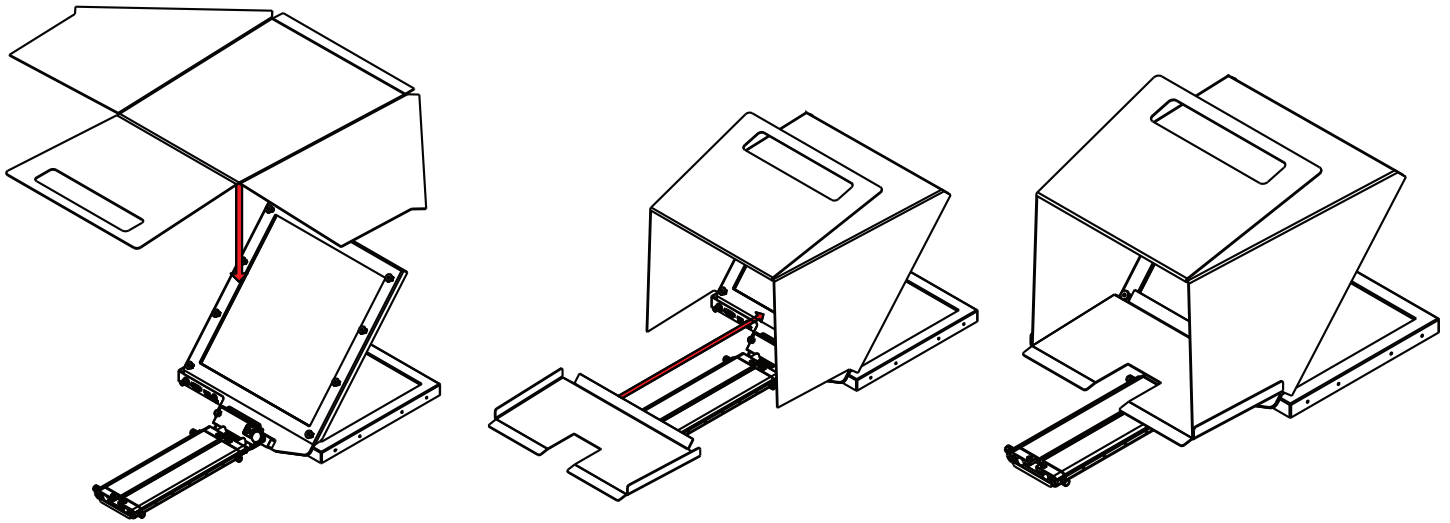

## Step 9: Connecting the PTZ Riser to PTZ Cameras

Connect the PTZ Camera Riser to the PTZ camera plate first, by aligning the screw threads of the camera to the 1/4-20 screw from the riser plate. Once the plate has been aligned, fasten the 1/4-20 screw on the PTZ Riser Plate to the thread on the bottom of the PTZ camera.

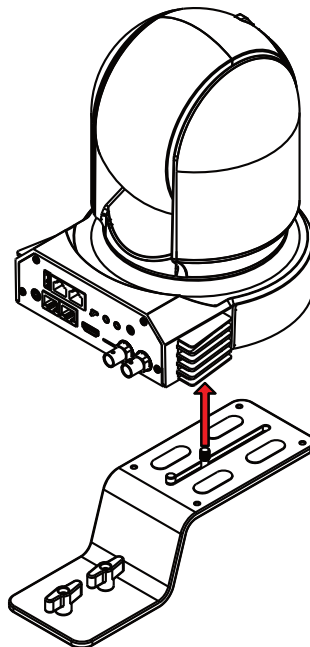

## Step 10

Locate the threaded clinch studs on the Hood Attachment Frame and fasten the included nuts to the clinch studs.

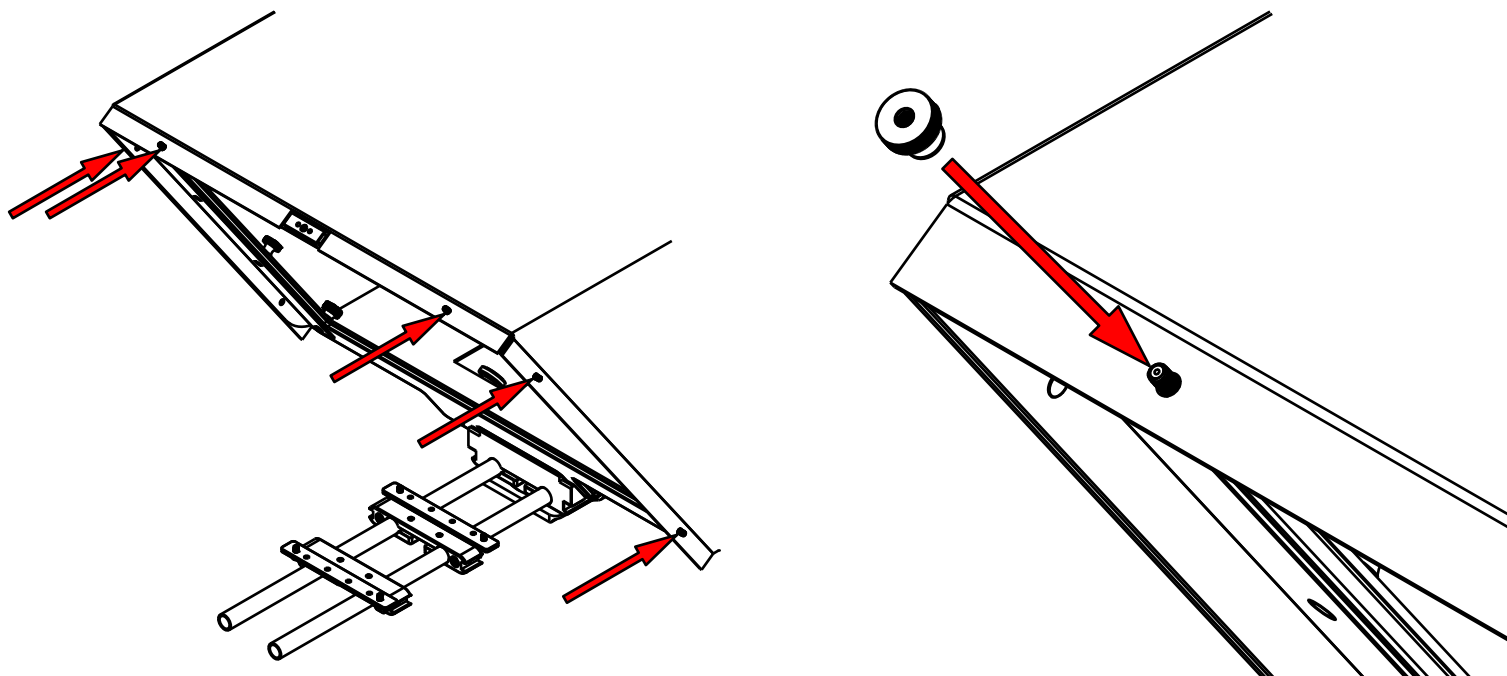

## Step 11

Fasten all six of the nuts to the threads on the hood frame to secure the hood to the teleprompter.

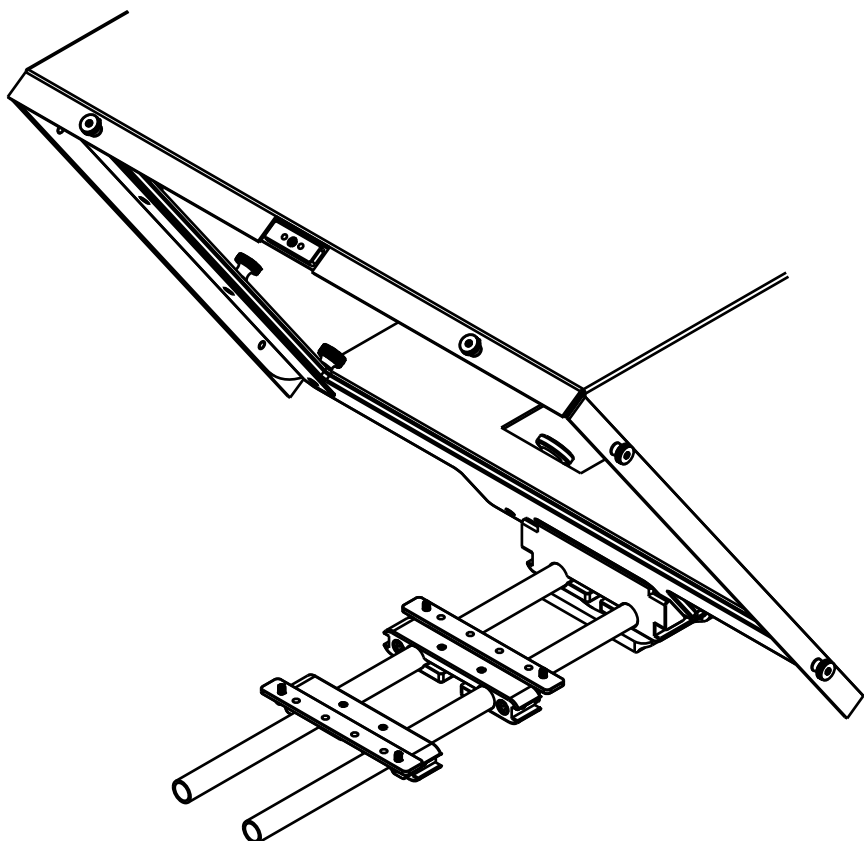

## Step 10

Set the PTZ camera inside the hood by aligning the screws on the riser plate to the slot on the Base. Once the screws are aligned, Slide the riser plate into the Base.

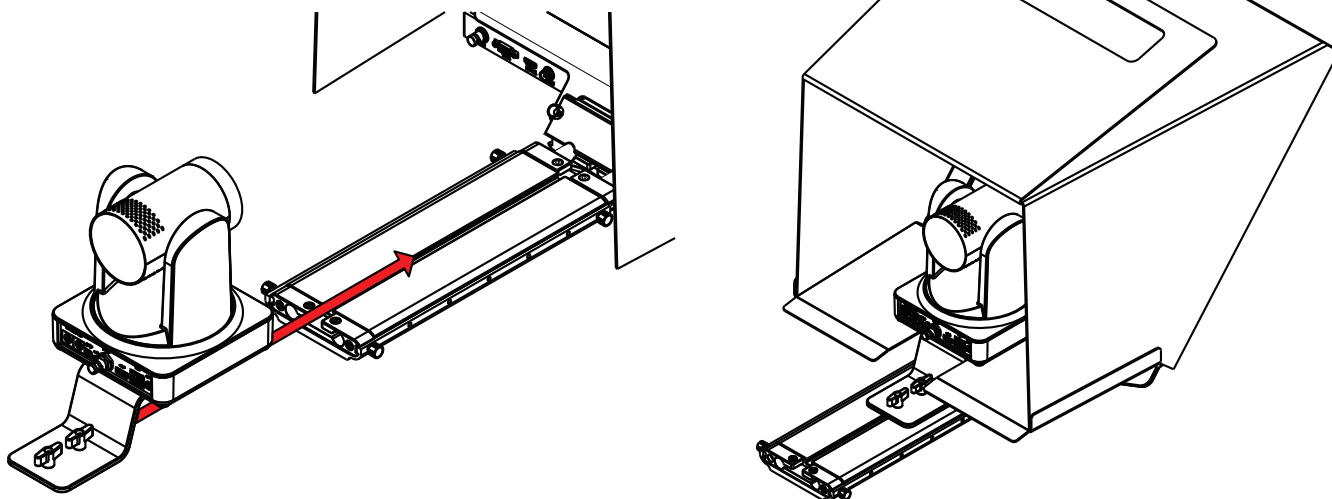

## Step 11

To prevent light from leaking through the hood, seal both zippers down, attach the Velcro straps along the back and sides of the hood. Connect the cables to the back of your PTZ camera by putting them through the slot on the back of the PTZ Hood. Once your cables are connected, tighten the draw string on the back of the PTZ Hood.

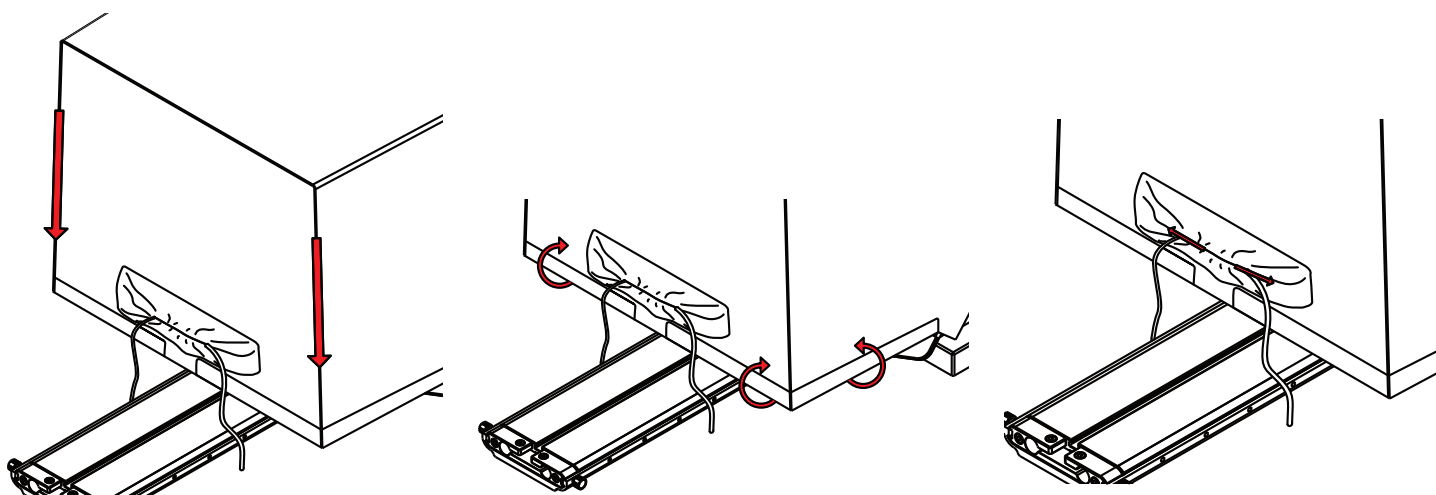

## Step 12

Mount your own tripod plate to the bottom plate by aligning the 1/4-20 and/or 3/8-16 screws and fastening them to the Bottom Plate. It is recommended that you connect your tripod plate to front of the Bottom Plate so that you can balance your teleprompter easier. Once your tripod plate is connected to the Bottom Plate, mount the tripod plate to your tripod head.

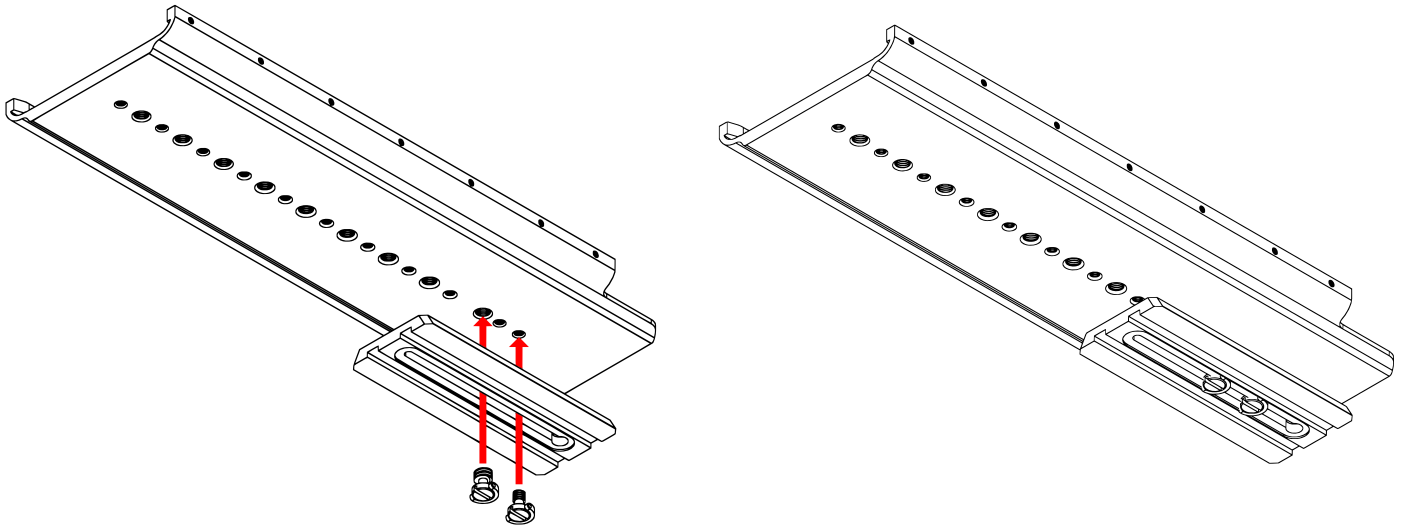

## Step 13

In order to properly balance the teleprompter, loosen the 4 screws on the bottom plate and slide the entire teleprompter system back or forward until the center of gravity has been determined. Once the center of gravity has been determined, tighten the thumb screws to keep the base from sliding.

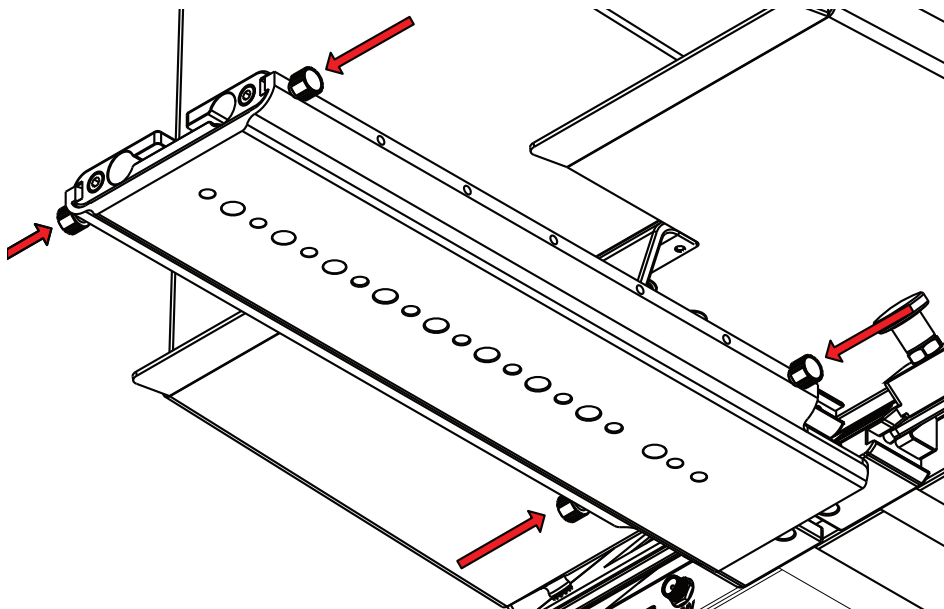

## Step 14

To secure your teleprompter system, insert the included headless screws into the threads behind and in front of the Base.

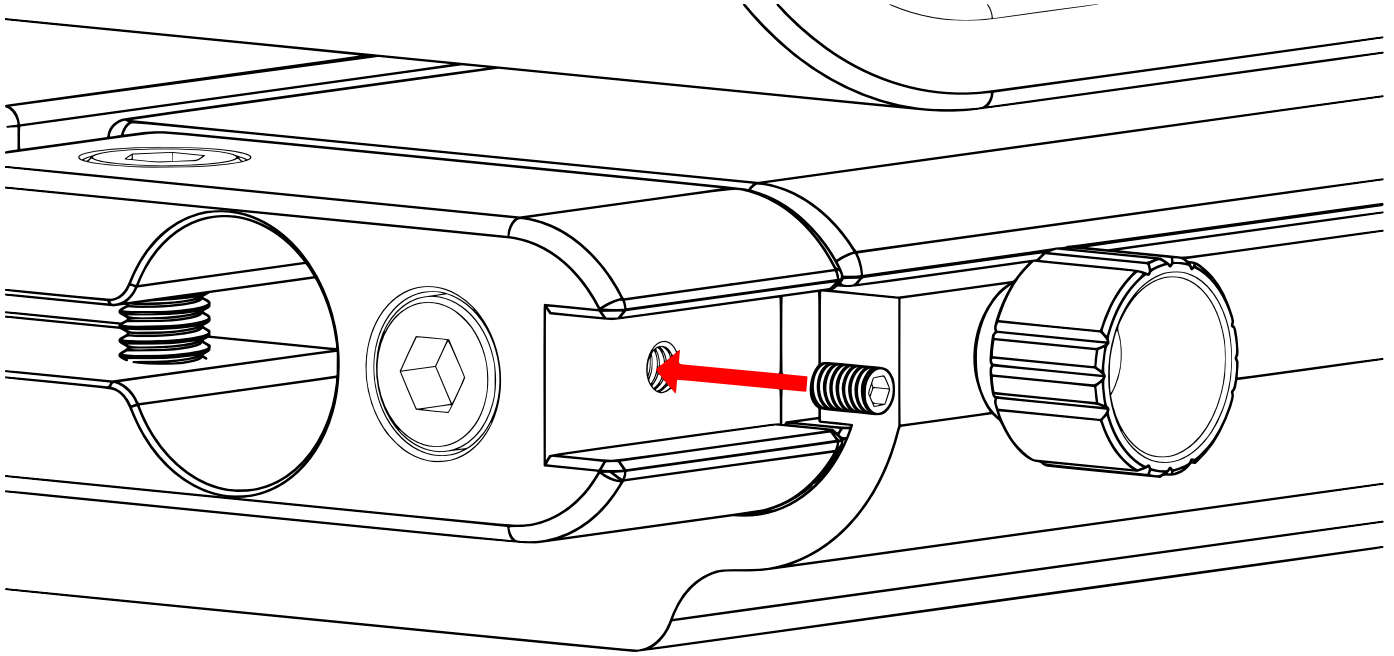

## Step 15

The headless screws should be inserted to the threads as pictured below.

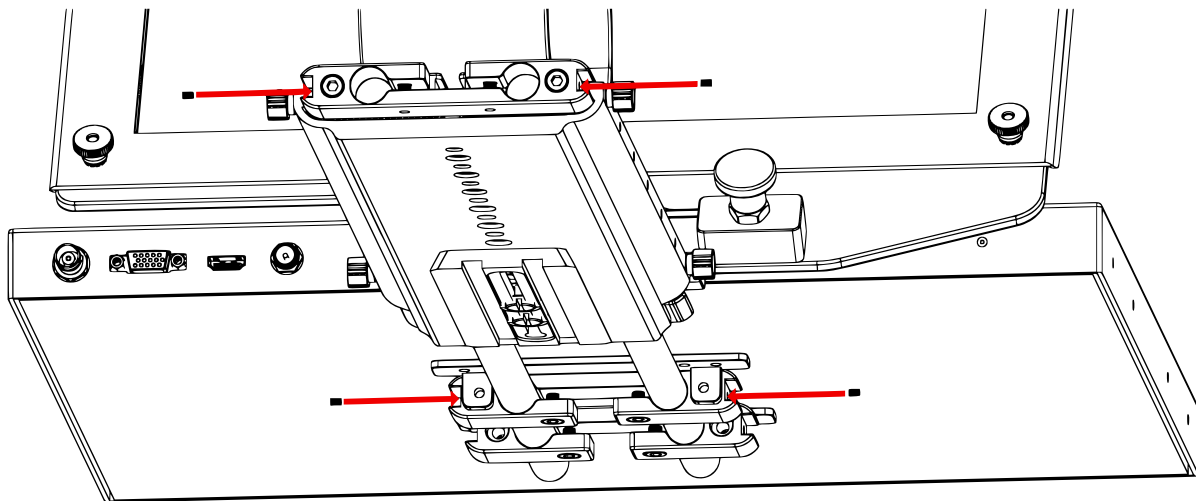

## Step 12

Align the holes of the monitor to the VESA Adapter.

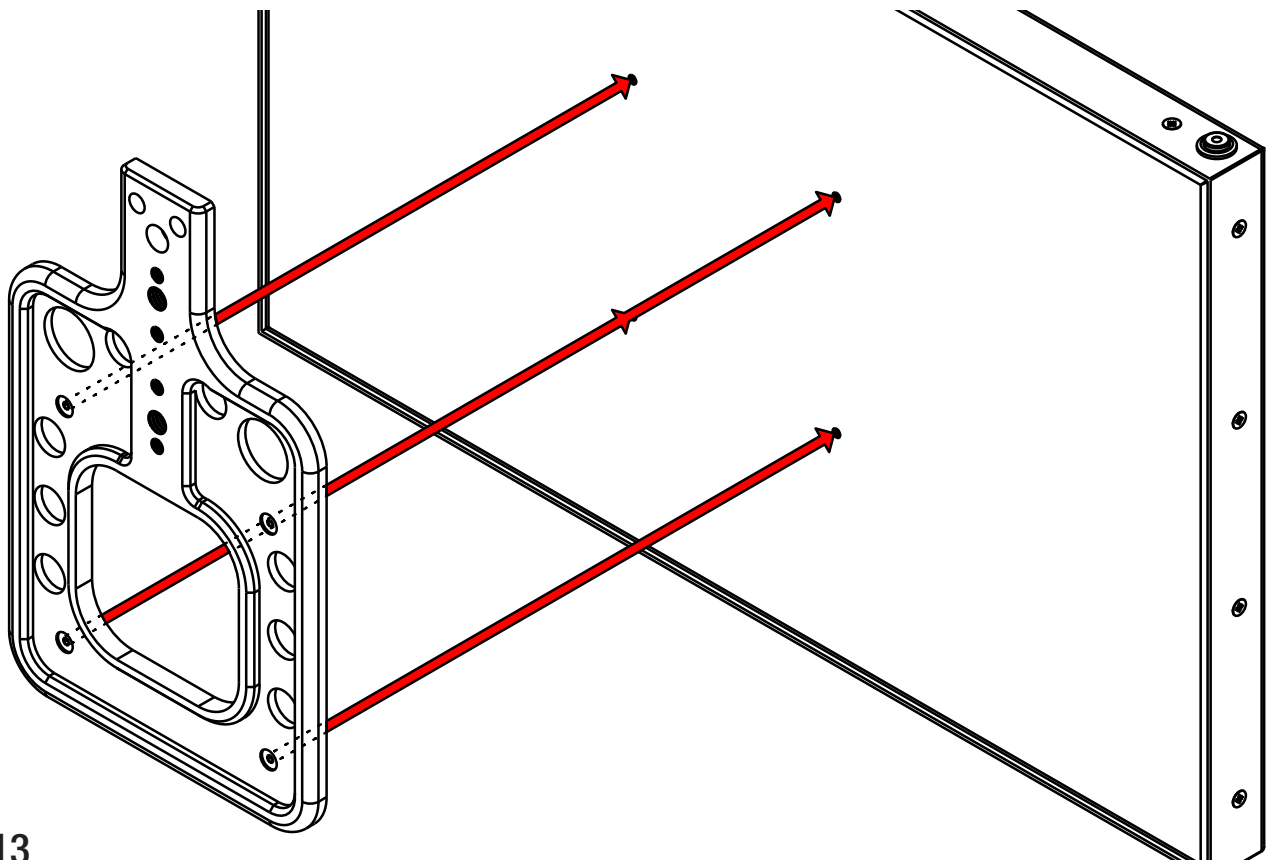

## Step 13

Attach the VESA adapter to the monitor by fastening the screws to the monitor

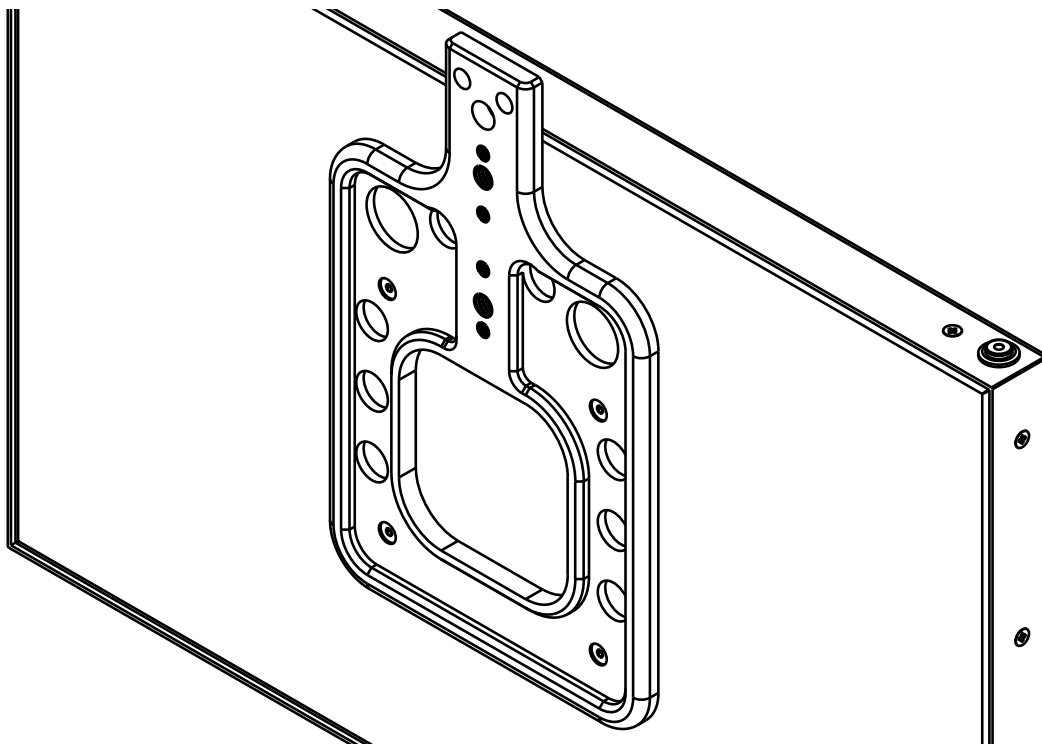

## Step 12

Place the Height Adjustment Plate in the Rod Adapter and align the holes.

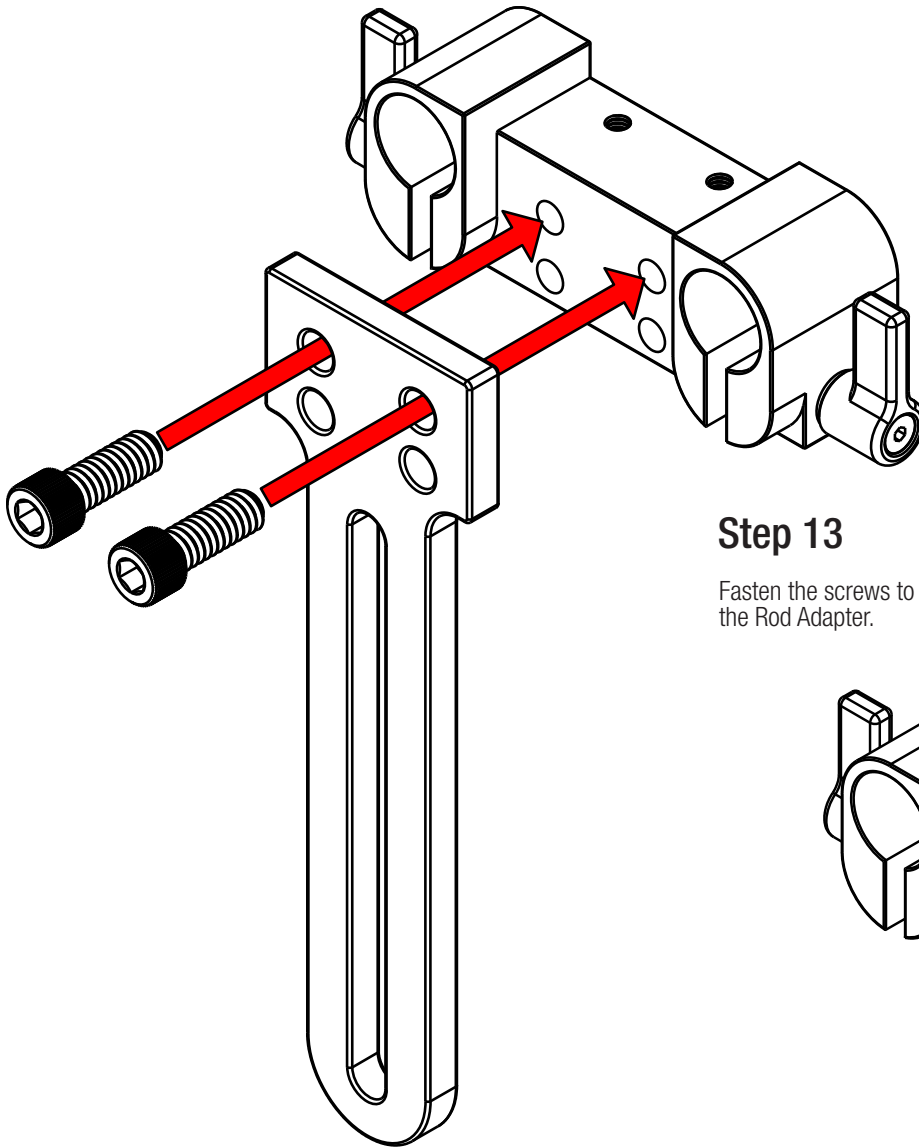

## Step 13

Fasten the screws to attach the Height Adjustment Plate and the Rod Adapter.

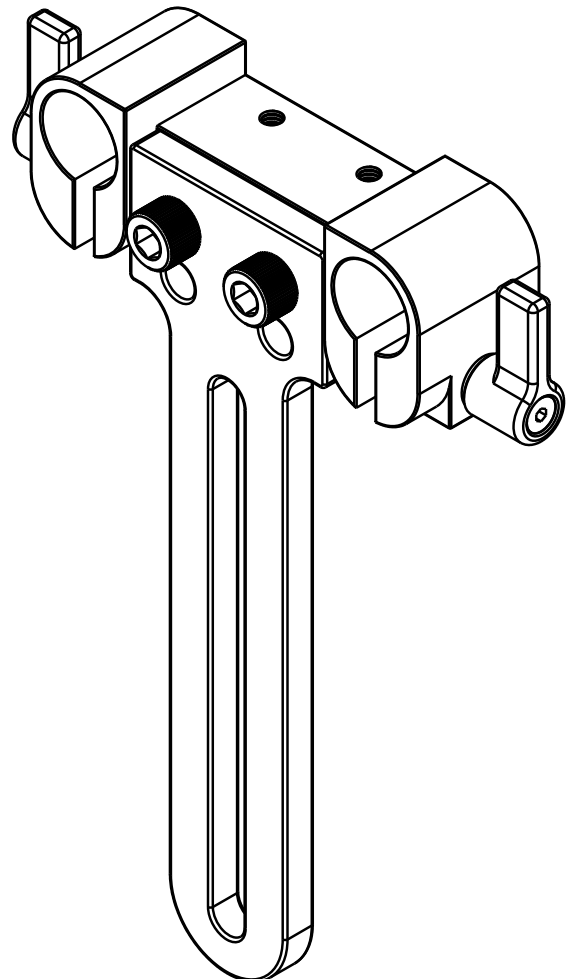

## Step 12

Align the threads of the 1/4-20 thumb screw to the threads on the VESA Adapter.

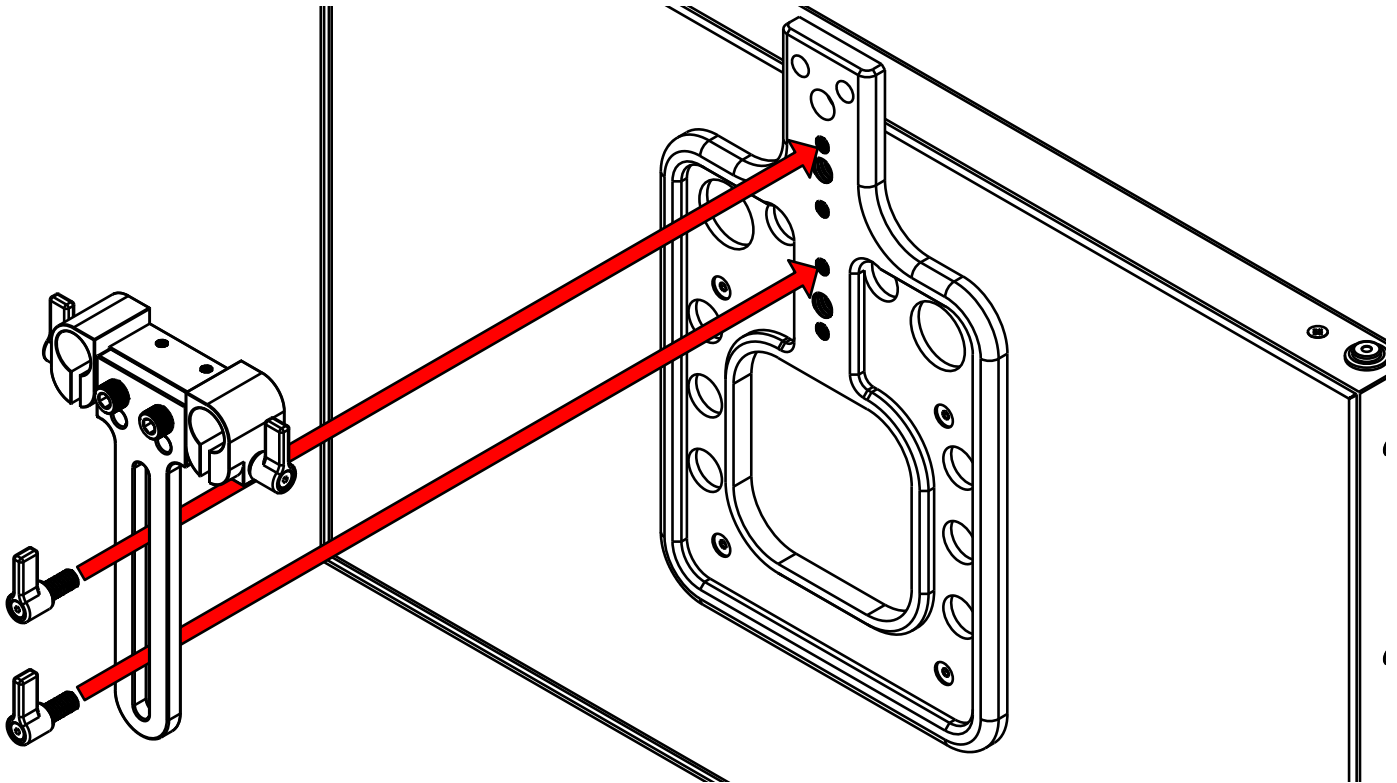

## Step 13

Fasten the screws to secure the Talent Monitor to the Rod Adapter.

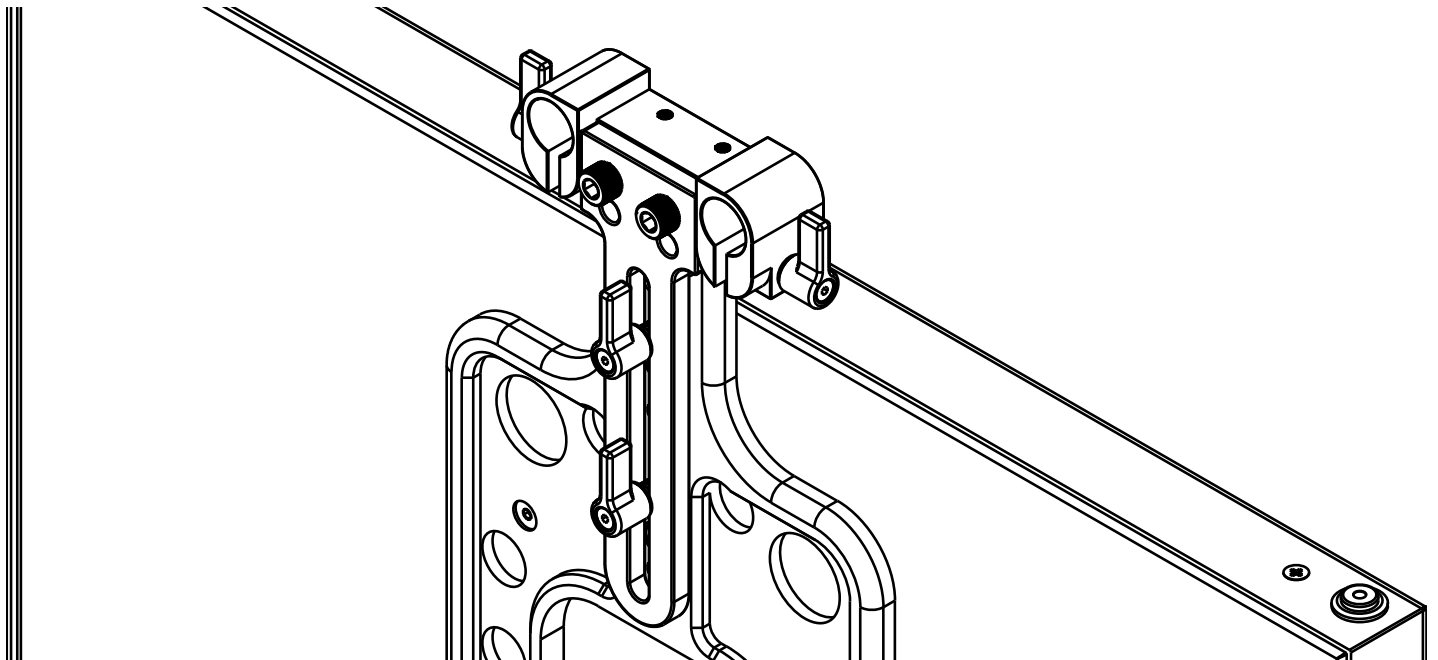

## Step 12

Attach the Talent Monitor Mount to the Teleprompter system by inserting the Rod Adapter to the 15mm.

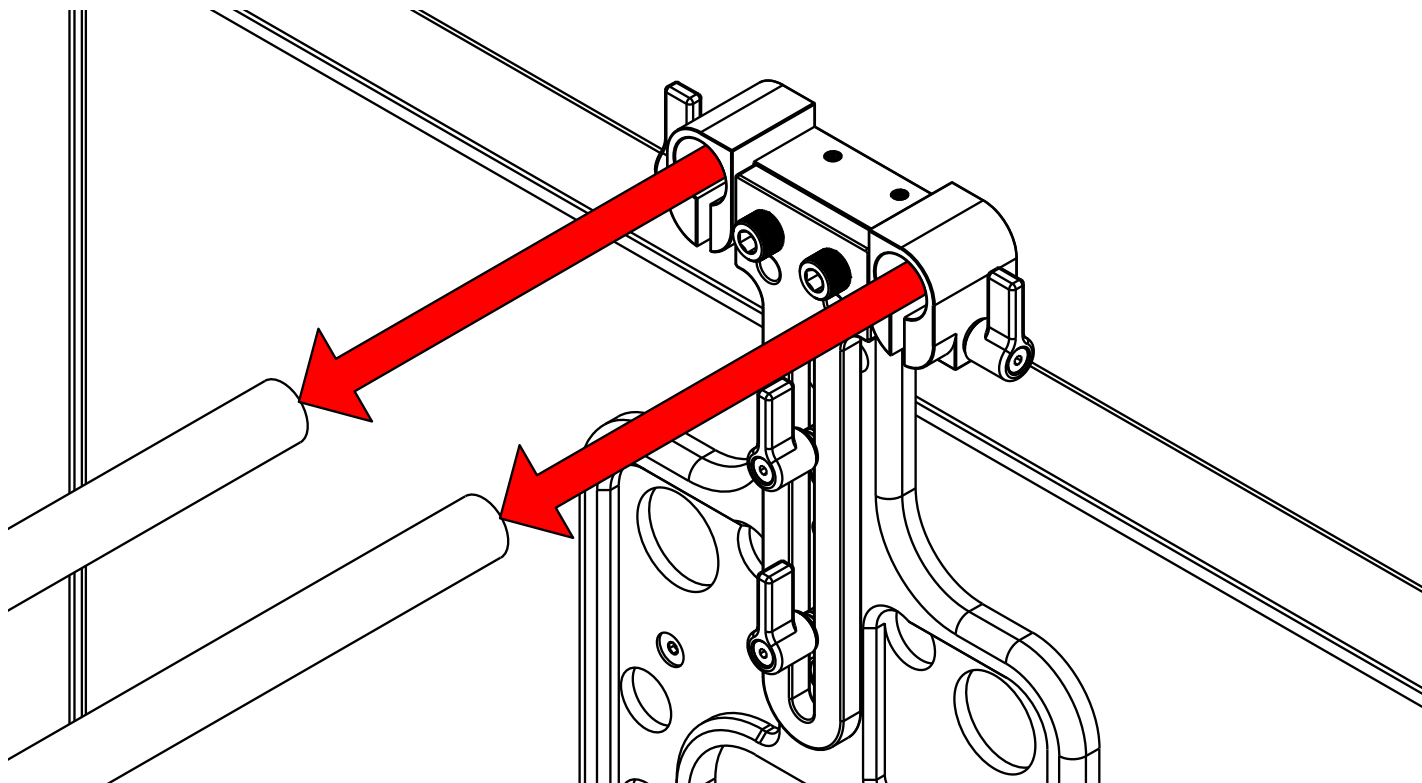

## Step 13

Once the Talent Monitor Mount has been inserted to the 15mm rods, secure the Talent Monitor by fastening the thumb screws.

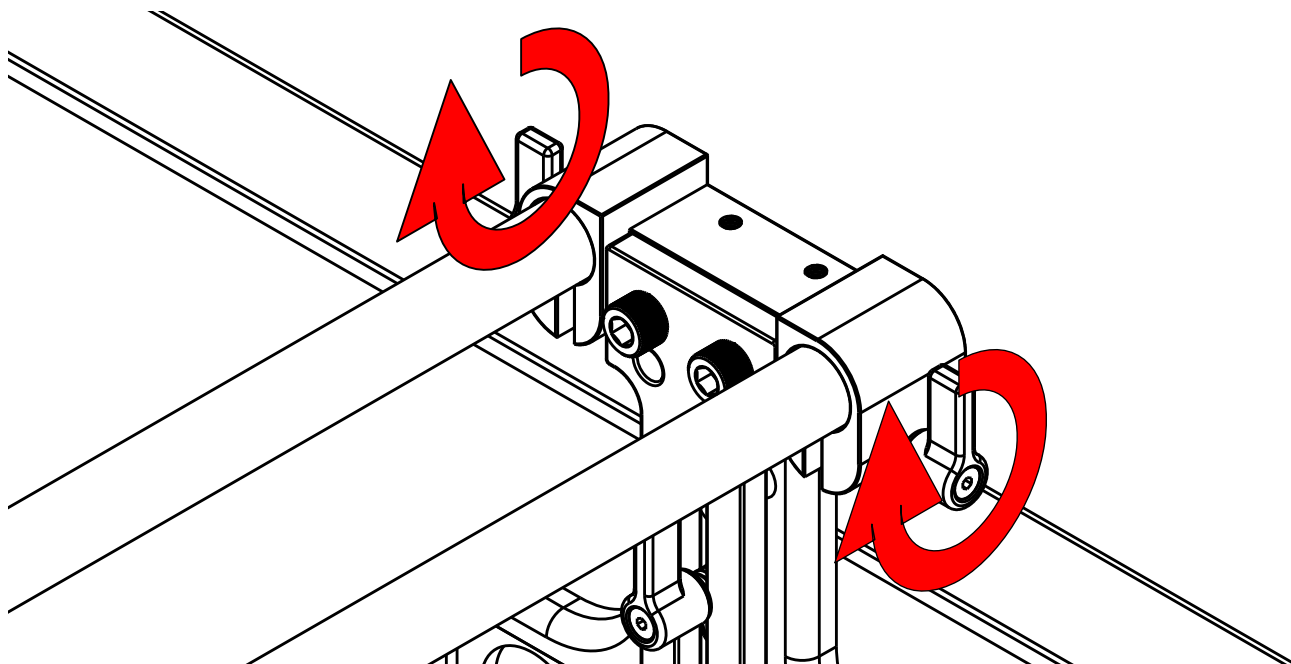

## Foam Case

To make your teleprompter more portable, we packed it in a reusable, high-quality custom-cut foam. The shape and size of the foam was designed to fit into Ikan's PT-CASE-4U.



**\*\* DO NOT THROW AWAY FOAM CASE \*\***

## Learn More

More dynamic information at official website: [www.ikancorp.com](http://www.ikancorp.com)

## Support

Contact email: [support@ikancorp.com](mailto:support@ikancorp.com)

---

### CONDITIONS OF WARRANTY SERVICE

- Free service for one year from the day of purchase if the problem is caused by manufacturing errors.
- The components and maintenance service fee will be charged if the warranty period is expired.

**Free Service will not be Provided in the Following Situations:(\*Even if the product is still within the warranty period.)**

- Damage caused by abuse or misuse, dismantling, or changes to the product not made by the company.
- Damage caused by natural disaster, abnormal voltage, and environmental factors, etc.

©2025 Ikan International. All rights reserved.

