

M19W-NDI-TALENT



19" POE++ Talent Monitor w/ Full NDI Encoding/Decoding & IP Tally Light



OVERVIEW

Our NDI Talent Monitor features Full NDI (Network Device Interface) encoding/decoding, as well as traditional 3D-SDI, HDMI, Composite and VGA, inputs. NDI is a video-over-IP protocol that allows for high-quality, low-latency video transmission over standard Ethernet networks. Our NDI teleprompter can be connected to a network using standard Ethernet cables, eliminating the need for dedicated video cables or specialized hardware. In addition, the teleprompter utilizes PoE++ technology that allows both power and NDI data to be transmitted through a single Ethernet cable. By using a single cable for power, tally lights, and data transmission, you can reduce the overall cost of materials, as well as the cost of installation and maintenance.



What's Included

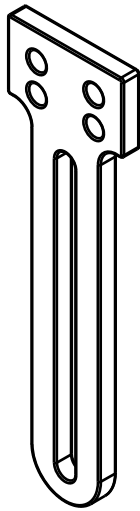

**Height Adjustment
Plate**

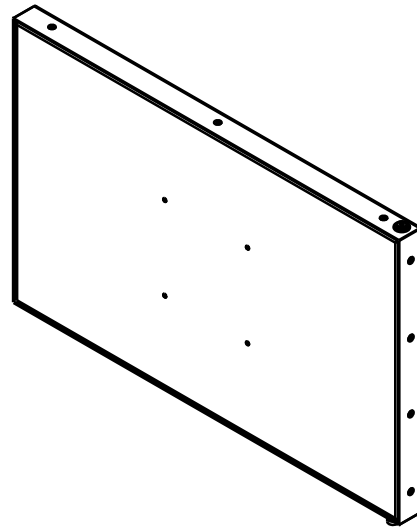

Widescreen NDI Talent Monitor

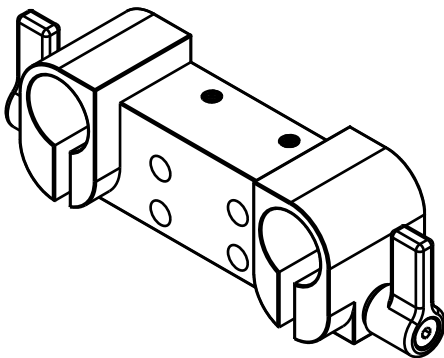

Rod Adapter

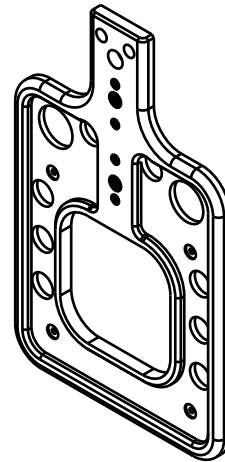

VESA Adapter



**Thumb
Screws**

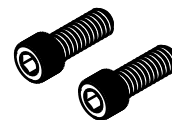

Screws

Step 1

Align the holes of the monitor to the VESA Adapter.

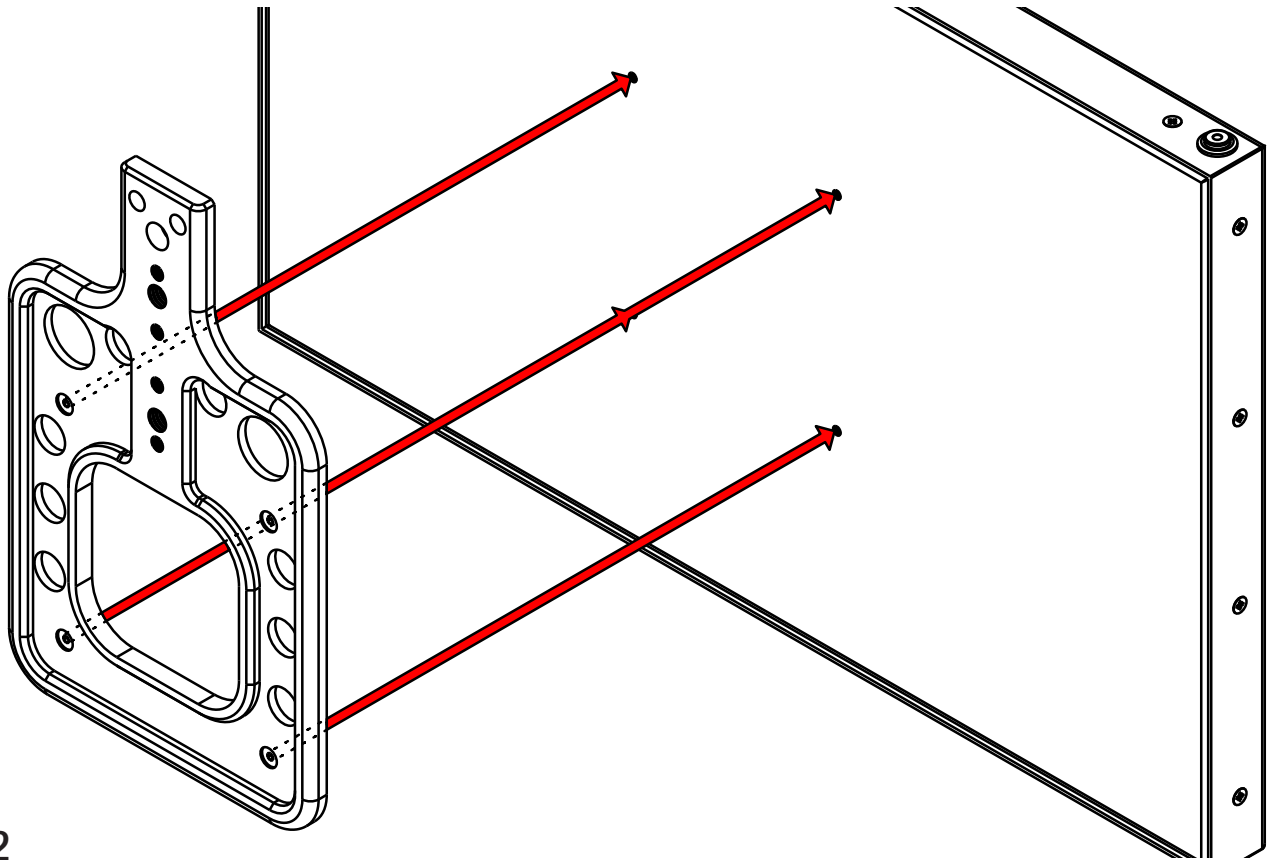

Step 2

Attach the VESA adapter to the monitor by fastening the screws to the monitor

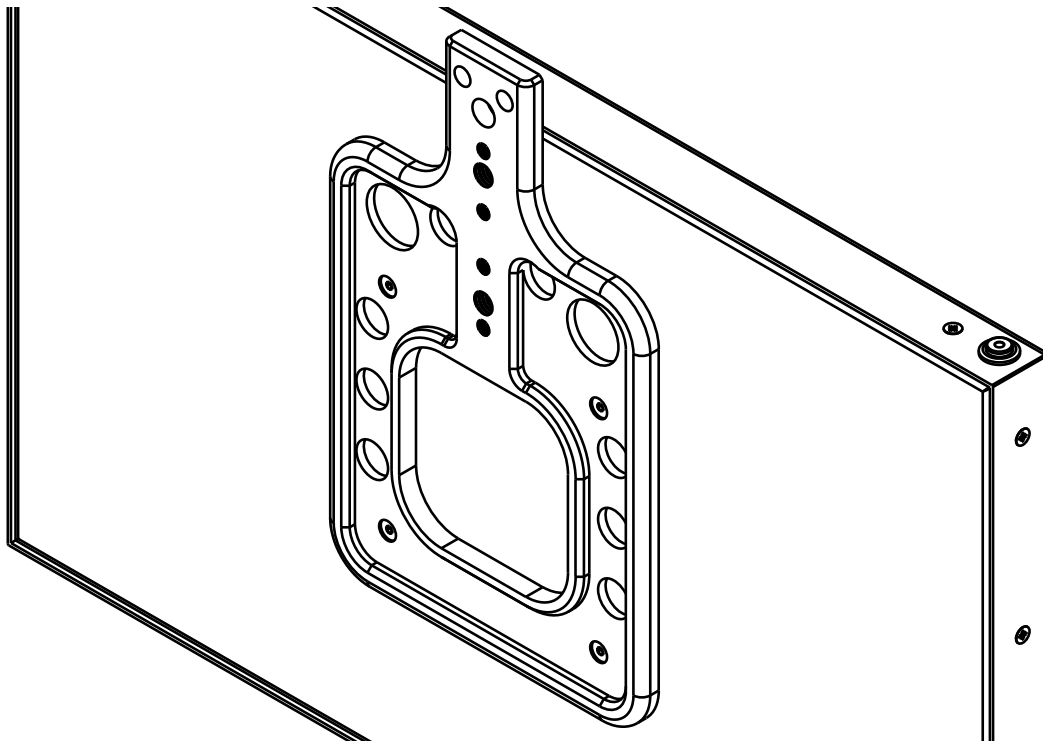

Step 3

Place the Height Adjustment Plate in the Rod Adapter and align the holes.

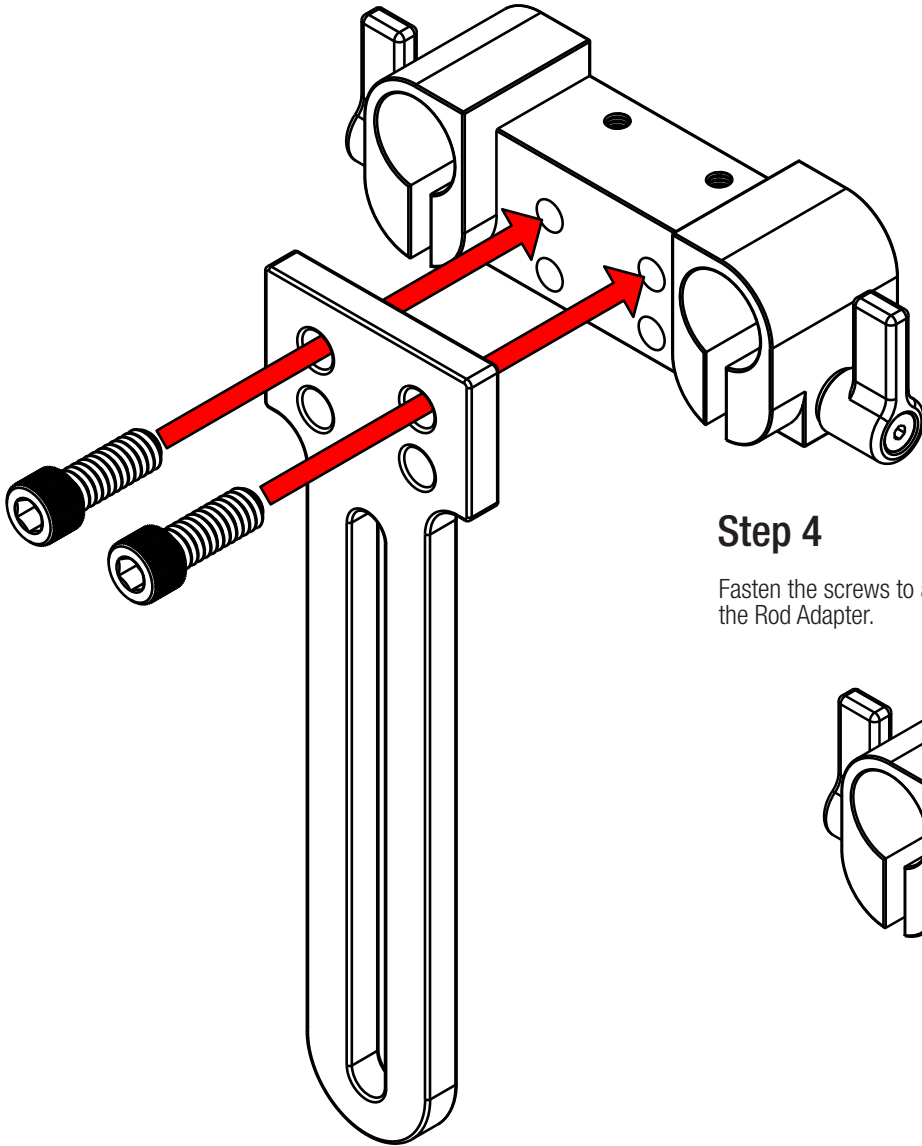

Step 4

Fasten the screws to attach the Height Adjustment Plate and the Rod Adapter.

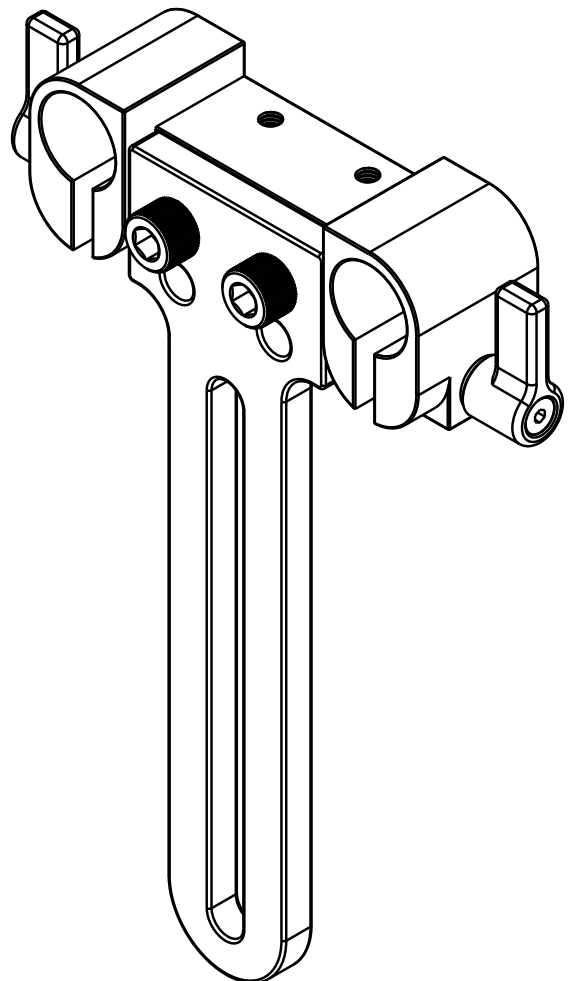

Step 5

Align the threads of the 1/4-20 thumb screw to the threads on the VESA Adapter.

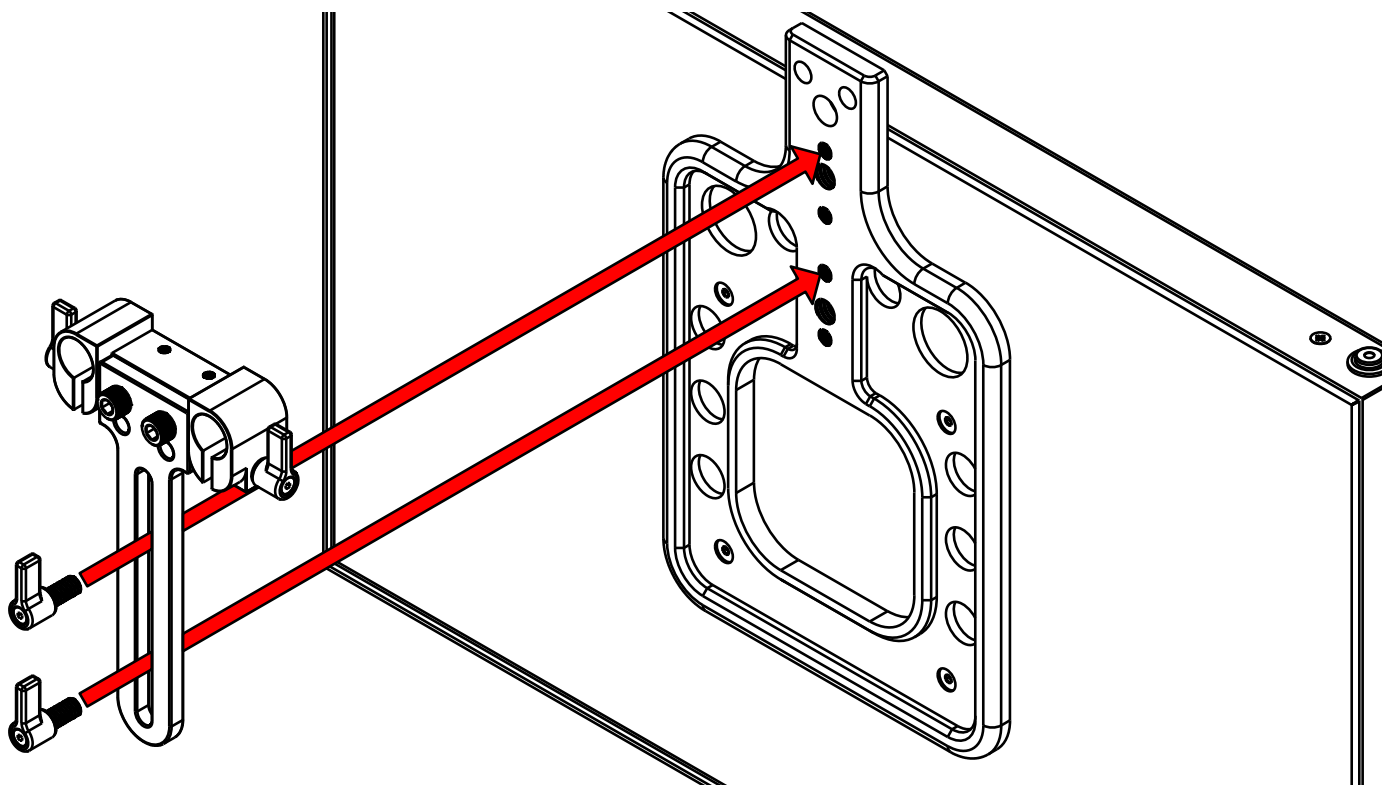

Step 6

Fasten the screws to secure the Talent Monitor to the Rod Adapter.

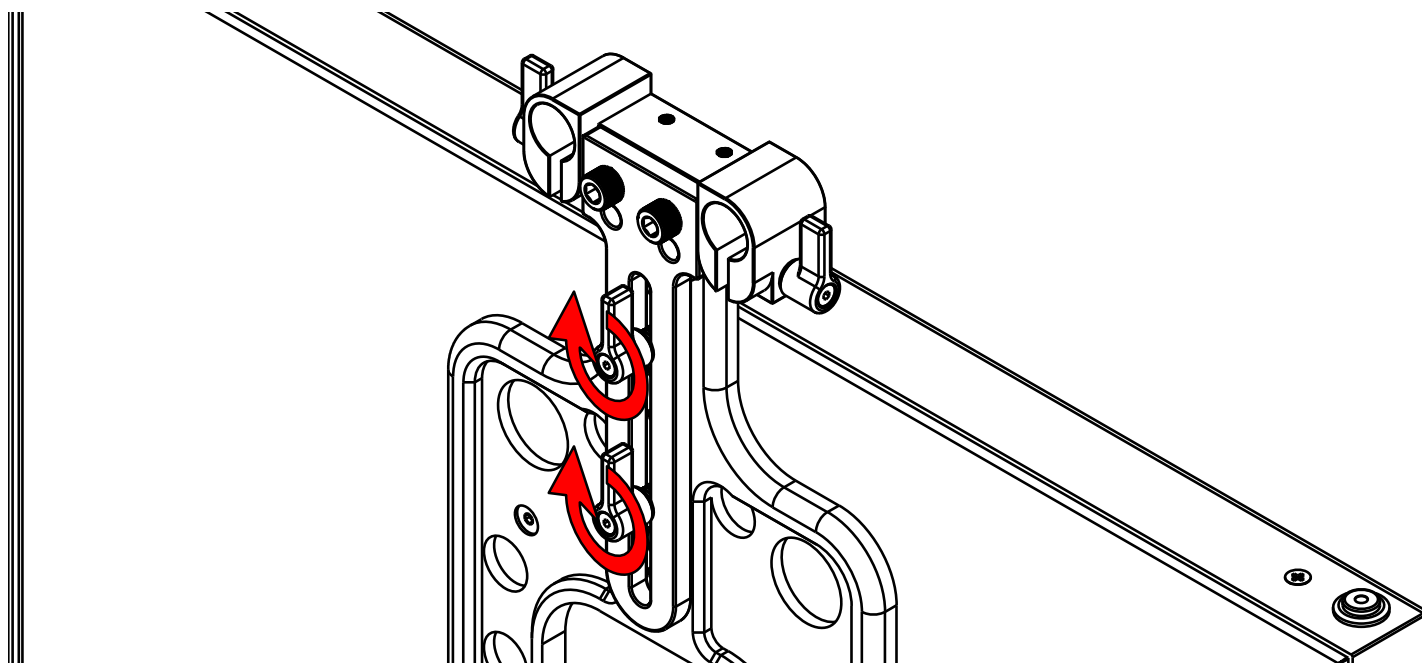

Step 7

Attach the Talent Monitor Mount to the Teleprompter system by inserting the Rod Adapter to the 15mm rods.

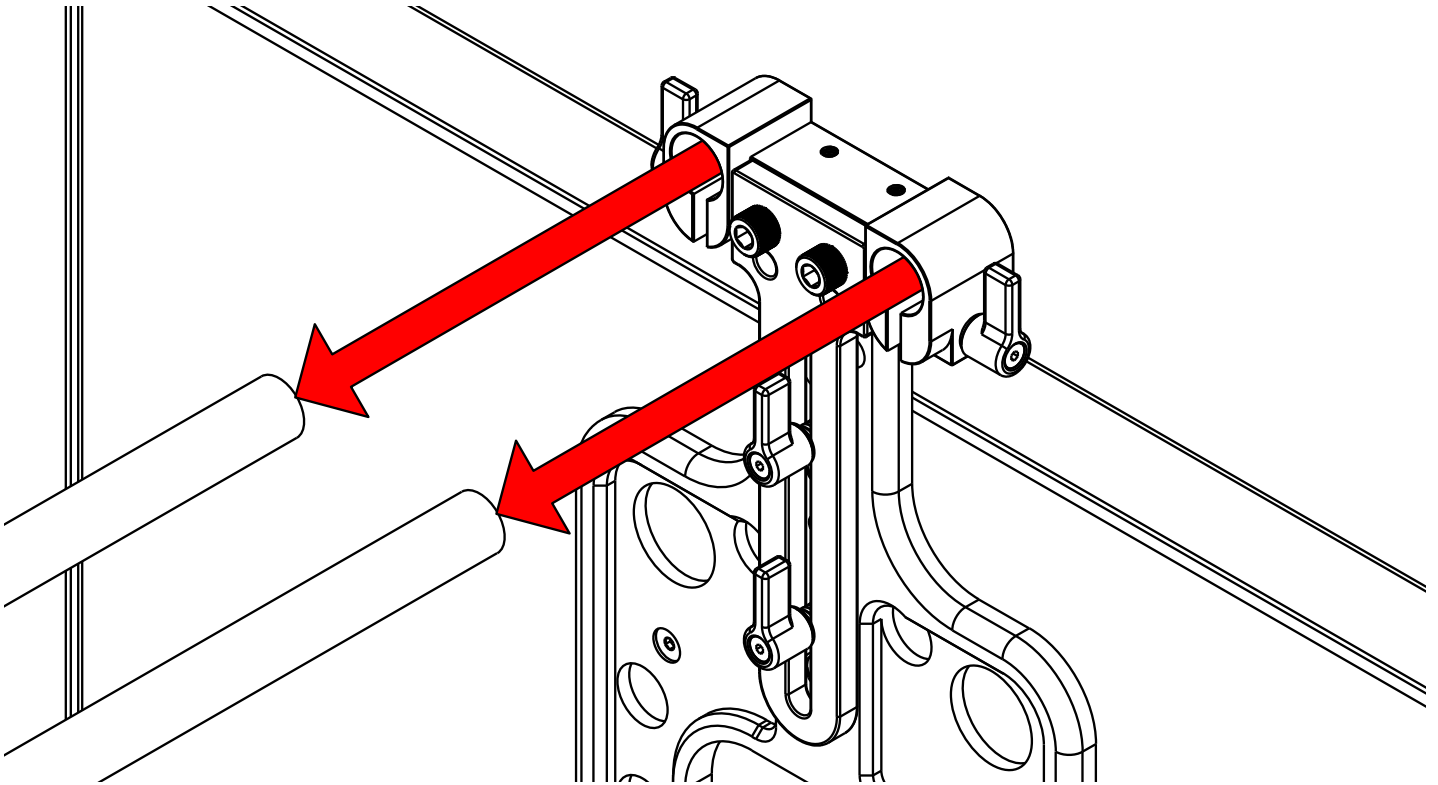

Step 8

Once the Talent Monitor Mount has been inserted to the 15mm rods, secure the Talent Monitor by fastening the thumb screws.

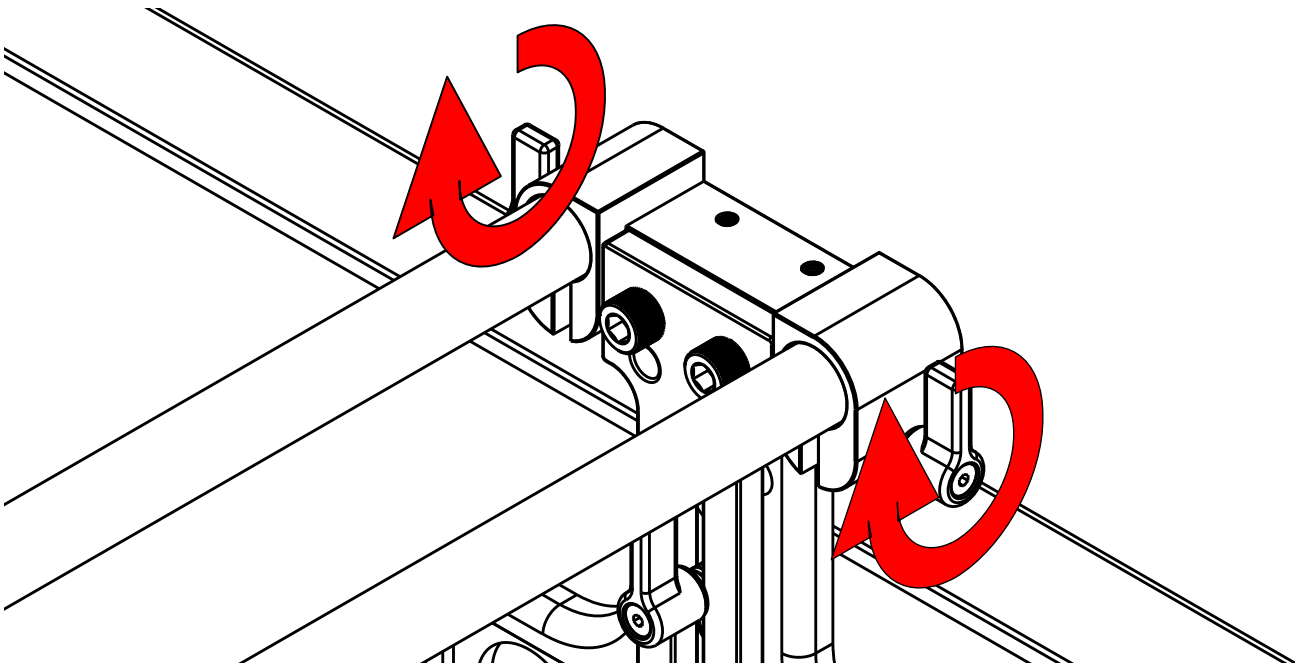

Watch our VIDEO TUTORIAL on how to assemble NDI Teleprompters:

<https://ikancorp.com/ndi-monitor-videos/>



Optional Accessories for Teleprompter

PT4U-G	Replacement Glass for PT419W-NDI-TM
PT-PEDAL	Teleprompter Foot Control Pedal
PT-CONTROLLER	Teleprompter Rotary Controller
PT-CASE-4U	Rolling Hard Case for PT419W-NDI-TM Teleprompter