

PT4900-PTZ



Profesional 19" High-Bright PTZ-Compatible Teleprompter



OVERVIEW

The 19" PTZ Teleprompter from Ikan is a professional solution for teleprompting with PTZ cameras. The package provides an extra-wide hood assembly to allow considerable movement of the camera within the wide beam splitter glass. The PTZ Teleprompter features a 19" 1000 cd/m² monitor, 70/30 20"-wide beamsplitter glass, and a 25' reading range. The teleprompter is designed for use with a wide range of PTZ cameras, as the wide beamsplitter provides for a wide amount of left-right panning. The teleprompter includes a base system that can be easily shifted forward and backwards, which enables mounting the camera to the prompter without requiring counterweights.

Please note that the PT4900-PTZ includes parts to build two types of teleprompter systems, a standard 19" Teleprompter that is compatible with various types of mirrorless and broadcast cameras, and a 19" PTZ teleprompter that is compatible with a wide range of PTZ cameras. This Quick Start Guide will show you how to set up the 19" Teleprompter for PTZ cameras. For instructions on how to set up the PT4900 for broadcast or mirrorless cameras, please refer to the PT4900 Quick Start Guide on our website.



What's Included

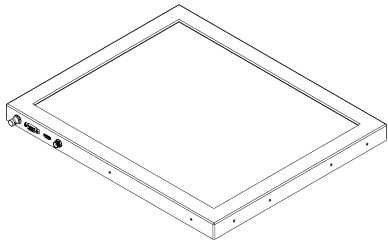

Monitor

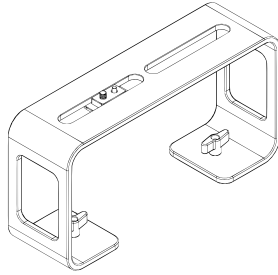

Large Riser

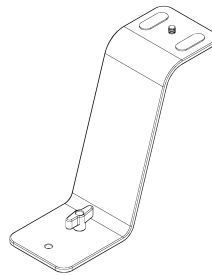

DSLR/Mirrorless Riser

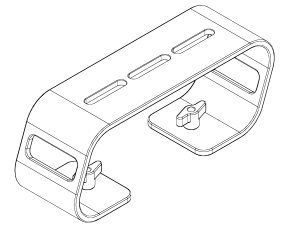

Medium Riser

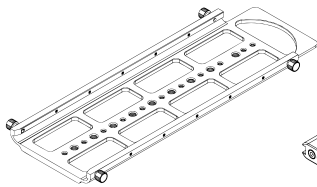

Bottom Plate

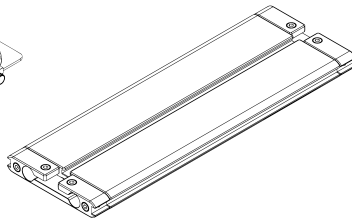

Base

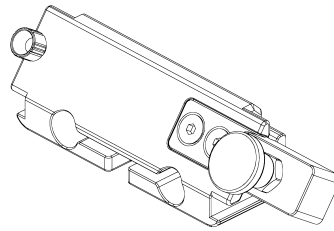

**Glass Frame Holder Bracket
w/ Rod Clamps**

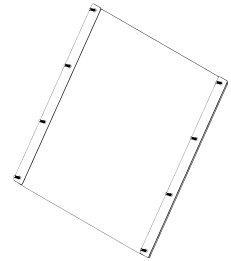

Glass

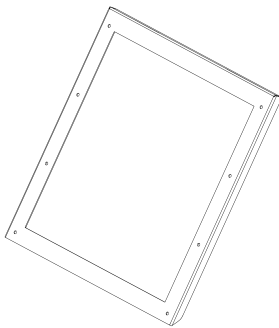

Hood Attachment Frame

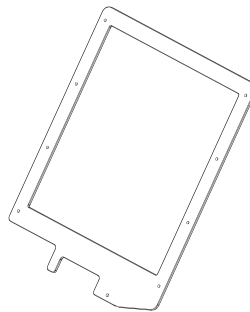

Glass Holder

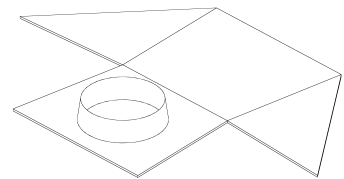

Hood



Glass Frame Screws

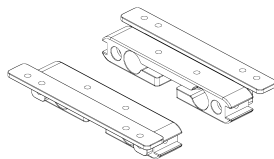

15mm Rod Clamps

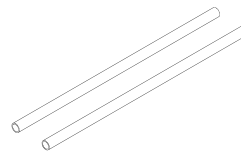

15mm Rods

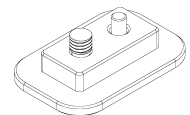

**Large Riser
Bracket**

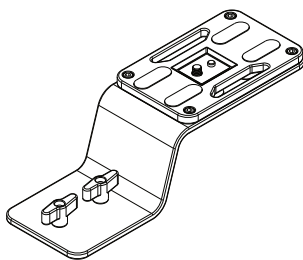

PTZ Camera Riser

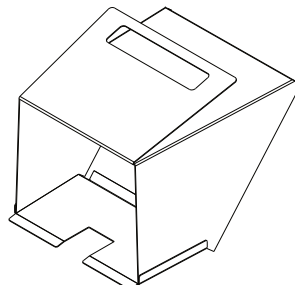

PTZ Hood

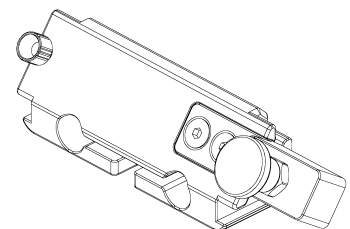

**Glass Frame Holder Bracket
w/ Rod Clamps for PTZ Cameras**

Teleprompter Assmebly Setup

Step 1

Place the Hood Attachment Frame over the Glass Holder. Then place the glass against the Glass Holder. Make sure the screws pass through the holes on the both the Hood Attachment Frame and the Glass Holder.

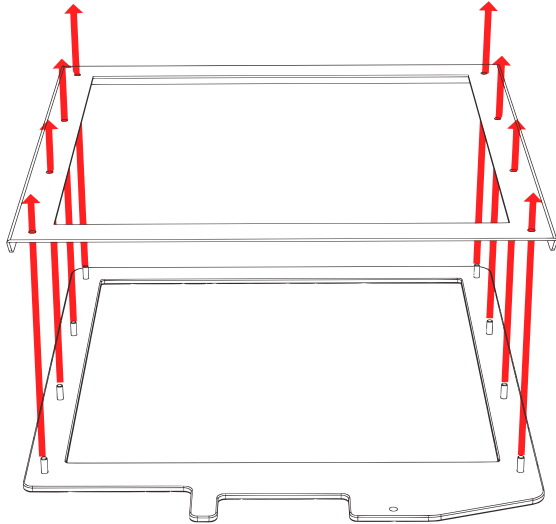

Step 2

Secure the Glass Holder by fastening the knurled nuts to the screws as pictured below.

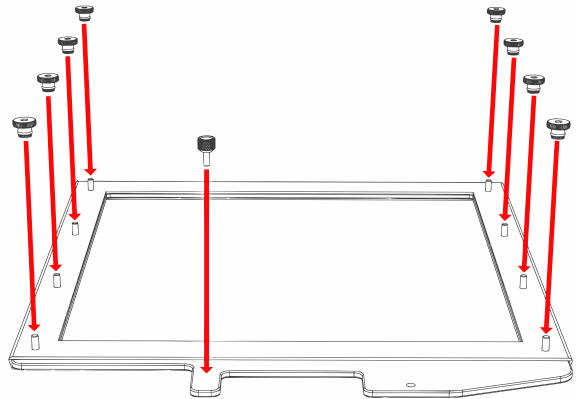

Step 3

Remove the monitor mounts from the teleprompter base using the included larger 4mm hex key to loosen from the 15mm rods.

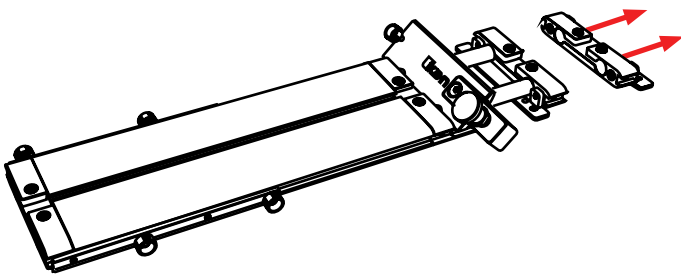

Step 4

Put the washers on before tightening the screws. The washers and 4 additional screws are inside a bag on the bottom foam.

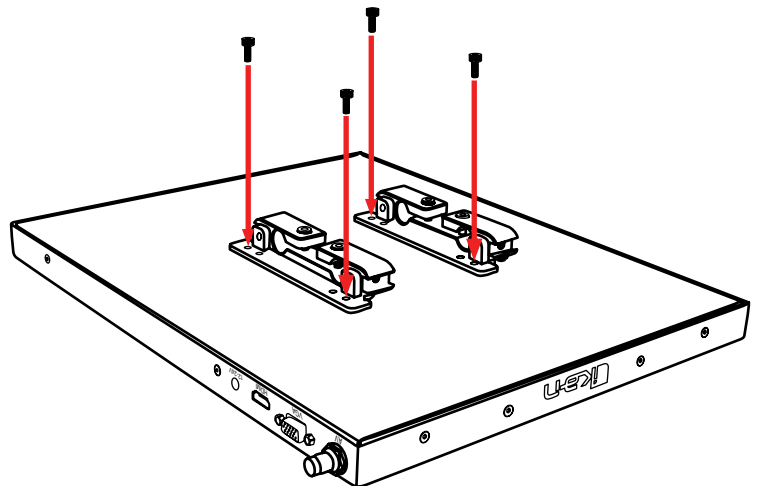

Step 5

After the monitor mounts are attached, adjust the 15mm rods to accommodate the monitor. Leave about 1 inch of room for the teleprompter bracket. Make sure the 15mm rods go through both set of monitor mounts. Please ensure that all screws are properly tightened after inserting the monitor.

SAFETY NOTE Make sure to leave at least 2 inches of the rods inside the teleprompter base.

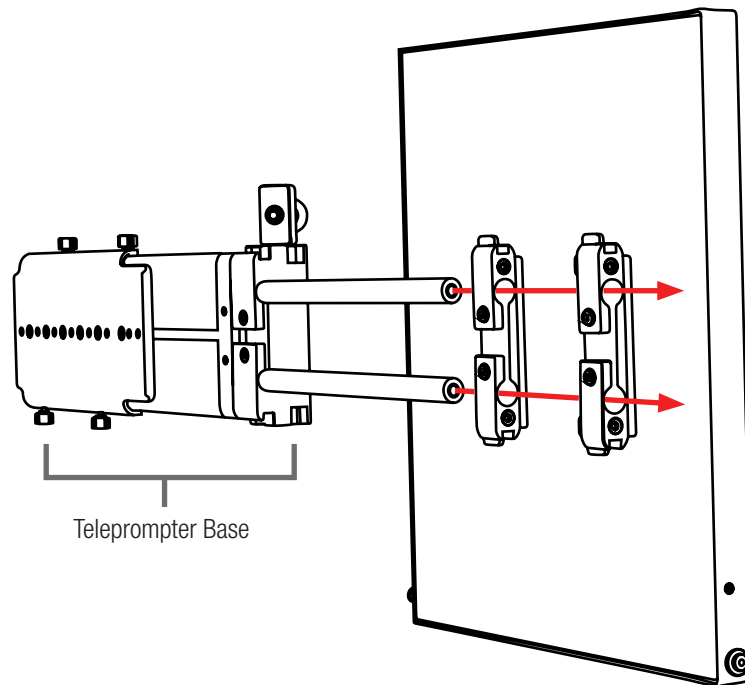

Step 6

While sliding the teleprompter bracket into the slot of the Glass Frame Holder Bracket, pull on the red knob to allow the bracket to fully slide in.

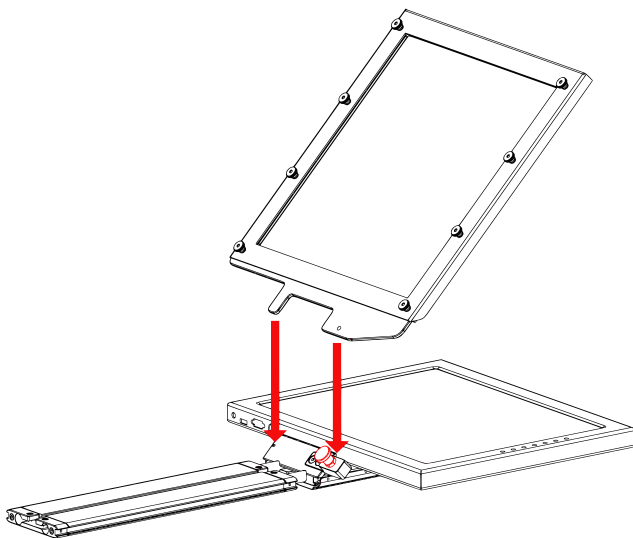

Step 7

Once the bracket is in place, tighten the side screw to lock in place. Double check and make sure all the screws are tightened with the included hex keys.

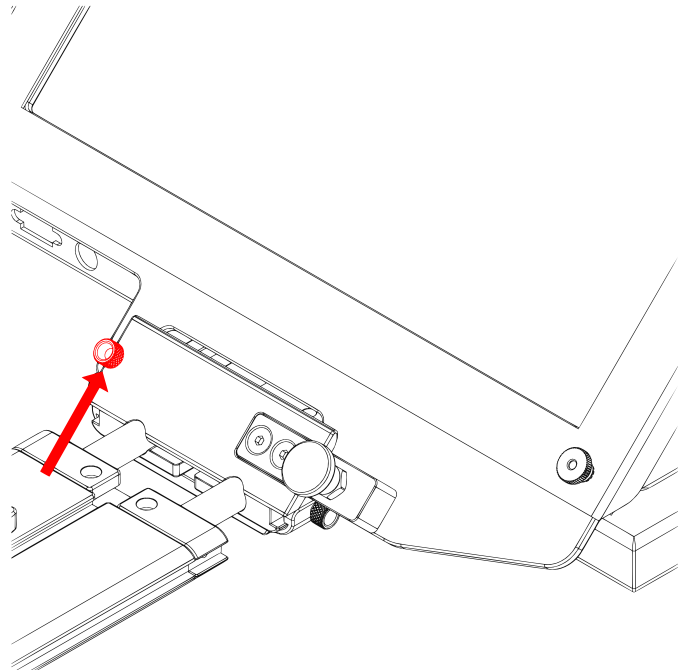

Step 8

Fold the flaps of the Hood alongside the edges of the Hood Attachment Frame. The flaps of the Hood are magnetic so they will automatically attach. Connect the bottom part of the hood by attaching the magnetic flap to glass frame holder. Connect the velcro straps to the sides of the hood.

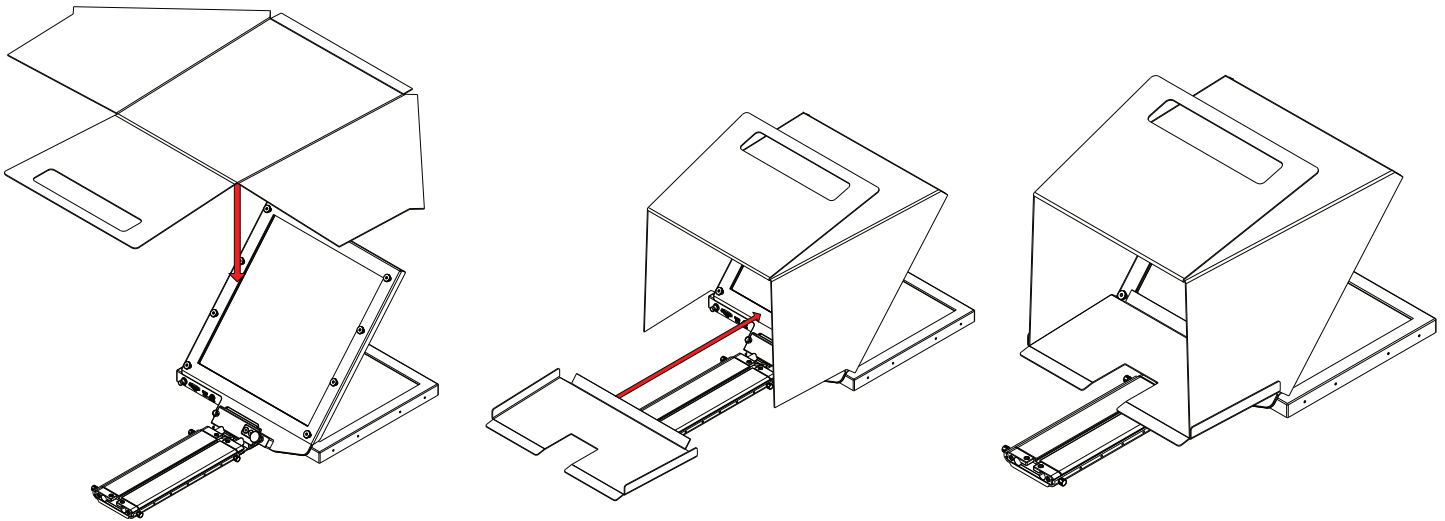

Step 9-A: Connecting the PTZ Riser to the Ikan OTTICA

To connect the PTZ Camera Riser to the Ikan OTTICA camera, fasten the 1/4-20 screw on the PTZ Riser Plate to the thread on the bottom of the OTTICA camera.

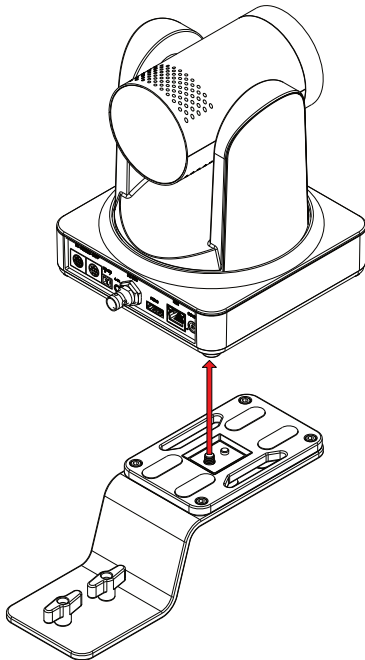

Step 9-B: Connecting the PTZ Riser to other PTZ Cameras

To connect the PTZ Camera Riser to the other PTZ cameras, Remove the plate on top of the PTZ Riser by unfastening the four screws on the surface of the plate. Once the plate has been removed, fasten the 1/4-20 screw on the PTZ Riser Plate to the thread on the bottom of the PTZ camera.

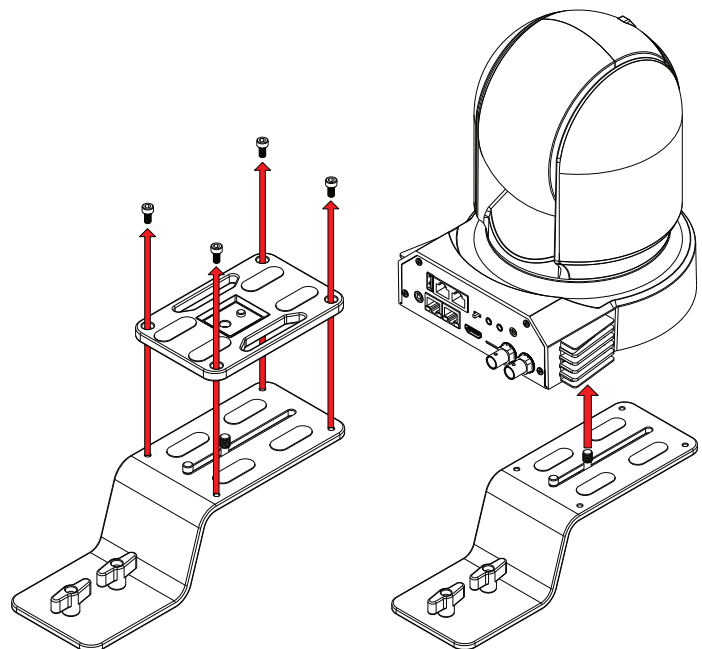

Step 10

Set the PTZ camera inside the hood by aligning the screws on the riser plate to the slot on the Base. Once the screws are aligned, Slide the riser plate into the Base.

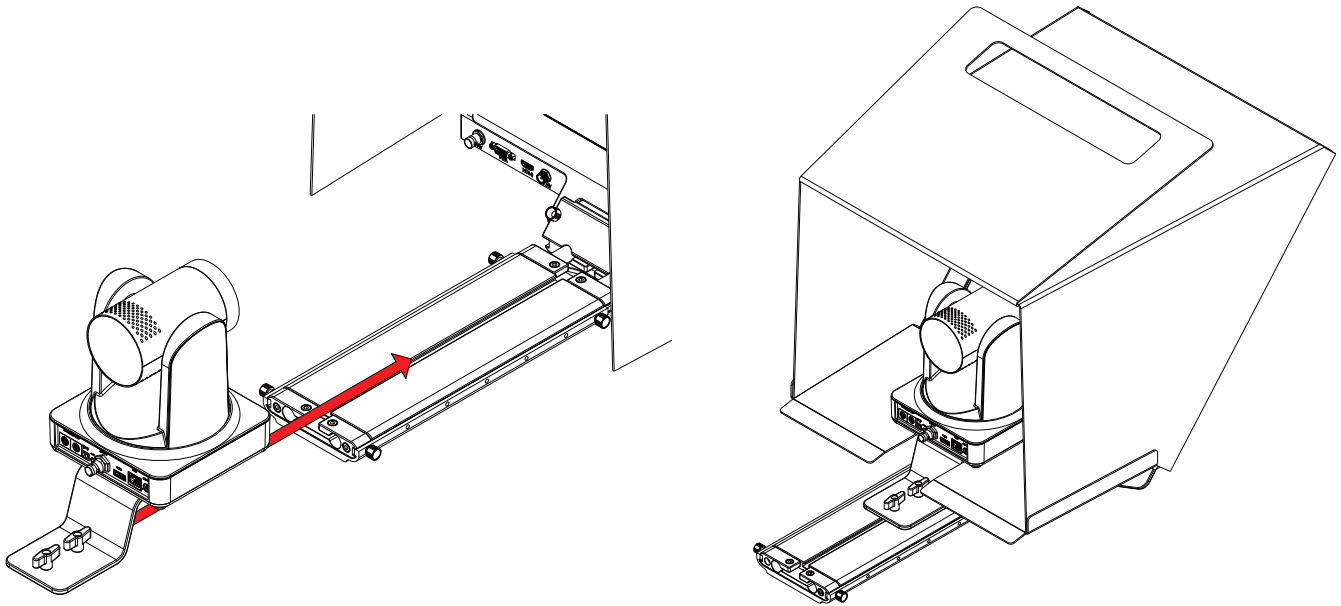

Step 11

To prevent light from leaking through the hood, seal both zippers down, attach the velcro straps along the back and sides of the hood. Connect the cables to the back of your PTZ camera by putting them through the slot on the back of the PTZ Hood. Once your cables are connected, tighten the draw string on the back of the PTZ Hood.

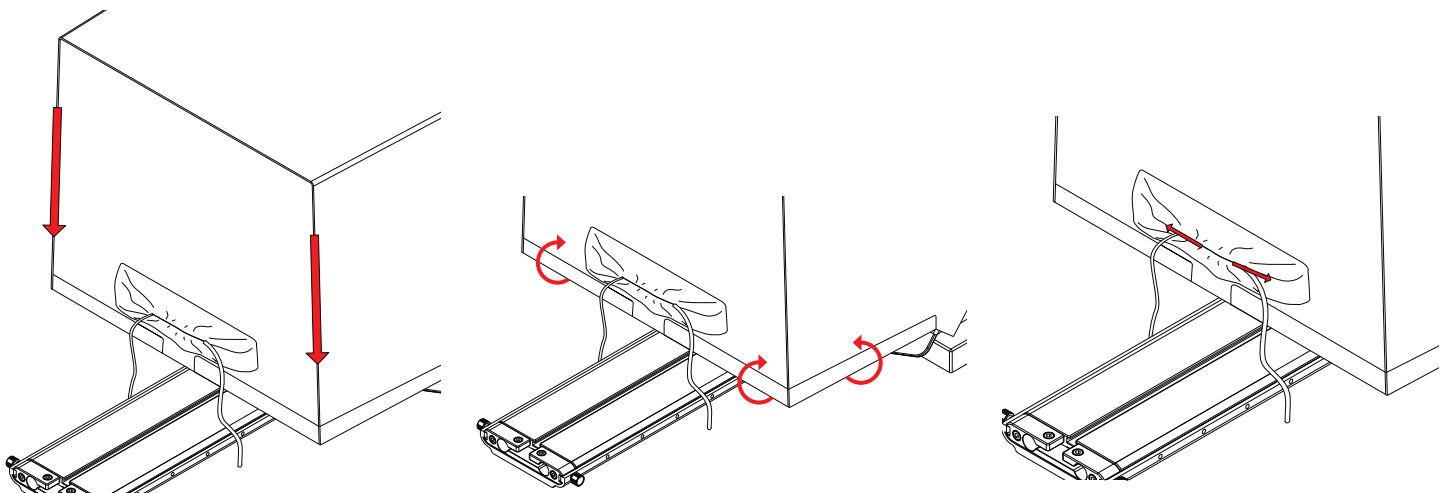

Step 12

Mount your own tripod plate to the bottom plate by aligning the 1/4-20 and/or 3/8-16 screws and fastening them to the Bottom Plate. It is recommended that you connect your tripod plate to front of the Bottom Plate so that you can balance your teleprompter easier. Once your tripod plate is connected to the Bottom Plate, mount the tripod plate to your tripod head.

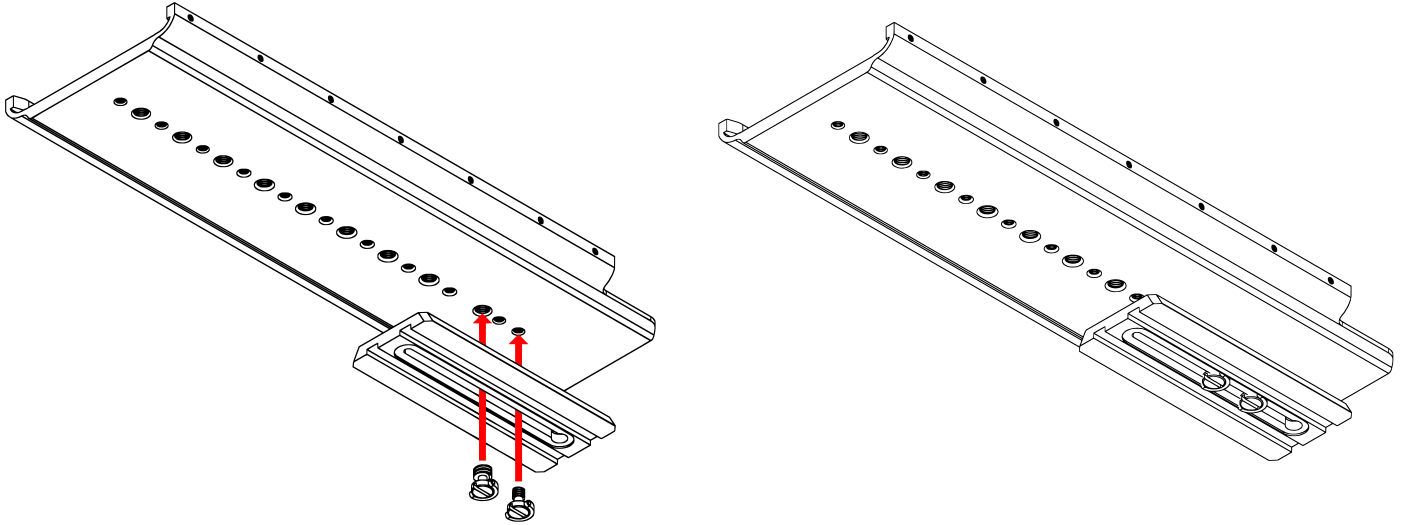

Step 13

In order to properly balance the teleprompter, loosen the 4 screws on the bottom plate and slide the entire teleprompter system back or forward until the center of gravity has been determined. Once the center of gravity has been determined, tighten the thumb screws to keep the base from sliding.

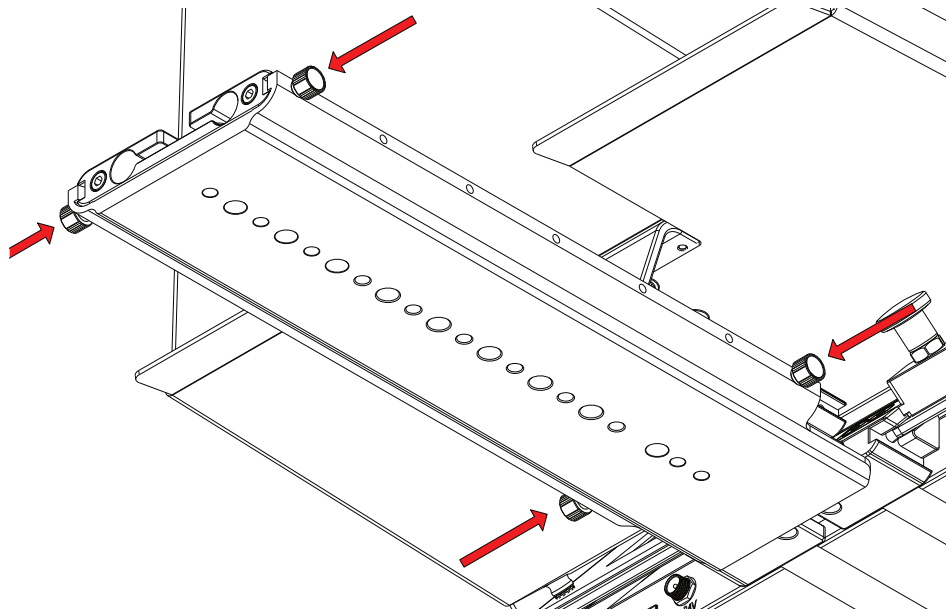

Step 14

To secure your teleprompter system, insert the included headless screws into the threads behind and in front of the Base.

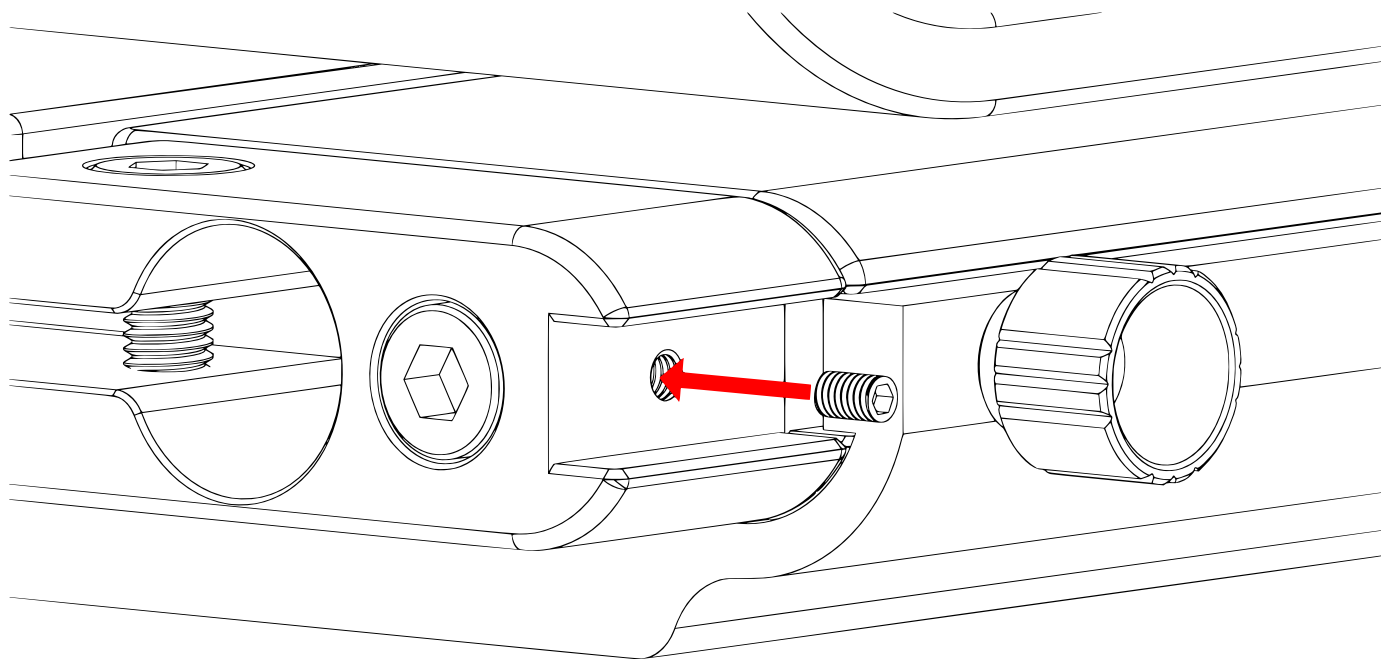

Step 15

The headless screws should be inserted to the threads as pictured below.

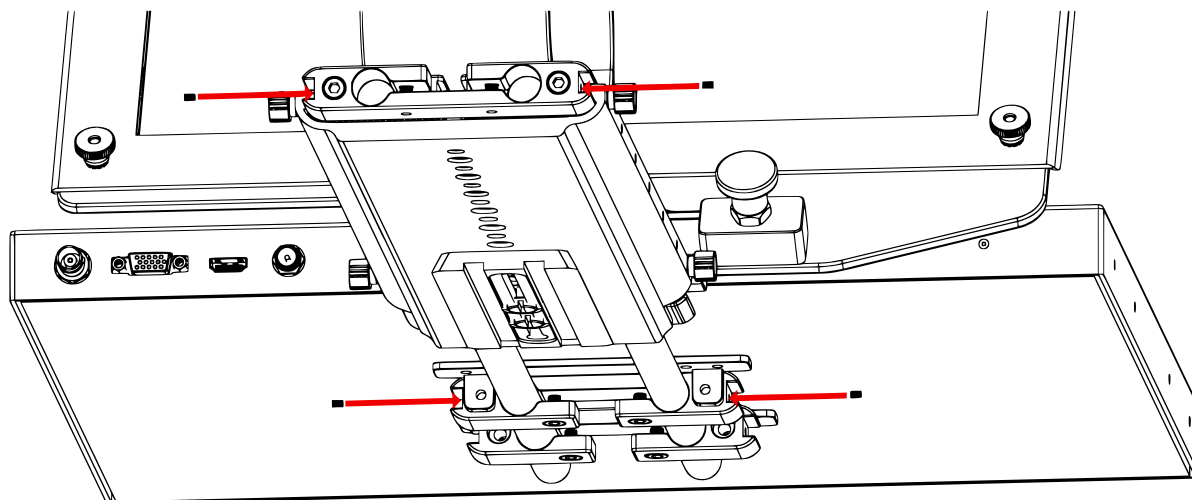

Monitor Ports

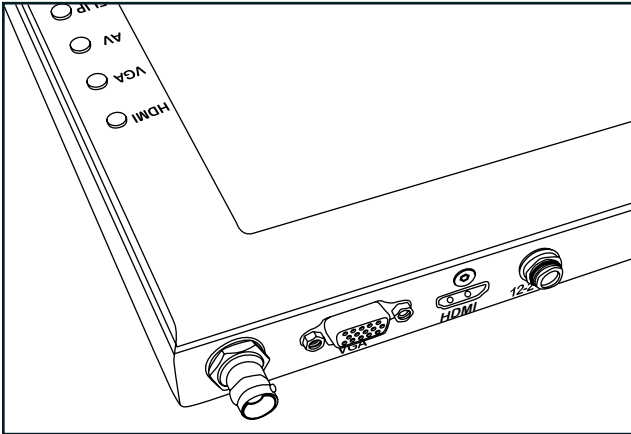

BNC – AV Composite Input
VGA – Video Graphics Array DE15 Connection
HDMI – High-Definition Multimedia Interface Input Connection
Power Port – 12-24v Input

Monitor Menu Settings

Video Config

- Contrast (White Level)
- Brightness (Black Level)
- Tint (Chroma Hue)
- Chroma (Chroma Saturation)
- Sharpness (Detail)
- RGB Setup – Manually configure RGB
- Return

System Config

- Menu Duration – Set duration of how long menu stays on screen
- Video Ratio – Set screen aspect ratio 16:9 or 4:3 (4:3 is native resolution, 16:9 will create black bars)
- Flip-H – Assign toggle button to flip image horizontally
- Flip-V – Assign toggle button to flip image vertically
- Reset – Factory reset
- Return

PC Setup (Only available for VGA)

- H-Position – Adjust horizontal position
- V-Position – Adjust vertical position
- Auto – Monitor automatically adjust position
- Return

Exit

How to set-up FLIP button feature:

1. Press MENU button
2. Navigate to SYSTEM CONFIG.
3. Navigate to FLIP-V or FLIP-H
4. Change FLIP-V and/or FLIP-H to "ON"
5. Exit MENU
6. The FLIP button should now be activated and can be pressed to mirror the image Horizontally or Vertically
7. When FLIP-H is ON, the image will flip Horizontally
8. When FLIP-V is ON, the image will flip Vertically
9. If both are ON, the FLIP button will toggle both Horizontal and Vertical flip

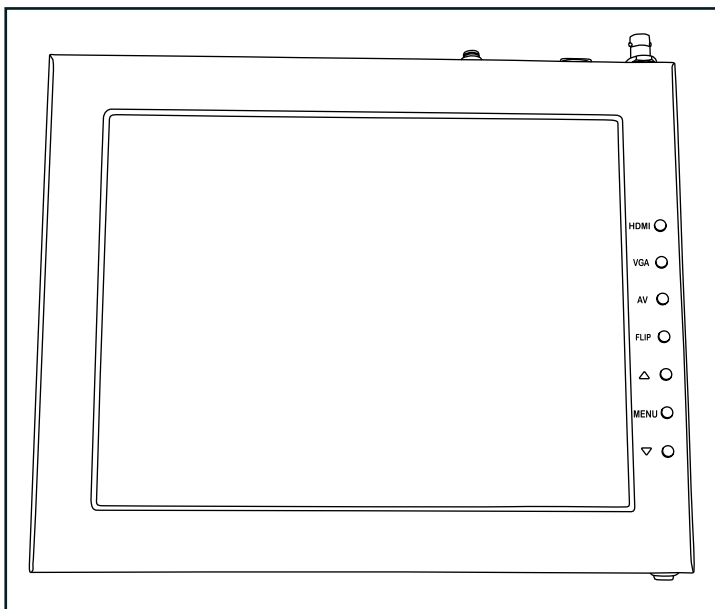

HDMI – Switch HDMI input
VGA – Switch to VGA input
AV – Switch to composite BNC input
Flip – Toggle image flip
(Can be set to horizontal, vertical, or both via menu)
Up Arrow – Toggle up to adjust setting
Menu – Access to monitor settings
Down Arrow – Toggle down to adjust setting

Watch our VIDEO TUTORIAL on how to assemble Ikan Professional Teleprompters:

<https://youtube.com/playlist?list=PLcjaK5n9Y8ctrbYS3t2g4nyx2uAD0XjuF>



Specifications for PT4900-PTZ

TELEPROMPTER SPECS

| | |
|--------------------------------|---|
| Riser Plate Height | Low: 2.06 in./52.5mm Medium: 3.74 in./95mm High: 5.31 in./135mm DSLR: 6.29 in./160mm |
| Length of Rods | 15mm x 400mm |
| Build Material | Chassis: Anodized Aluminum Rods: Carbon Fiber |
| Reading Range | 25 ft. / 7.62 m |
| Beamsplitter Ratio | 70/30 |
| Beamsplitter Shape | Rectangular |
| Beamsplitter Material | Glass |
| Tripod Mounts | 11 x 1/4 in. -20 Female 9 x 3/8 in. -16 Female |
| Product Weight w/ Low Plate | 22.70 lbs. |
| Product Weight w/ Medium Plate | 23.10 lbs. |
| Product Weight w/ High Plate | 23.23 lbs. |
| Product Weight w/ DSLR Plate | 22.60 lbs. |
| Height of Teleprompter | 16 in./ 406mm |
| Angle of Glass Frame Holder | 50° |
| Material of Hood | Polyester Canvas |
| Material of Riser Plates | Aluminum |
| Material of Glass Frame Holder | Aluminum |

MONITOR SPECS

| | |
|------------------------|---------------------------------|
| Aspect Ratio | 4:3 |
| Maximum Brightness | 1000 cd/m2 |
| Screen Size (Diagonal) | 18.5 in. |
| Mount | VESA 100mm |
| Video Inputs | AV COMPOSITE, HDMI, VGA |
| Input Voltage | DC 12v / 4A |
| Power Consumption | 21W |
| Product Weight | 6 lbs. |
| Product Dimensions | 17 in. x 15 in. x 1 in. |
| Native Resolution | 1280 x 1024 |
| Viewing Angle | 160° (H) / 170° (V) |
| Build Material | Aluminum Chassis |
| Image Flip | Horizontal: Yes Vertical: Yes |

Optional Accessories

| | |
|--------------------|--|
| PT4900-GM | Replacement Glass for PT4900 |
| PT19W-TALLY | 19" Widescreen Talent Monitor w/ Tally Add-on Kit for PT4900 |
| PT-PEDAL | Teleprompter Foot Control Pedal |
| PT-CASE-V2 | Rolling Hard Case for PT4900 Teleprompter |

Foam Case

To make your teleprompter more portable, we packed it in a reusable, high-quality foam. The shape and size of the foam was designed to fit into Ikan's PT-CASE-V2.



**** DO NOT THROW AWAY FOAM CASE ****

PT19-TM



Talent Monitor Add On Kit for PT4900

**What's Included**

- ☐ 1 x Teleprompter Monitor w/ Aluminum Chassis
- ☐ 1 x Power Adapter with Cable
- ☐ 1 x VESA Monitor Mount
- ☐ 1 x 15mm Rod Adapter
- ☐ 1 x Mounting Knob
- ☐ 4 x 10mm Screws
- ☐ 4 x 15mm Screws
- ☐ 2 x Large Screws
- ☐ 4 x Riser Washers
- ☐ 1 x Adjustable Plate



Assembly Steps

Setting Up the Talent Monitor

Using the shorter 4 x 10mm Screws, attach the VESA Monitor Mount. Make sure that the long end of the VESA Monitor Mount is pointing in the direction of the power button like the image above. Use the Mounting Knob to tighten the 15mm Rod Adapter to the VESA Monitor Mount.



Setting Up the Teleprompter Monitor (Monitor from the PT4900)

If the mounting brackets were previously installed on the teleprompter monitor, remove those screws. Using the longer 4 x 15mm Screws and 4 x Riser Washers attach the mounting brackets with the washers between the bracket and monitor like the image below.



Attaching the Talent Monitor

After both the talent monitor and teleprompter monitor are set up, slide the talent monitor on to the PT4900.

WARNING We recommend at least 1 inch of rod should be left inside the teleprompter base.



Specifications

PT19-TM

19" High-Bright Teleprompter Monitor

| | |
|---------------------|--------------------------|
| Aspect Ratio | 4:3 |
| Brightness | 1000 cd/m2 |
| Screen Size | 19" |
| Video Inputs | Composite BNC, VGA, HDMI |
| Input Voltage | DC 12v / 4A |
| Power Consumption | 10 w |
| Product Weight | 12 lbs |
| Product Dimensions | 17" x 15" x 1" |
| Native Resolution | 1280 x 1024 |
| Shipping Weight | 14 lbs |
| Shipping Dimensions | 24" x 20" x 4" |
| Viewing Angle | 160° (H) / 170° (V) |
| UPC | 847983033201 |
| Build Material | Aluminum Chassis |

Supported Video Signals

HDMI

720x480i & 720x480p @ 59.94, 60 Hz

720x576i & 720x576p @ 50 Hz

1280x720p @ 50, 59.94, 60 Hz

1920x1080i @ 50, 59.94, 60 Hz

1920x1080psf @ 24, 25, 29.97, 30 Hz

1920x1080p @ 23.98, 24, 25, 29.97, 30, 50, 59.94, 60 Hz

Optional Accessories

Some other products that work well with this item available from Ikan include:

PT4900 19" High Bright Beam Splitter Teleprompter

Learn More

More dynamic information at official website: www.ikancorp.com

Support

Contact email: support@ikancorp.com

CONDITIONS OF WARRANTY SERVICE

- Free service for one year from the day of purchase if the problem is caused by manufacturing errors.
- The components and maintenance service fee will be charged if the warranty period is expired.

Free Service will not be Provided in the Following Situations:(*Even if the product is still within the warranty period.)

- Damage caused by abuse or misuse, dismantling, or changes to the product not made by the company.
- Damage caused by natural disaster, abnormal voltage, and environmental factors, etc.

©2022 Ikan International. All rights reserved.

