

PT4900-PEDESTAL



19" Teleprompter, Pedestal & Dolly Turnkey



OVERVIEW

Ikan's Turnkey Broadcast Solutions include everything you need for your professional camera setup. This solution includes a 19" teleprompter, pedestal, and dolly. All of our systems have been tested internally for payload compatibility.

The remaining payload capacity, after mounting the full 19" teleprompter, can accommodate camera setups up to 38.8 lbs. The pedestal, without the teleprompter system, can accommodate cameras up to 61.7 lbs. This solution also includes a hard case for the pedestal and a carrying bag for the dolly.





PT4900

19" Professional High Bright Beam Splitter Teleprompter

What's Included

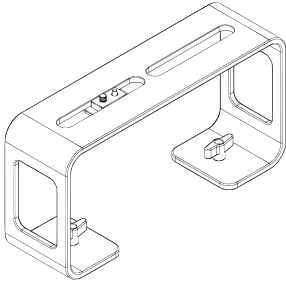

Large Riser

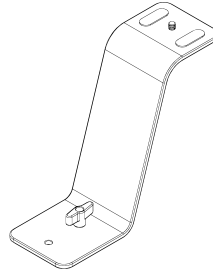

DSLR/Mirrorless Riser

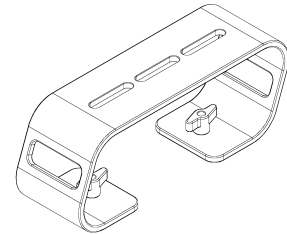

Medium Riser

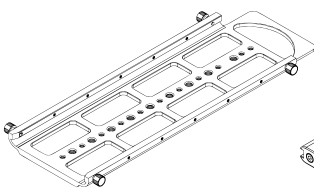

Bottom Plate

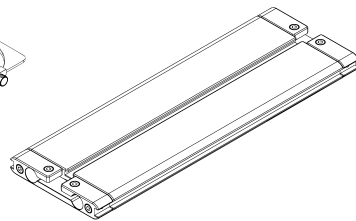

Base

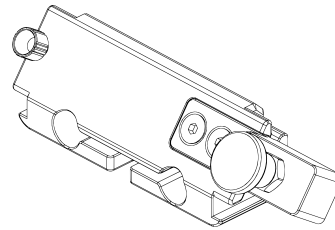

**Glass Frame Holder Bracket
w/ Rod Clamps**

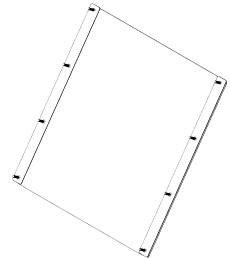

Glass

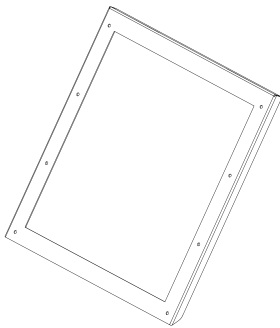

Hood Attachment Frame

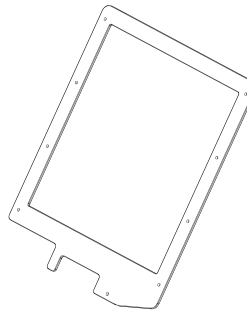

Glass Holder

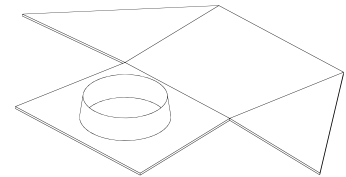

Hood



Glass Frame Screws

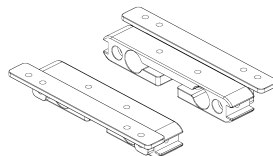

15mm Rod Clamps

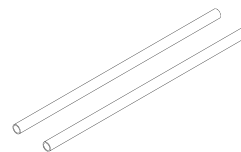

15mm Rods

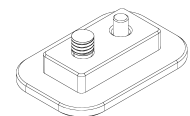

**Large Riser
Bracket**

Teleprompter Assmebly Setup

Step 1

Place the Hood Attachment Frame over the Glass Holder. Then place the glass against the Glass Holder. Make sure the screws pass through the holes on the both the Hood Attachment Frame and the Glass Holder.

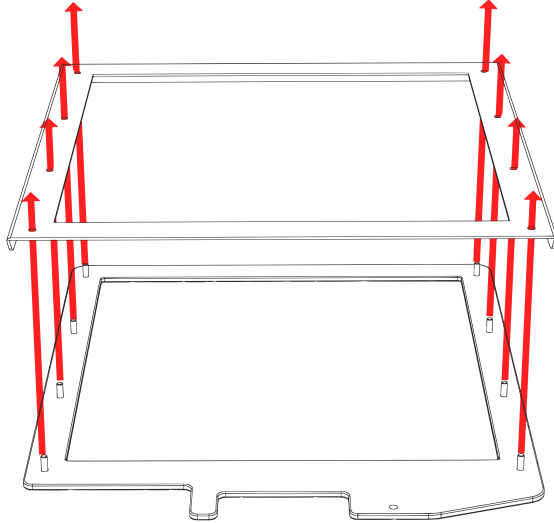

Step 2

Secure the Glass Holder by fastening the knurled nuts to the screws as pictured below.

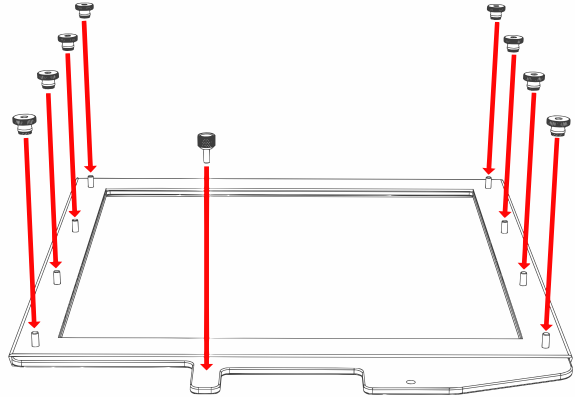

Step 3

Remove the monitor mounts from the teleprompter base using the included larger 4mm hex key to loosen from the 15mm rods.

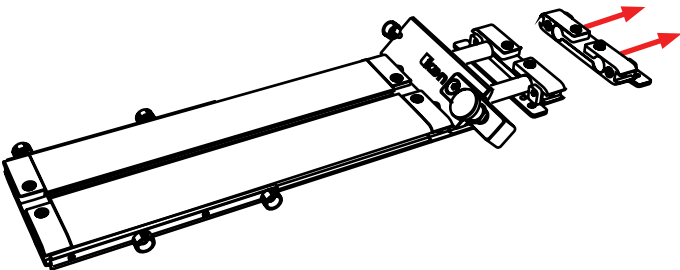

Step 4

Put the washers on before tightening the screws. The washers and 4 additional screws are inside a bag on the bottom foam.

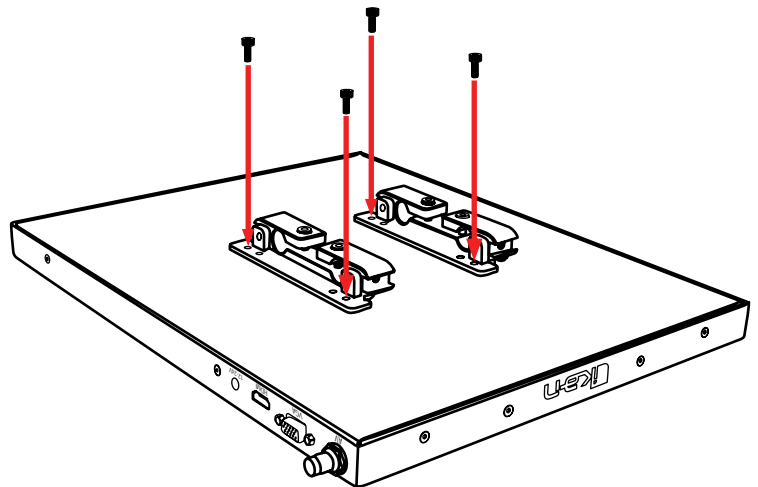

Step 5

After the monitor mounts are attached, adjust the 15mm rods to accommodate the monitor. Leave about 1 inch of room for the teleprompter bracket. Make sure the 15mm rods go through both set of monitor mounts. Please ensure that all screws are properly tightened after inserting the monitor.

SAFETY NOTE Make sure to leave at least 2 inches of the rods inside the teleprompter base.

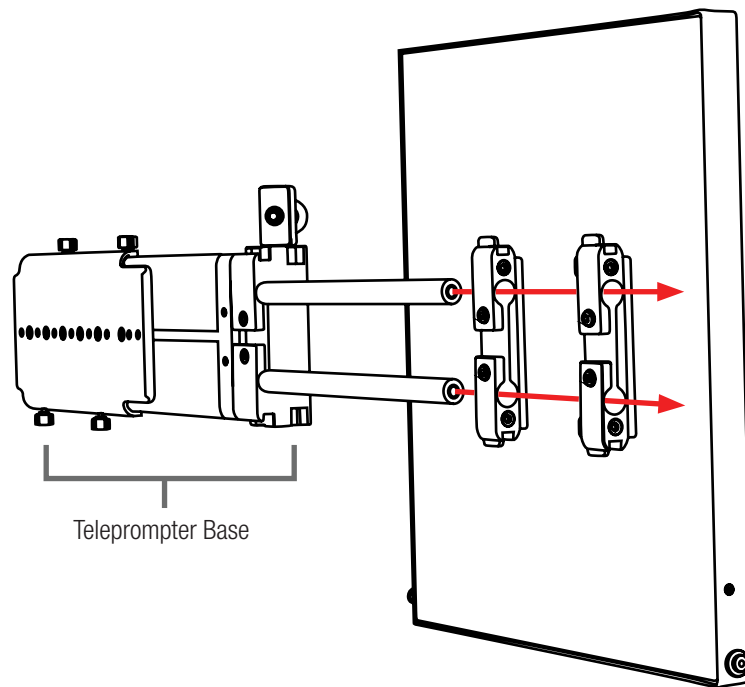

Step 6

While sliding the teleprompter bracket into the slot of the Glass Frame Holder Bracket, pull on the red knob to allow the bracket to fully slide in.

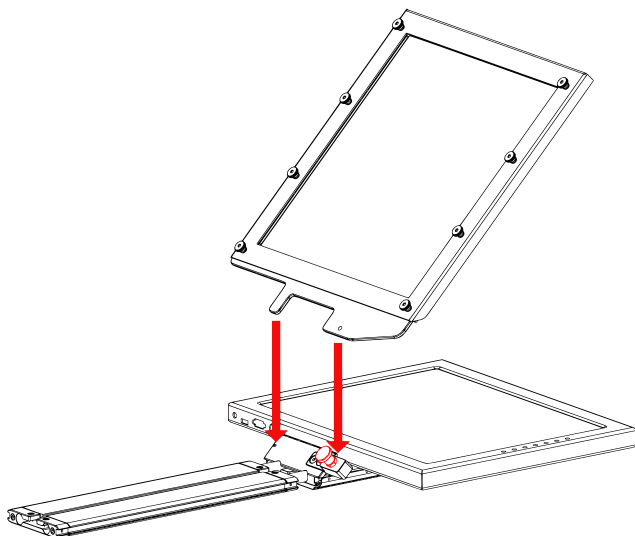

Step 7

Once the bracket is in place, tighten the side screw to lock in place. Double check and make sure all the screws are tightened with the included hex keys.

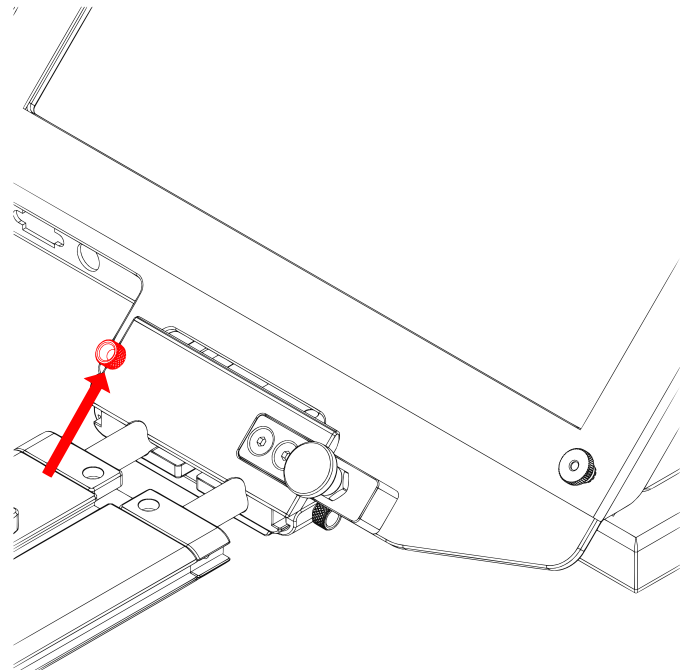

Step 8

Fold the flaps of the Hood alongside the edges of the Hood Attachment Frame. The flaps of the Hood are magnetic so they will automatically attach.

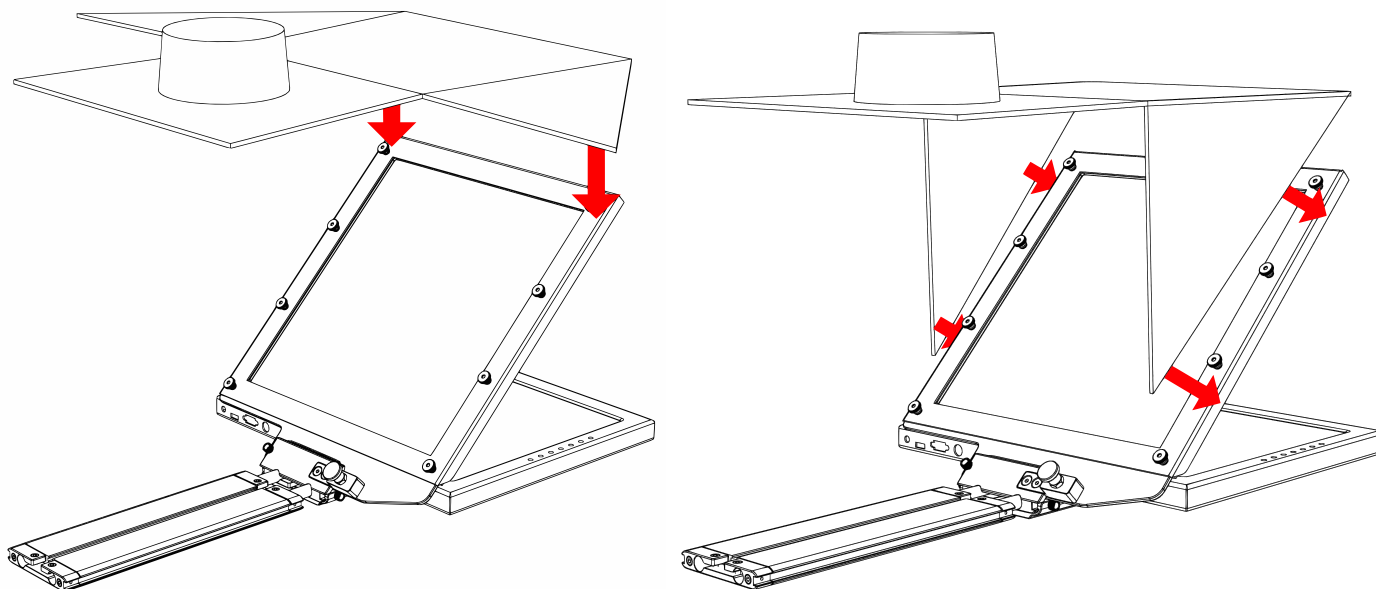

Step 9

To prevent light from leaking through the hood, seal both zippers down.

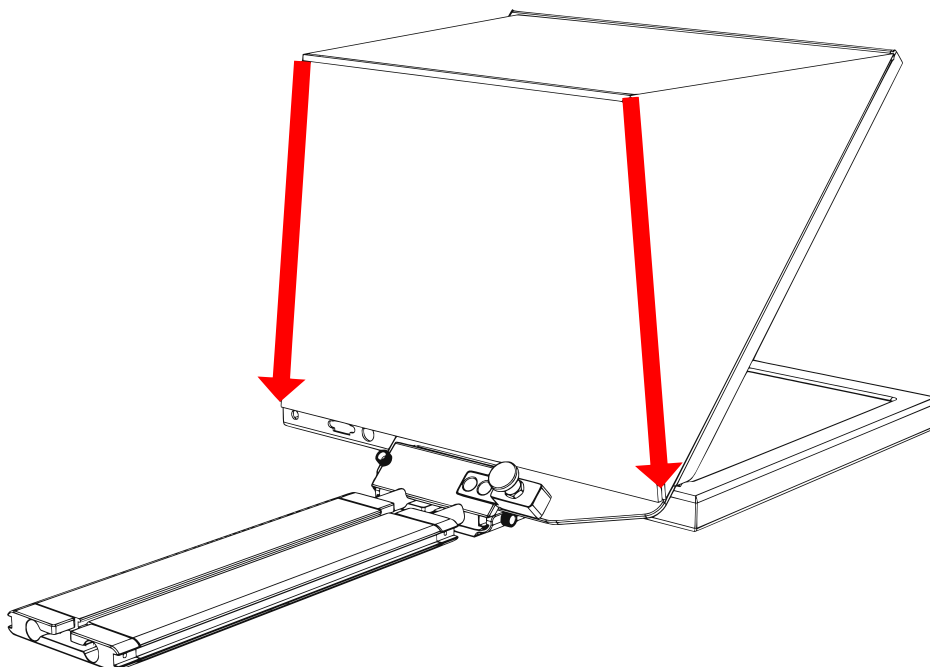

Step 10

Slide in the Riser plate of your choice by aligning the screws on the riser plate to the slot on the Base. Once the screws are aligned, Slide the riser plate into the Base.

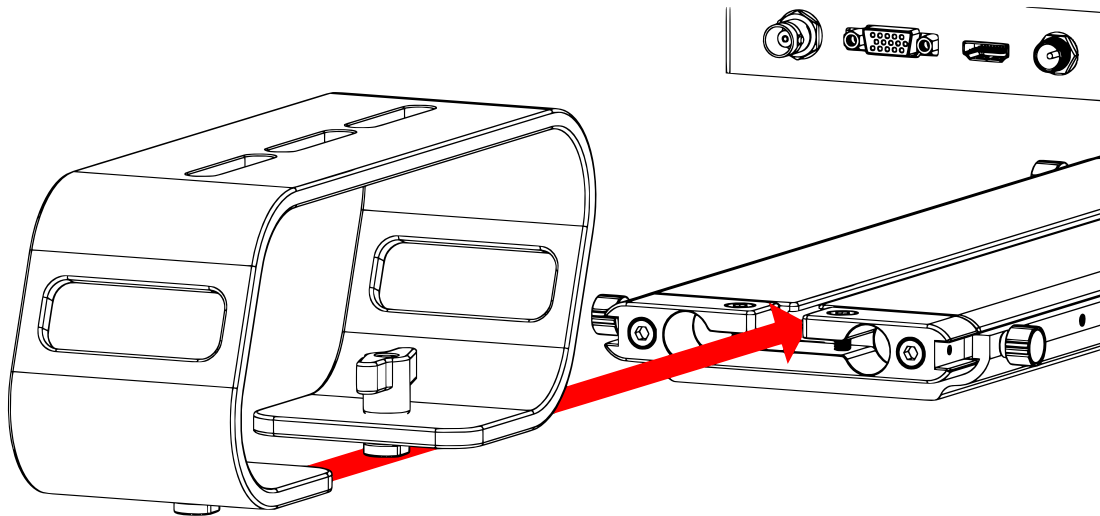

Step 10

Slide in the Riser plate of your choice by aligning the screws on the riser plate to the slot on the Base. Once the screws are aligned, Slide the riser plate into the Base.

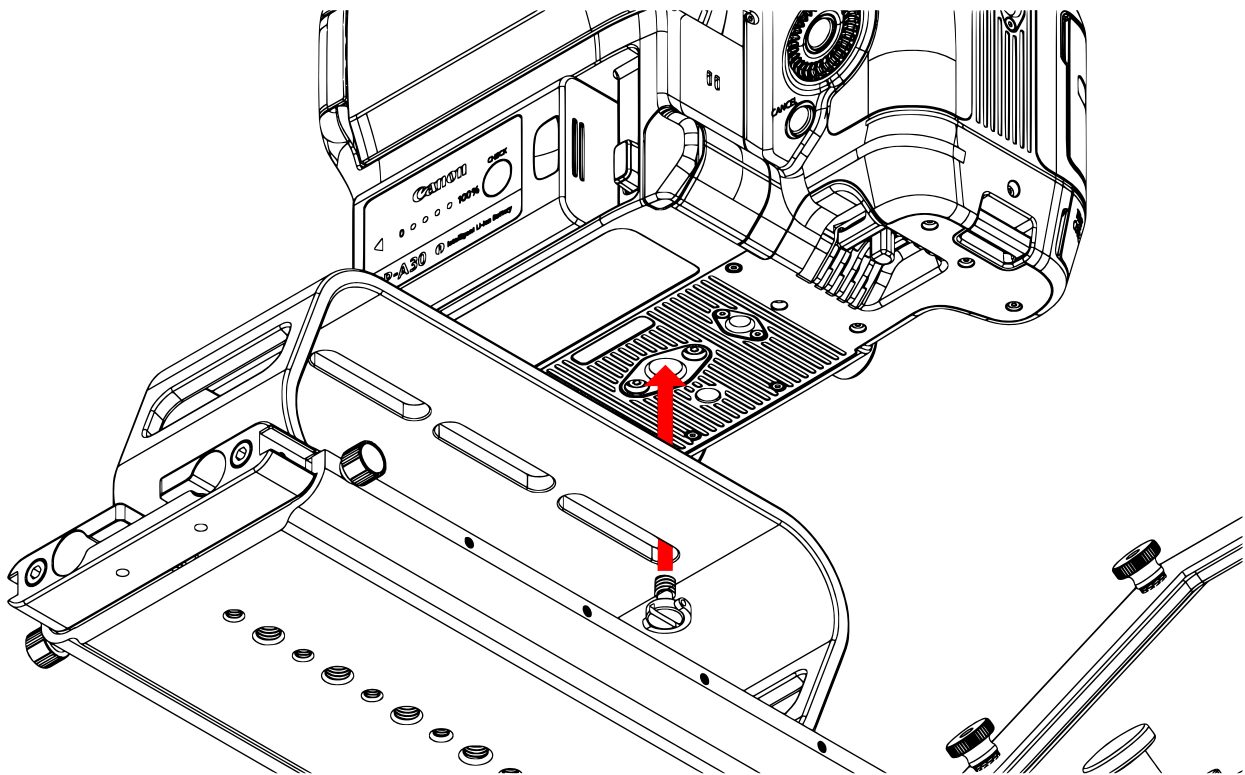

Step 12

Mount your own tripod plate to the bottom plate by aligning the 1/4-20 and/or 3/8-16 screws and fastening them to the Bottom Plate. It is recommended that you connect your tripod plate to front of the Bottom Plate so that you can balance your teleprompter easier. Once your tripod plate is connected to the Bottom Plate, mount the tripod plate to your tripod head.

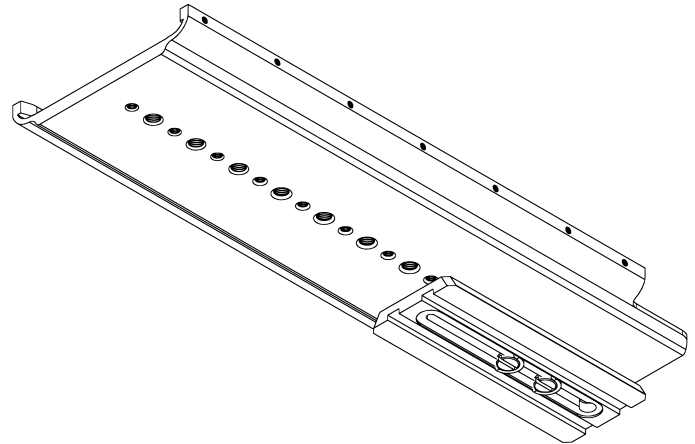
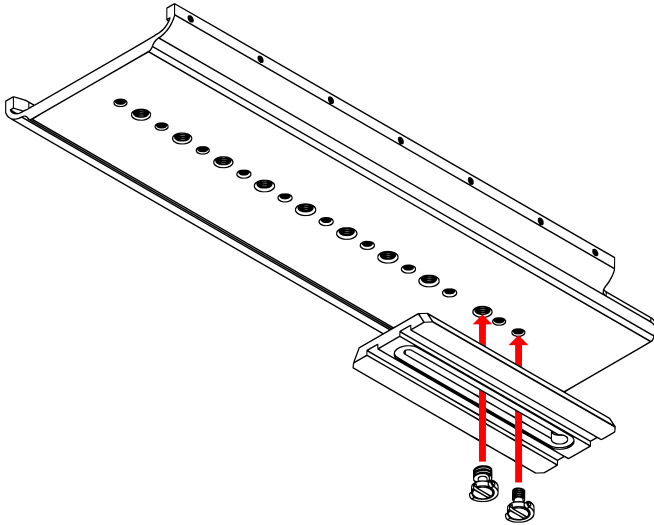

Step 13

Slide the entire teleprompter system into the Bottom Plate. Once the teleprompter system is inserted, you can balance it by sliding it along the Bottom Plate until the center of gravity is determined.

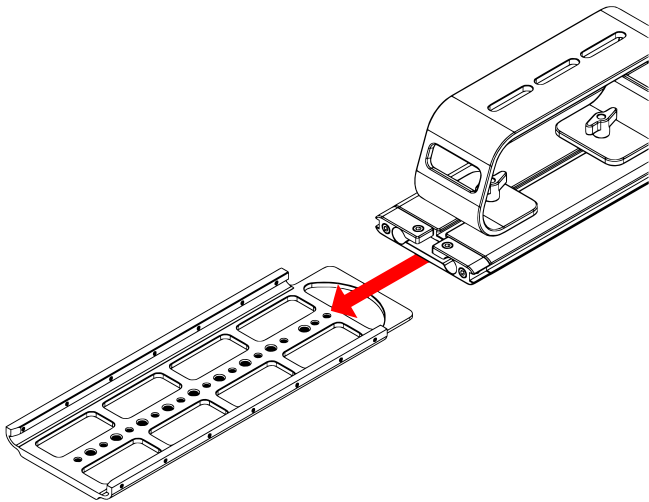

Step 14

Once the center of gravity has been determined, tighten the thumb screws to keep the base from sliding.

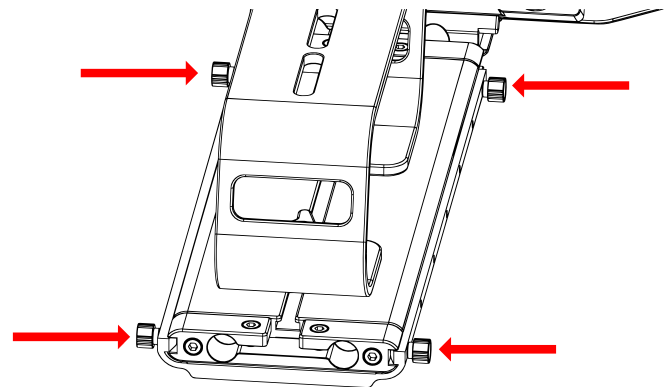

Step 15

To secure your teleprompter system, insert the included headless screws into the threads behind and in front of the Base.

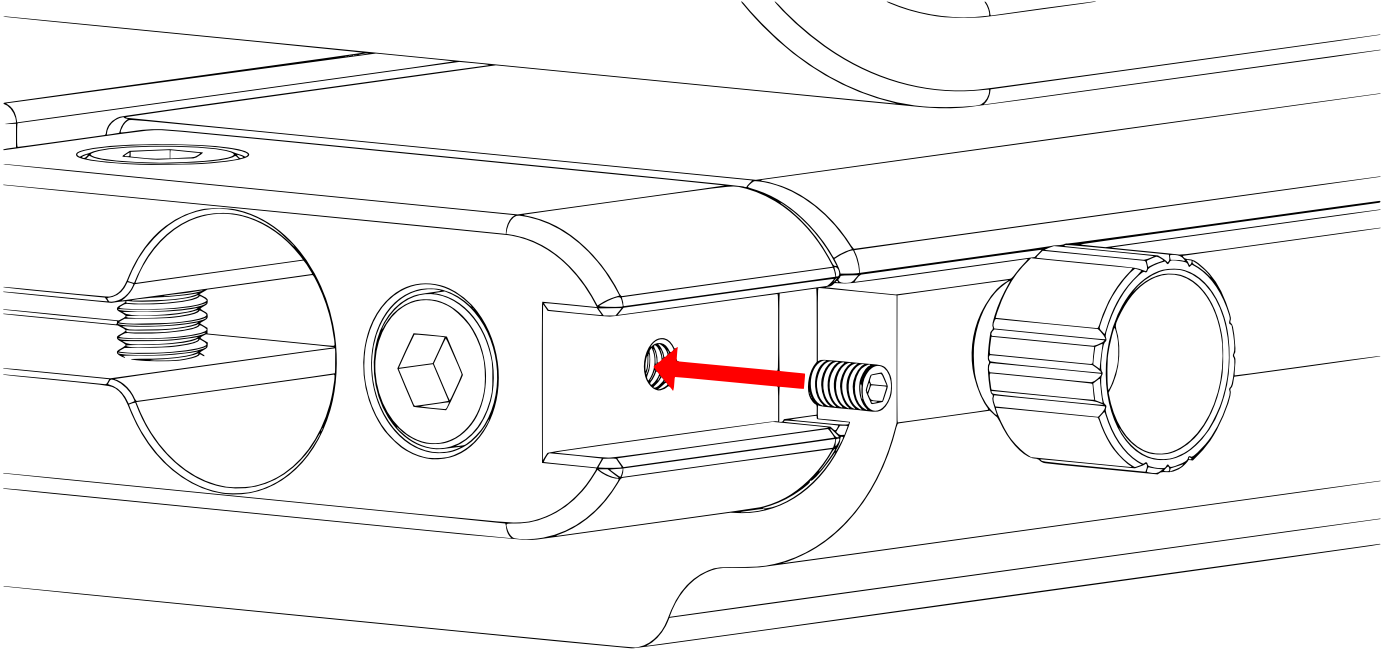

Step 16

The headless screws should be inserted to the threads as pictured below.

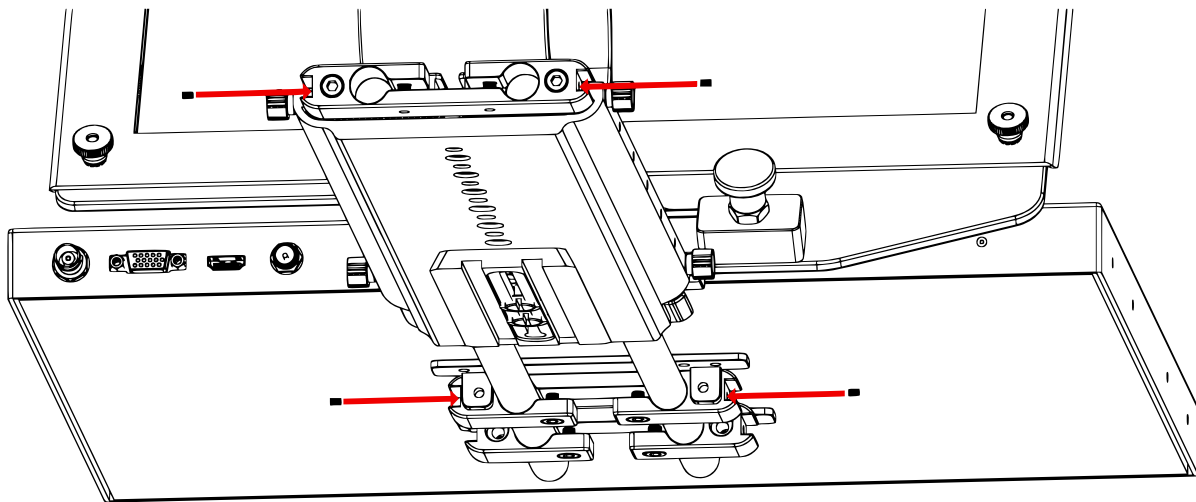

Monitor Ports

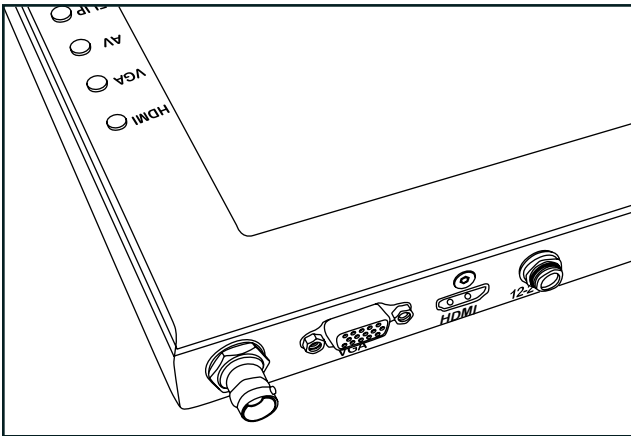

BNC – AV Composite Input
VGA – Video Graphics Array DE15 Connection
HDMI – High-Definition Multimedia Interface Input Connection
Power Port – 12-24v Input

Monitor Menu Settings

Video Config

- Contrast (White Level)
- Brightness (Black Level)
- Tint (Chroma Hue)
- Chroma (Chroma Saturation)
- Sharpness (Detail)
- RGB Setup – Manually configure RGB
- Return

System Config

- Menu Duration – Set duration of how long menu stays on screen
- Video Ratio – Set screen aspect ratio 16:9 or 4:3 (4:3 is native resolution, 16:9 will create black bars)
- Flip-H – Assign toggle button to flip image horizontally
- Flip-V – Assign toggle button to flip image vertically
- Reset – Factory reset
- Return

PC Setup (Only available for VGA)

- H-Position – Adjust horizontal position
- V-Position – Adjust vertical position
- Auto – Monitor automatically adjust position
- Return

Exit

How to set-up FLIP button feature:

1. Press MENU button
2. Navigate to SYSTEM CONFIG.
3. Navigate to FLIP-V or FLIP-H
4. Change FLIP-V and/or FLIP-H to "ON"
5. Exit MENU
6. The FLIP button should now be activated and can be pressed to mirror the image Horizontally or Vertically
7. When FLIP-H is ON, the image will flip Horizontally
8. When FLIP-V is ON, the image will flip Vertically
9. If both are ON, the FLIP button will toggle both Horizontal and Vertical flip

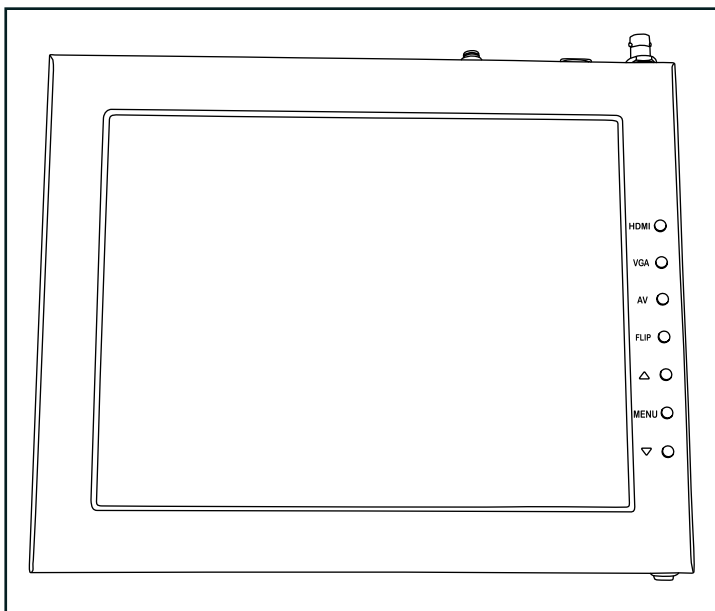

HDMI – Switch HDMI input
VGA – Switch to VGA input
AV – Switch to composite BNC input
Flip – Toggle image flip
(Can be set to horizontal, vertical, or both via menu)
Up Arrow – Toggle up to adjust setting
Menu – Access to monitor settings
Down Arrow – Toggle down to adjust setting

Watch our VIDEO TUTORIAL on how to assemble Ikan Professional Teleprompters:

<https://youtube.com/playlist?list=PLcjaK5n9Y8ctrbYS3t2g4nyx2uAD0XjuF>



Specifications

PT4900

Aspect Ratio	4:3
Backlight	LED
Brightness	1000 nits
Build Material	Aluminum Chassis
Diagonal	19"
Input Signal	Composite BNC, VGA, HDMI
Input Voltage	DC 12v / 4A
Power Consumption	10W
Reading Range	25'
Resolution	1280 x 1024
Viewing Angle	160° (H) / 170° (V)
Weight	33.75 lbs
Shipping Weight	36 lbs
Shipping Dimensions	25 x 20 x 16 in

Optional Accessories

PT4900-GM	Replacement Glass for PT4900
PT19-TM	19" Talent Monitor Add On Kit for PT4900
PT-PEDAL	Teleprompter Foot Control Pedal
PT-CASE-V2	Rolling Hard Case for PT4900 Teleprompter

Foam Case

To make your teleprompter more portable, we packed it in a reusable, high-quality foam.
The shape and size of the foam was designed to fit into Ikan's PT-CASE-V2.



**** DO NOT THROW AWAY FOAM CASE ****

Learn More

More dynamic information at official website: www.ikancorp.com

Support

Contact email: support@ikancorp.com

CONDITIONS OF WARRANTY SERVICE

- Free service for one year from the day of purchase if the problem is caused by manufacturing errors.
- The components and maintenance service fee will be charged if the warranty period is expired.

Free Service will not be Provided in the Following Situations:(*Even if the product is still within the warranty period.)

- Damage caused by abuse or misuse, dismantling, or changes to the product not made by the company.
- Damage caused by natural disaster, abnormal voltage, and environmental factors, etc.

©2022 Ikan International. All rights reserved.



The magic life in the image world

E-IMAGE

EP880SK Pedestal



182.0cm 71.7in	3.0-28.0kg 6.6-61.7lbs
102.5cm 182.5in	28.5kg 15.0lbs
38.0cm 15.0in	100mm

Component:

Fluid head	GH25
Pedestal	EP880S
Dolly	E7007



Pneumatic column pedestal system



Air-pressure in the pneumatic column can be adjusted



Fluid head with 100mm ball



Double-wheel 125mm casters with adjustable cable guards



The magic life in the image world

E-IMAGE

GH25 100mm Fluid Head



100mm



3.0-28.0kg
6.6-61.7lbs



1-15

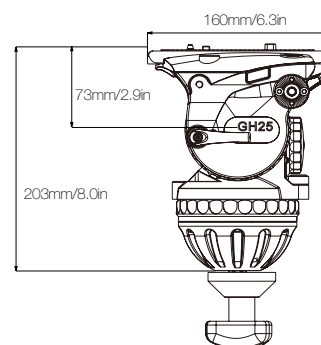
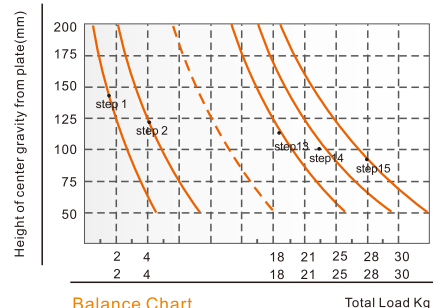

FEATURES



7 plus 0 grades of pan & tilt drag



15 steps of counterbalance











Illuminated leveling bubble



Additional standard 1/4" & 3/8" screw holes

SPECIFICATIONS

Model	GH25
 Payload Range	3.0-28.0kg / 6.6-61.7lbs
 Counterbalance Range	1-15
 Grades Of Pan Drag	0-7
 Grades Of Tilt Drag	0-7
 Tilt Range	-65°/+90°
 Temperature Range	-40°C~+80°C
 Bowl Size	100mm
 Net Weight	4.2kg / 9.2lbs



The magic life in the image world

E-IMAGE

EP880S Pedestal



165.0cm
65.0in



30.0kg
66.1lbs



86.0cm
33.9in



23.9kg
52.7lbs



38.0cm
15.0in



100mm

Component:

Pedestal	EP880S
Dolly	EI7007



Pneumatic column
pedestal system



Air-pressure in the
pneumatic column
can be adjusted



Ergonomic hand
wheel



Double-wheel 125mm
casters with adjustable
cable guards



The magic life in the image world

E-IMAGE

EI-7007 Super dolly

Designed for pedestal system and other heavy duty system. The 125mm/5inch wheels with cable guard can be individually braked, also the movement direction can be fixed.

Folds for transporting.



10.7kg
23.6lbs



100cm
39.4in



100.0kg
220.5lbs



125mm
5.0in



21.5cm
8.5in

FEATURES



Pull the knob to extend the dolly, easy to go out.

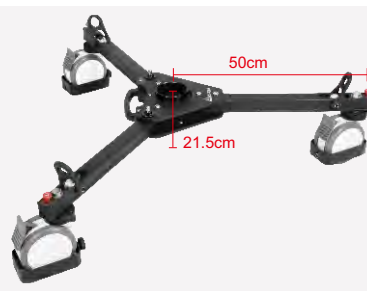

Height : 21.5cm / 8.5in
Radius: 50cm / 19.7in



Casters diameter: 125mm / 4.9in.



The rubber wheels are non-marring during normal use, protecting the floor surface. Each wheel incorporates its own foot-activated brake.



Cable guards and brakes.



Payload
100kg
Supports up to 100kg of tripod, camera and accessories.



GB4 Telescopic Pan Handle

Telescopic pan handle for GH15, GH25, MH22, MH32 heads.



Specifications:

Length range	425-610mm / 16.7-24.0in
Net weight	420g / 0.9lbs