

780FH Flat Base Fluid Head

780FH Fluid Head is designed and built for professional videographers and cinematographers who want real quality at an affordable price. The fixed counterbalance helps support payloads of up to 10kg (22lbs) and combined with a variable tilt drag allows you to adjust the movement to suit your needs.

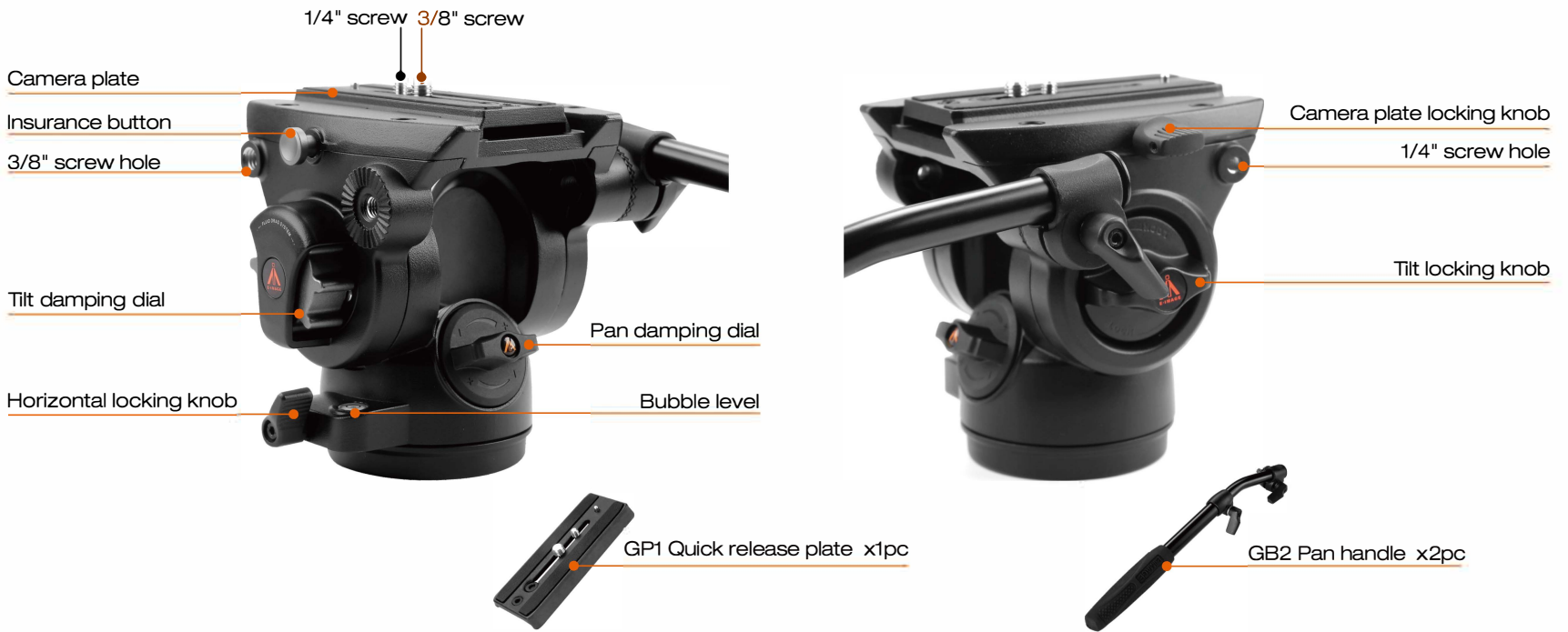

Features



Tilt drag is continuous adjustable.



Pan drag is continuous adjustable.



A built-in bubble level to assist balancing.



GP1 quick release plate.



Additional 1/4"-20 & 3/8"-16 screw hole for articulating accessories.

Specifications

	Max Payload	10kg / 22lbs
	Counterbalance Payload	6kg / 13.2lbs
	Counterbalance	Fixed
	Grades of pan drag	Continuous adjustable
	Grades of tilt drag	Continuous adjustable

	Tilt range	-75°~+90°
	Temperature range	-40°C~+80°C
	Net weight	1.8kg / 4.0lbs
	Bowl size	Flat base

Counterbalance Graph

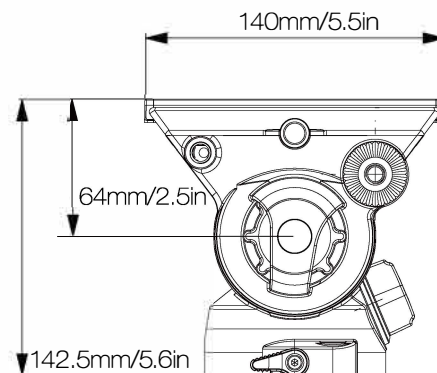
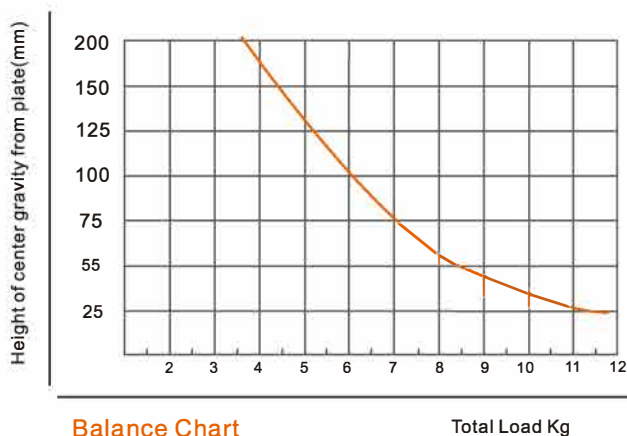



E-IMAGE Tripod GA230 Instruction

Description

The E-IMAGE new designed tripod with geared center column is extremely solid and wobble free. Geared center column provides extra height if you need to get your camera high up, filming sports or events. It includes built-in bubble level, rubber feet with retractable spikes can be used on uneven ground. The tripod is compatible with E-IMAGE EI7004C dolly. A mid-level spreader and a padded carrying case are included with the tripod.

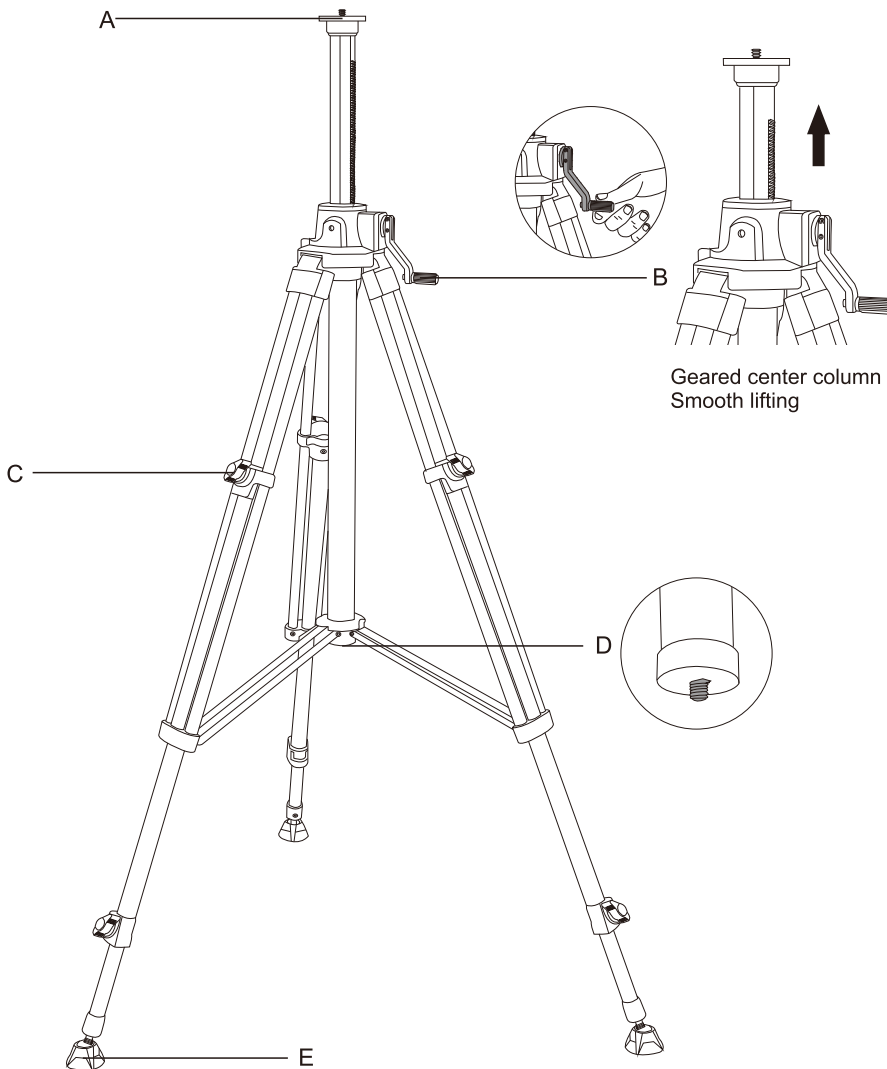

GA230

- A: Flat base with 1/4" screw
- B: Gear elevator handle
- C: Locking knob
- D: 3/8" screw
- E: Anti-slide rubber pad

Specifications

Model No.	GA230
Payload	12kg/26.5lbs
Elevator height	43cm/16.9in
Height range	84-230cm/33.1-90.6in
Net Weight	4800g/10.6lbs
Transport length	89cm/35.0in
Material	Aluminum
Sections	3

In the box

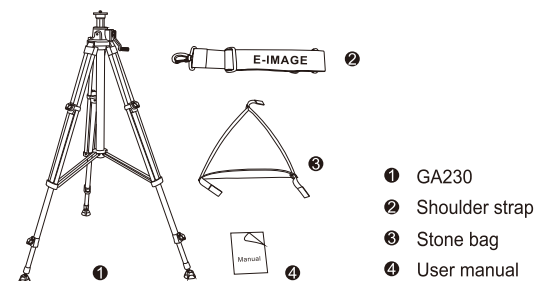

Contact Information

NINGBO EIMAGE STUDIO EQUIPMENT CO., LTD

Add: NO.1230 South Cihai Road, Luotuo Industry Zone, Zhenhai, Ningbo, China 315202
Tel: +86-574-86590061/86590031
E-mail: sales@eimagevideo.com
Visit www.eimagevideo.com for more information



EIMAGE official QR code



E-IMAGE Tripod GA230 Instruction

Instructions

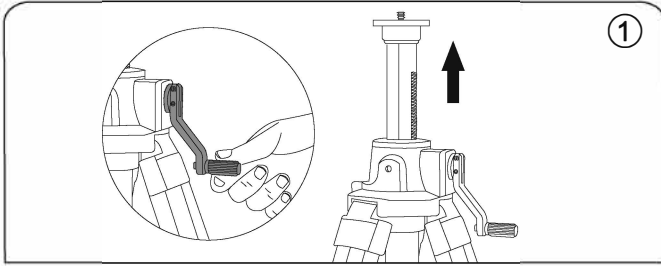

1. The geared center column will raise up when you revolve the crank clockwise, otherwise, it goes down.

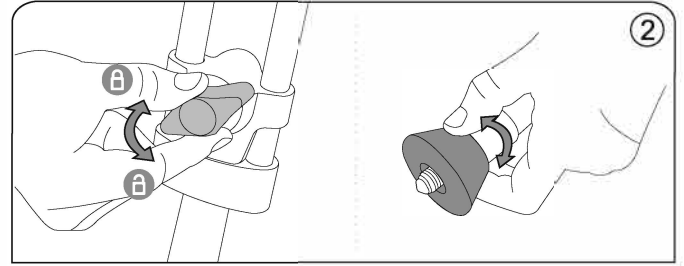

2-1. Open the locking to expand or collapse tripod tube.

2-2. Rubber feet with retractable spikes.

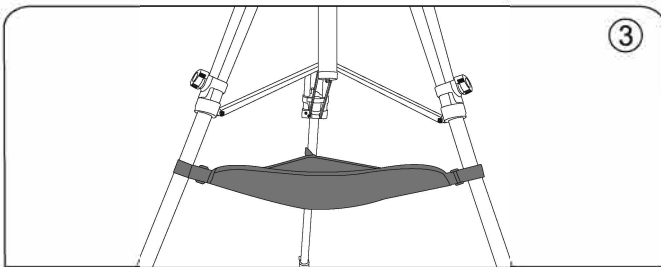

3. Stone Bag attaches to your tripod's three legs and supports a counterweight, which can provide additional stability and balance.

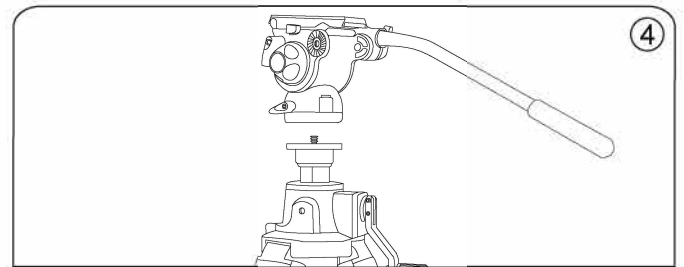

4. Fluid head or camera can be attached to the tripod directly.

EI-7003 Basic Dolly

Designed for light and medium weight tripods. The 76mm/3 inch wheels have a sure-lock feature and can be individually braked. Folds for transporting.



Leg setting rubber.



Pull the knob to extend the dolly, easy to go out.



Each wheel incorporates its own foot-activated brake.

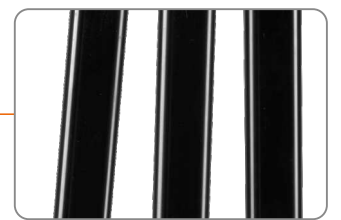

High quality aluminum tube.



The rubber wheels are non-marring during normal use, protecting the floor surface.

Specifications:

Payload	40.0kg / 88.0lbs
Net weight	3.5kg / 7.7lbs
Footprint dia.	100cm / 39.4in
Casters dia.	75mm / 3.0in
Working height	14.5cm / 5.7in

GB2 Telescopic Pan Handle

Telescopic pan handle for GH06F,GH06,GH08,GH10,630FH,EH630,EH650,780FH,EH780,EH780 PLUS heads.



Specifications:

Length range	380-595mm / 15.0-23.4in
Net weight	280g / 0.6lb