

ikan

CTL-USB01

User Manual

ikan
www.ikancorp.com

3903 Stoney Brook Dr. Houston TX 77063
1.713.272.8822
support@ikancorp.com
© 2013 ikan Corporation. All right reserved



USB Control Grip

> Overview

The ikan USB Control Grip is designed for Canon DSLR cameras which use Canon's USB protocol. This ergonomically shaped control can be used in either Still or Video mode, with full control of live-view, focusing, and aperture settings.



What's included:
USB Control Grip
Coiled A to Mini-B USB Cable
2 x AA Batteries (1.5v each)

> Introduction

The ikan USB Control Grip is a battery powered USB device specifically designed for communicating via Canon's USB protocol with Canon DSLR Cameras (*see Note¹ below). Functions include Focus, Aperture, Zoom Display, Live View and Record Start/Stop.

> Main Features

- 8 Function Keys
(Near/Far, Zoom Display, Aperture, Live View, Record Start/Stop and On/Off)
- Live-view control
- 1/4"-20 Sockets for mounting on top and bottom
- LED display for Step Values
- Automatic Shutdown
- Soundless Buttons
- Simple operation & easy portability

Note¹

- Compatible Models: 1D X, 1D Mk IV, 1D Mk III, 5D Mk III, 5D Mk II, 6D, 7D, 60D, 50D, 40D, Rebel T4i, 650D, Rebel T3i, 550D, Rebel T1i, 500D, Rebel XSi, 450D, Rebel T3, 1100D, Rebel XS, 1000D, M
- Not all features work with all models or models that have non-factory firmware installed

> Disclaimer

The ¼"-20 sockets on top and bottom of this device are designed for ease in mounting and positioning, they are not intended to support your rig or kit. Excessive force or weight on these points can result in failure, causing bodily injury or damage to the device itself and any or all attached equipment. Failure resulting from misuse is not covered under warranty and the manufacturer cannot be held liable for any resulting damages or injury.

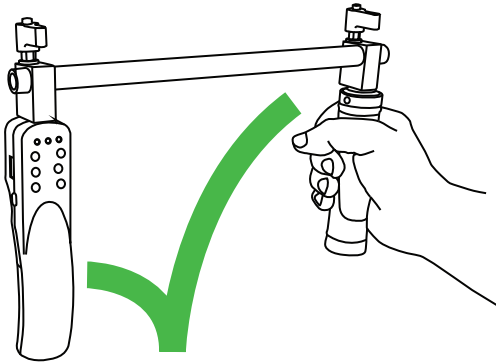

Use Alternate Grip to support or lift equipment

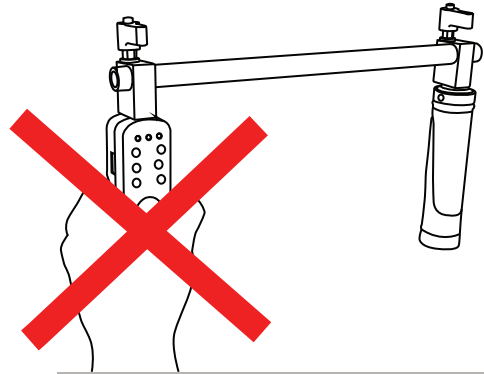

Do not support equipment solely by USB Grip Control. Breakage or injury may occur

> Key for diagram

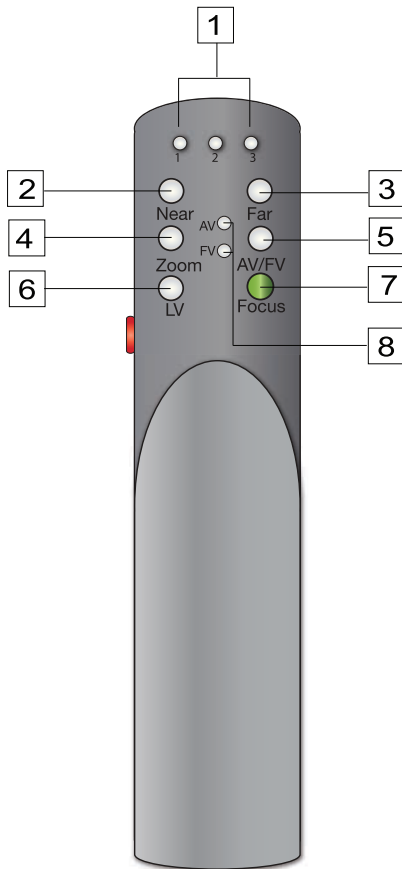

- 1** Indicator Lights 1, 2, 3:
This indicates how many steps focus is advanced when Near or Far Buttons are used
- 2** Near:
*In Focus Mode, pressing the Near Button will move focus closer (focus speed will be determined by step rate).
In Aperture Mode, pressing the Near Button will open the aperture*
- 3** Far:
*In Focus Mode, pressing the Far Button will move focus towards infinity (focus speed will be determined by step rate)
In Aperture Mode, pressing the Far Button will close the aperture*
- 4** Zoom:
Toggles Zoom display, press once for 5x magnification, press once more for 10x magnification and press once again to return to normal view
- 5** AV/FV:
Toggles between Aperture Mode and Focus Mode
- 6** Live View:
Turns on and off Live View Function
- 7** Focus:
Initiates autofocus (same as pressing shutter button on camera partially) Camera must be set in Autofocus mode
- 8** Indicator Lights AV and FV:
Displays either Aperture Mode or Focus Mode

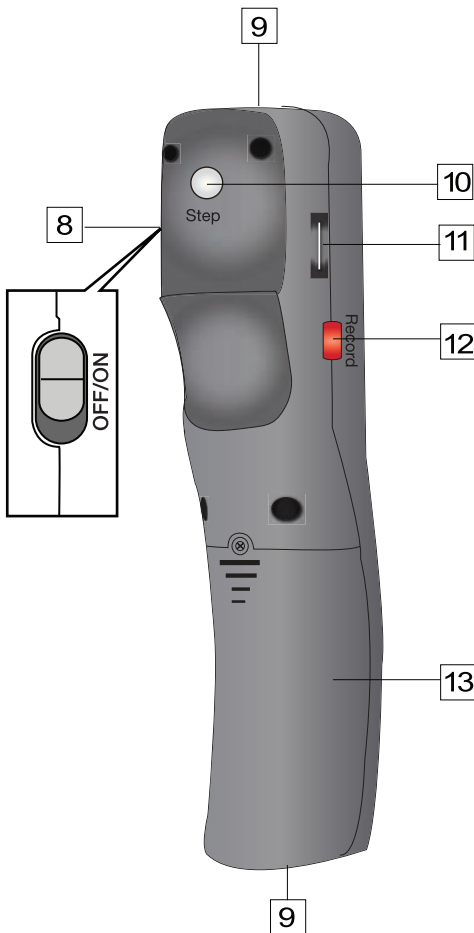

- 8 On/Off Button:**
Before turning on USB Control Grip, connect to camera with the included coiled USB Cable. First power on the camera, then power on the USB Control Grip. To power off, slide to the off position.
- 9 Mounting Socket:**
¼"-20 Sockets for mounting on top and bottom
- 10 Step:**
Default setting is Step 2 or medium step increments. Press Step Button once for Step 3 or fast focus speed. Press Step Button once more for Step 1 or slow. The LED indicators on the top of the grip display step speed being used when focusing. (Please read explanation of USB focus characteristics on page 11 and page 12.)
- 11 USB Connector:**
USB Type A port on grip connects to mini type A on DSLR with the included coiled cable
- 12 Record:**
Starts video record function – press once to start recording, hold button for ½ second or longer to stop recording
- 13 Battery Cover:**
The battery compartment door requires a small Phillips screwdriver to loosen the safety screw that prevents accidental opening of the battery compartment during usage.

> Power Requirements

The USB Control Grip requires 3V and has an operating current of less than 40MA.

For best results use matched Alkaline batteries - Never leave batteries installed for extended periods of time.

> Automatic Shutdown Function

To conserve battery power, the USB Control Grip will automatically shut down after 30 minutes of inactivity. If automatic shutdown is activated, first slide to the Power Switch to the off position then back to the ON to resume normal usage.

> Low Battery Alert

When battery power dips below 2.2VDC, the LED Indicator 1 on the top of the unit will flash twice per second. When you see this alert, it is time to replace the batteries.

> Battery Installation

1. Loosen the safety screw with a Phillips screwdriver
2. Open the battery cover in the opposite direction of the arrow.
3. Insert the batteries according to the + and - symbols as shown in the battery compartment.
4. Close the battery cover in the direction of the arrow.

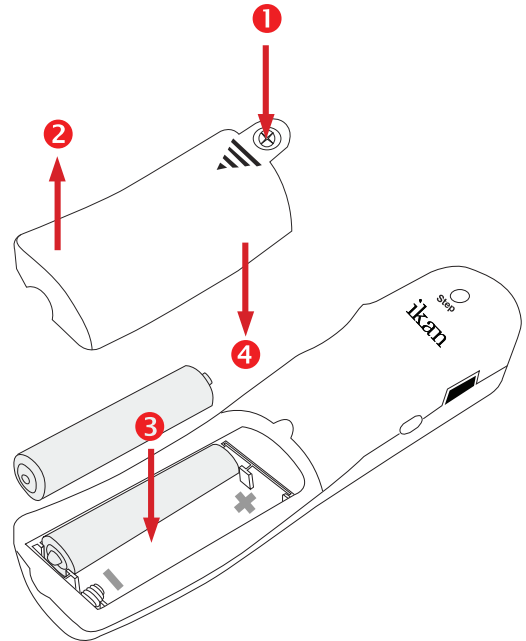

› Notes of Usage

Make sure the focus command send rate is not too fast. Changing the command send rate, focus step size, or focal length can affect accuracy. Some lenses have slightly different increments if the focus moves from near to infinity versus infinity to near. Not all focus points will be accurate regardless of USB Control Grip usage. This is a limitation of specific lenses.

Focus occasionally pauses or moves unevenly. Make sure the focus command send rate is not too fast for the specific combination of lens, focus step size, and focal length. If the command send rate is too fast, some focus commands are dropped because the camera is busy executing the previous command. This gap before the next command is received causes the focus to move unevenly. You should keep the focus command send rate between 4 and 6 commands per second.

› Focus Step Size

Canon's USB implementation allows for three different step sizes when sending a focus command to the camera. The Step Button on the rear of the grip cycles through the three different sizes. The LED Indicators 1, 2, or 3 will show on the top of the grip to indicate small, medium and large step sizes. The bigger the focus step, the quicker the focus moves.

When you first turn on the USB Control Grip – Step Size Default is set to 2. After first usage, the last step size used before powering off will be retained (pending battery capacity)

> Safety Notice

To prevent damage to your product or injury to yourself or to others, read the following safety precautions in their entirety before using this equipment.

Keep these safety instructions where all those who use this equipment will read them.

Observe precaution when handling batteries

Do not expose to high temperatures

Do not leave the device in a closed vehicle under the sun or in other areas subject to extremely high temperatures.

Failure to observe this precaution could result in fire or in damage to the casing or internal parts.

Keep out of reach of children

This device contains small parts which may pose a choking hazard.

Consult a physician immediately if a child swallows any part of this device.

Keep dry

Do not disassemble or modify

Failure to observe this precaution could result in electric shock or product malfunction. Should the product break open as the result of a fall or other accident, remove the batteries.

Do not handle with wet hands or immerse in or expose to water or rain.

Failure to observe this precaution could result in fire or electric shock.

Do not use in the presence of flammable gas. Failure to observe this precaution could result in explosion or fire. Use only batteries listed in this manual. Do not mix old and new batteries or batteries of different types.

Do not short or disassemble.

Do not attempt to insert batteries upside down or backwards.

Batteries are prone to leakage when fully discharged. To avoid damage to the product, be sure to remove the batteries when leaving the product unattended for prolonged periods or when no charge remains.

Should liquid from the batteries come into contact with skin or clothing, rinse immediately with fresh water.