

Saga 7" High Bright4K HDMI/3G-SDI Monitor



### What's Included

- ❑ 1 x S7H Monitor
- ❑ 1 x Camera Shoe Mount
- ❑ 1 x Neoprene Sleeve
- ❑ 1 x Mini-XLR to P-TAP Cable
- ❑ 2 x Canon E6 Battery Plate

# ikan

[www.ikancorp.com](http://www.ikancorp.com)

[support@ikancorp.com](mailto:support@ikancorp.com)

713.272.8822

© 2015 ikan Corporation. All rights Reserved

# Getting Started

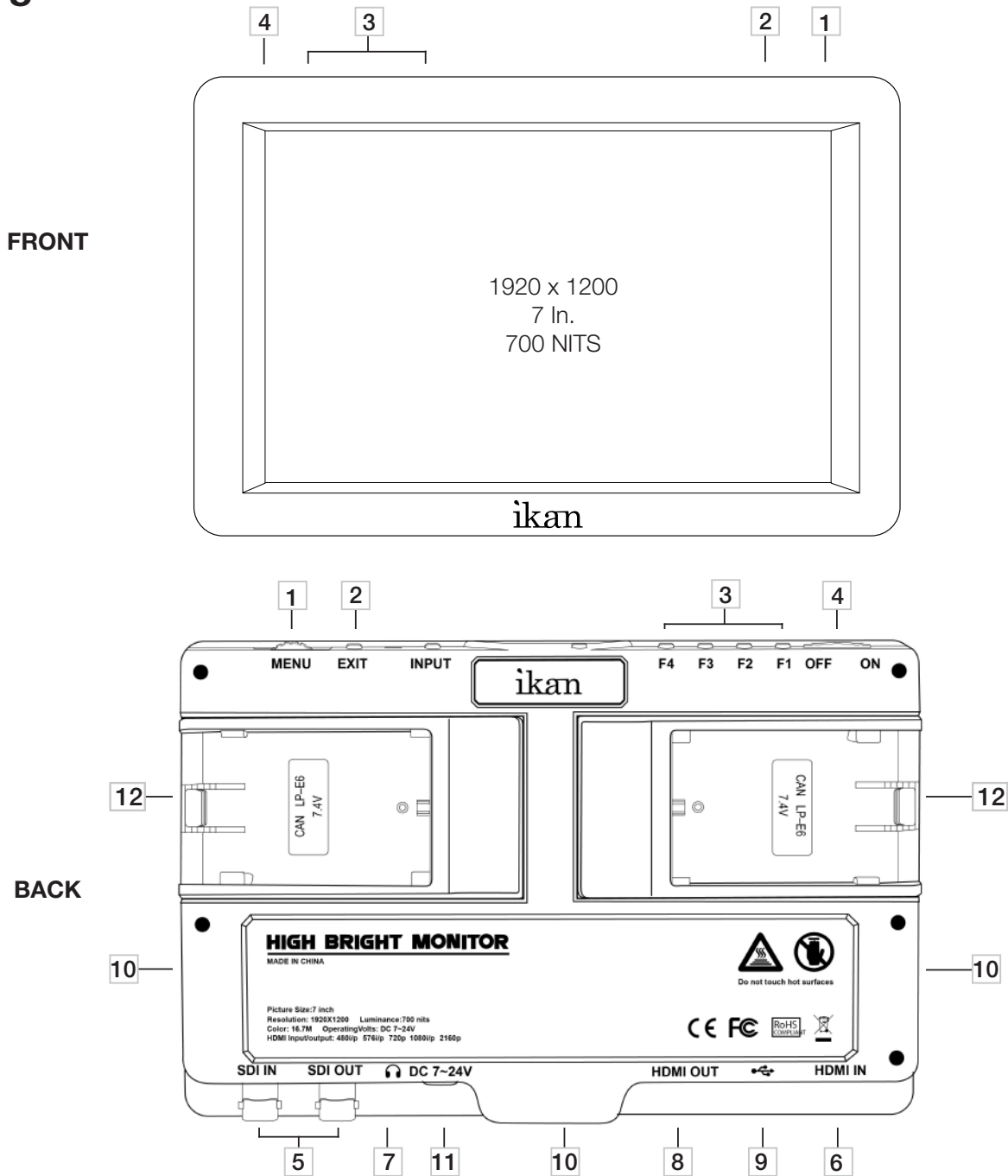

- |  |   |
|--|---|
| <p><b>1</b> <b>Menu Button - Scroll Wheel</b><br/>Used to enter and navigate the menu.</p> <p><b>2</b> <b>Exit / Aspect</b><br/>Used to exit the menu.</p> <p><b>3</b> <b>Function Buttons</b><br/>Functions can be selected in the menu</p> <p><b>4</b> <b>Power Button</b><br/>Power ON/OFF</p> <p><b>5</b> <b>SDI Input/Output Terminal</b><br/>SDI Input/Output</p> <p><b>6</b> <b>HDMI Input Terminal</b></p> | <p><b>7</b> <b>3.5mm Headphone Output</b></p> <p><b>8</b> <b>HDMI Output Terminal</b></p> <p><b>9</b> <b>USB Connector</b><br/>Used for Software Updates</p> <p><b>10</b> <b>1/4"-20 Threaded Insert</b></p> <p><b>11</b> <b>DC 7-24V Power Terminal</b><br/>Mini-XLR Connection</p> <p><b>12</b> <b>DV Battery Plate Slot</b><br/>Used for mounting DV Battery plate</p> |
|--|---|

# Battery Plate Installation & Removal

## Installation

To Install battery plates line up holes under battery plate with tabs on battery plate slot. Then push towards center of the monitor.

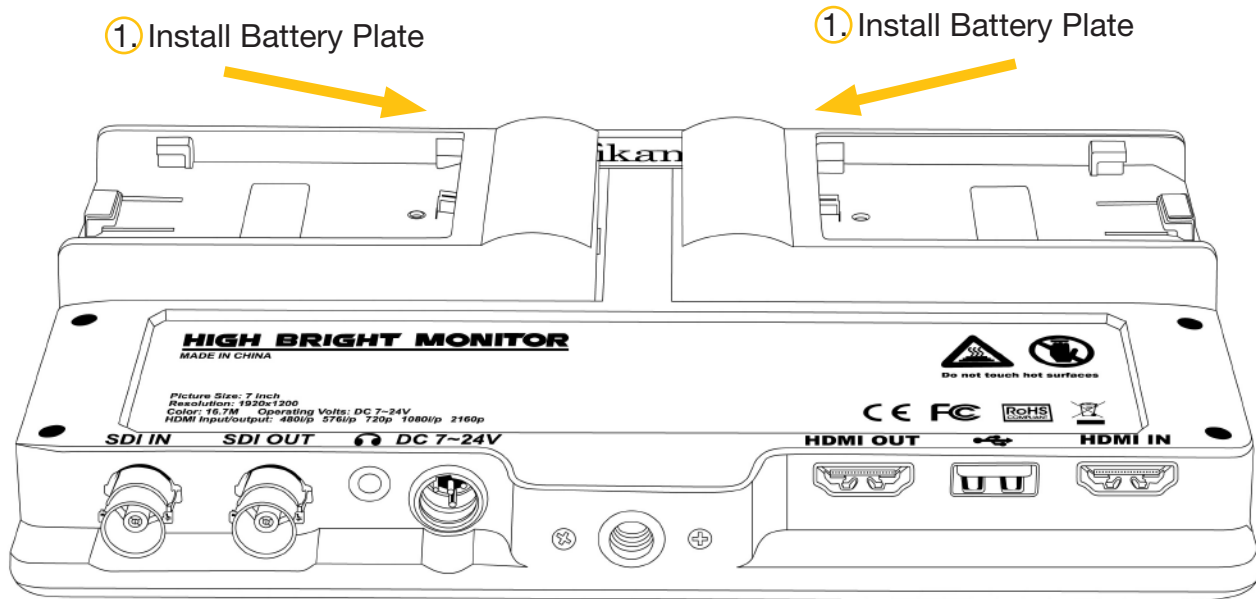

## Removal

To Remove your battery plate, simply push battery plates away from center of the monitor.

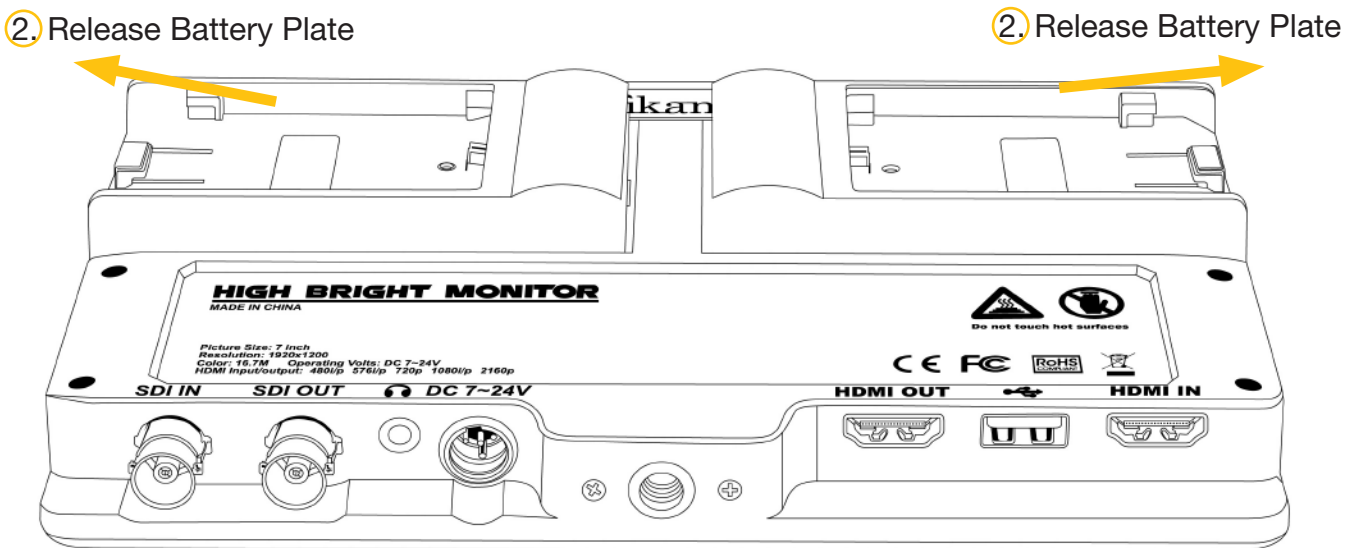

# Configuration of Setting Menus

- Guides** \_\_\_\_\_ Toggle between the following: 80%, 90%, 15:9, 4:3, 1.5:1, 2:1, 2.35:1
- Crosshair** \_\_\_\_\_ Activates Crosshair on center of screen.
- Grids** \_\_\_\_\_ Activates grid on the screen to assist with framing.
- Video Config** \_\_\_\_\_ Brightness: 0-100  
 Contrast: 0-100  
 Chroma: 0-100  
 Sharpness: 0-100  
 Tint: 0-100
- Color Temp** \_\_\_\_\_ 5600K, 6500K, 9300K, Manual
- Backlight** \_\_\_\_\_ Allows user to fine tune the intensity of the LCD Panel's backlight.
- Aspect** \_\_\_\_\_ Allows user to change the aspect ratio of the image.
- System Config** \_\_\_\_\_ OSD - **Language:** Choose between English & Chinese for OSD.  
 OSD - **Duration:** Choose how long the menu stays active without activity.  
 OSD - **Transparency:** Choose from low, medium, high, or off.  
 MENU Setup - Allows 5 users to save menu settings.  
 System Reset - Reset Settings to factory defaults.
- Flip Control** \_\_\_\_\_ Flip Image and/or Menu  
 Low Battery Alarm - Warns the user when battery is low.

## Function Set Up 1-8

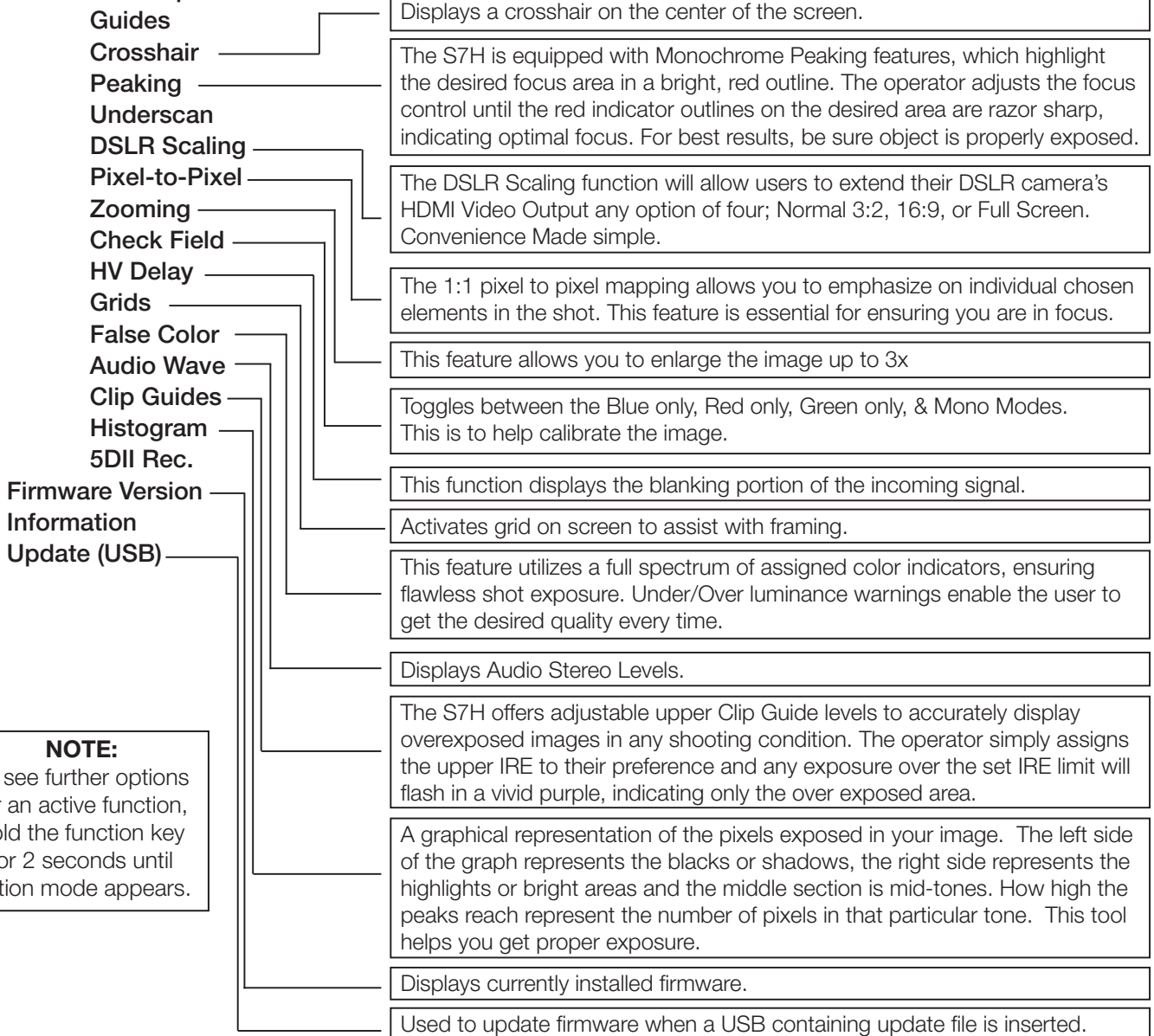

**NOTE:**  
 To see further options for an active function, hold the function key for 2 seconds until option mode appears.

# Specifications

Aspect Ratio	16 x 10
Backlight	LED
Brightness	700cd/m2
Build Material	Heavy Duty Plastic
Color Depth	16.7 Million
Color System	PAL/NTSC/SECAM (Auto-Detected)
Contrast Ratio	1200:1
Input Voltage	DC 7V-24V
Inputs	HDMI, 3G-SDI
Operating Temperature	0°C~50°C / 32°F~122°F
Outputs	HDMI

Pixel Pitch	0.07875 x 0.07875 mm
Power Consumption	6W
Resolution	1920 x 1200
Response Time	20ms
Screen Size	7 In.
Viewing Angle	178° horizontal / 178° vertical
Weight	0.5 lbs

# Supported Video Signals

<b>HDMI</b>	720x480i & 720x480p @ 59.94, 60 Hz
	720x576i @ 50 Hz
	1280x720p @ 23.97, 24, 25, 29.94, 30, 50, 59.94, 60 Hz
	1920x1080i @ 50, 59.94, 60 Hz
	1920x1080psf @ 24, 25, 29.97, 30 Hz
	1920x1080p @ 23.97, 24, 25, 29.94, 30, 50.94, 60 Hz
	3840x2160p @ 24, 25, 30 Hz

# Optional Accessories

## MOUNTS

MA207	7 In. Articulating Arm
MA211	11 In. Articulating Arm
MA211-R	11 In. Articulating Arm w/ Single Rod Mount

## BATTERY PLATES

BP5-C	Canon 900 Battery Plate
BP5-E6	Canon LP-E6+ Battery Plate
BP5-P	Panasonic D54 Battery
BP5-S	Sony L Series Battery Plate
BP5-N	Nikon EN-EL15 Battery Plate
BP5-PG6	Panasonic G6 Battery Plate
BP5-SU	Sony BP-U Series Battery Plate

## Learn More

More dynamic information at official website: [www.ikancorp.com](http://www.ikancorp.com)

## Support

Contact email: [support@ikancorp.com](mailto:support@ikancorp.com)

### CONDITIONS OF WARRANTY SERVICE

- Free service for one year from the day of purchase if the problem is caused by manufacturing errors.
- The components and maintenance service fee will be charged if the warranty period is expired.

Free Service will not be Provided in the Following Situations:(\*Even if the product is still within the warranty period.)

- Damage caused by abuse or misuse, dismantling, or changes to the product not made by the company.
- Damage caused by natural disaster, abnormal voltage, and environmental factors, etc.