

# IFD576-KIT-2PT-CH

Kit with 2 x IFD576 LED Studio Lights & Chimera Soft Boxes

## QUICK START GUIDE



### What's Included

- 2 x IFD576 Light
- 2 x Gold Mount Battery Plate (*attached*)
- 2 x Gold to V-Mount Adapter Plate
- 2 x Diffuser
- 2 x HD Stand
- 2 x Remote Control
- 1 x Light Bag
- 1 x Stand Bag
- 2 x Chimera Soft Box

<b>CHECKED BY</b>

# ikan

[www.ikancorp.com](http://www.ikancorp.com)

[support@ikancorp.com](mailto:support@ikancorp.com)

713.272.8822

© 2015 ikan Corporation. All rights Reserved

# IFD576-2PT-KIT-CH

## Getting Started

1. Connect the included AC Adapter to power the IFD576 light.
2. Turn the light on/off with the power switch.
3. Control the amount of light with the dimmer knob. Adjust the intensity of the light by turning the dimmer knob clock-wise to increase the intensity, and counter clock-wise to reduce it.
4. The IFD576 can also be powered by pro battery.

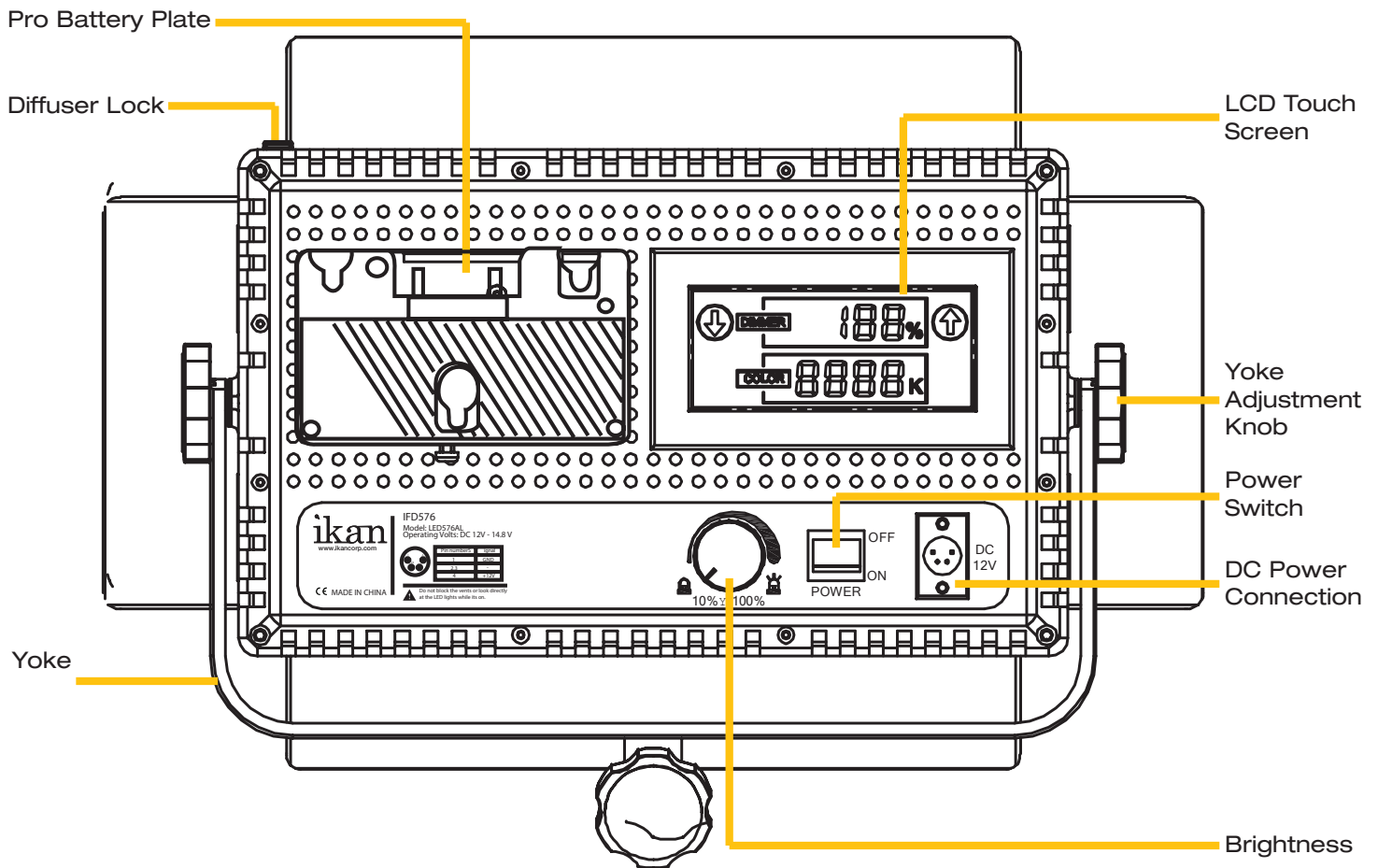

# IFD576-2PT-KIT-CH

## Specifications

Specs	
Beam Angle	60°
Build Material	Heavy Duty Plastic
Control	Local Knob Control & Touchscreen
Cooling System	Passive Cooling
Dimming	10-100%
Fixture Size	14 x 8.5 x 2.75 In.
Fixture Weight	4 lbs
Focusing	NO
Foot Candles	520.6
Head Type	Daylight 5600K
Lens	60°
Light Source	576 0.06watt LED @ 5600K
Mount	Yoke
Power Supply	12V @ 3.33A
Rating	120V @ 60Hz
Yoke	60°
Shipping Dimensions	18 x 18 x 22 In.
Shipping Weight	29 lbs

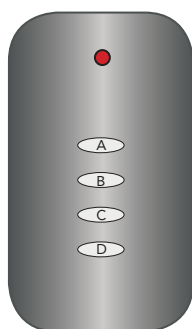

### Remote Control Button Functions

Press & hold "A" for 5 seconds to sync remote control to light.

Press "A" to power ON/OFF

Press "B" to adjust 4 levels of light intensity in increments of 25%

Press & hold "B" for 5 seconds to enable/disable sound

Hold down "C" to increase light intensity 0%-100%

Hold down "D" to decrease light intensity 100%-0%

# Connecting Gold-Mount to V-Mount

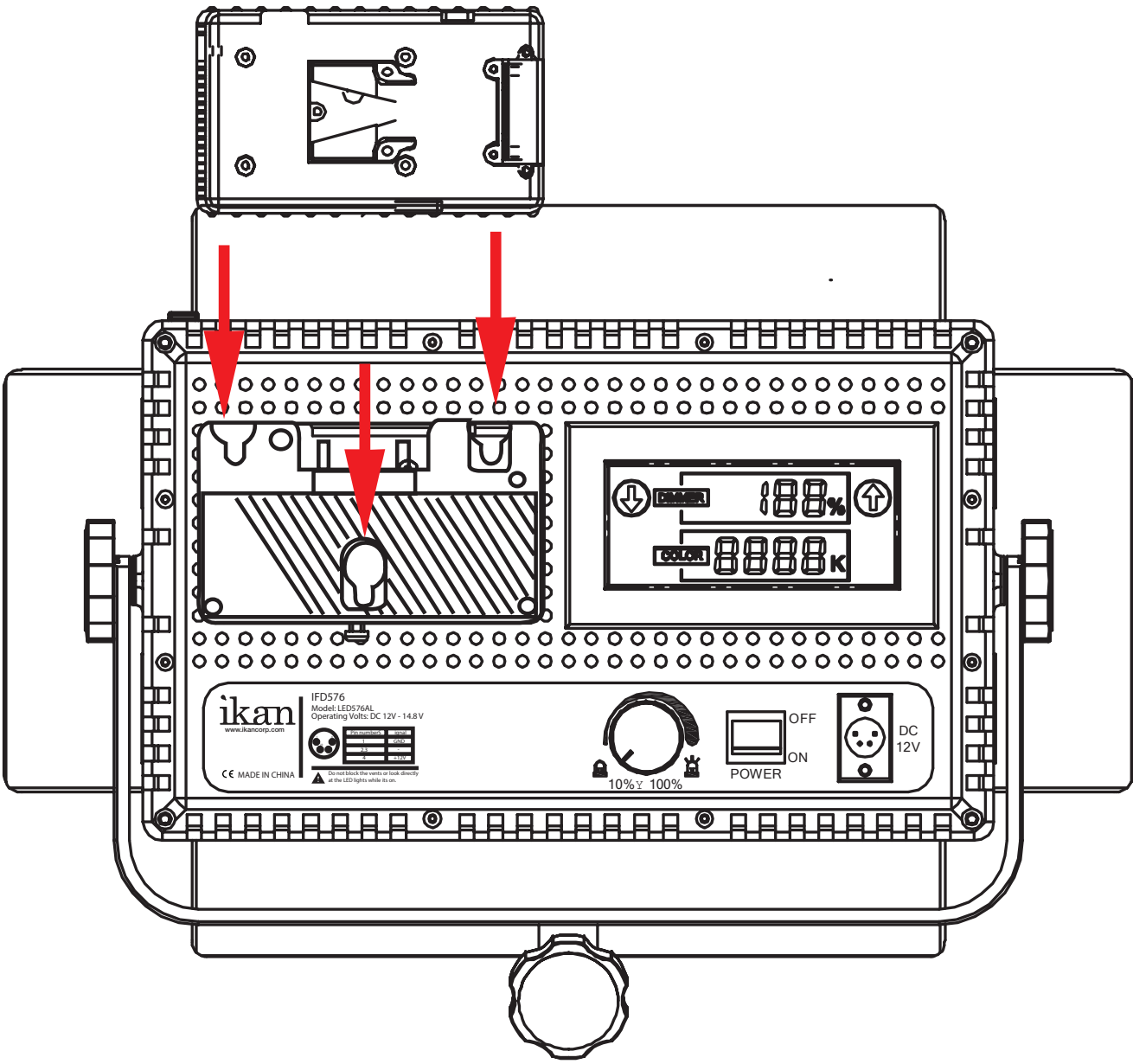

## Connecting Chimera Soft Boxes

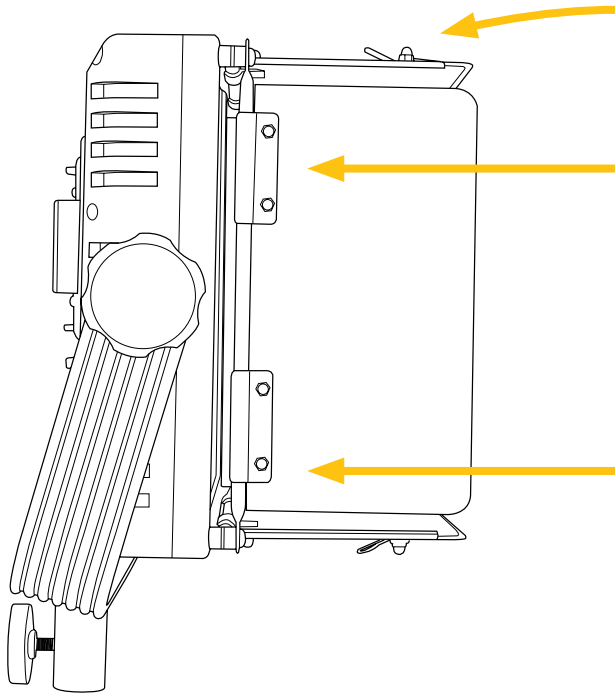

1. Chimera folding frame fits over the outer sides of the light and attach to the gel clips.

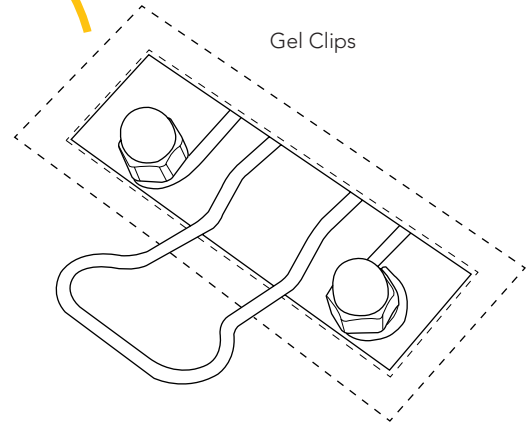

2. Chimera folding frame fits over the Gel Clips to hold the chimera on the face of the light.

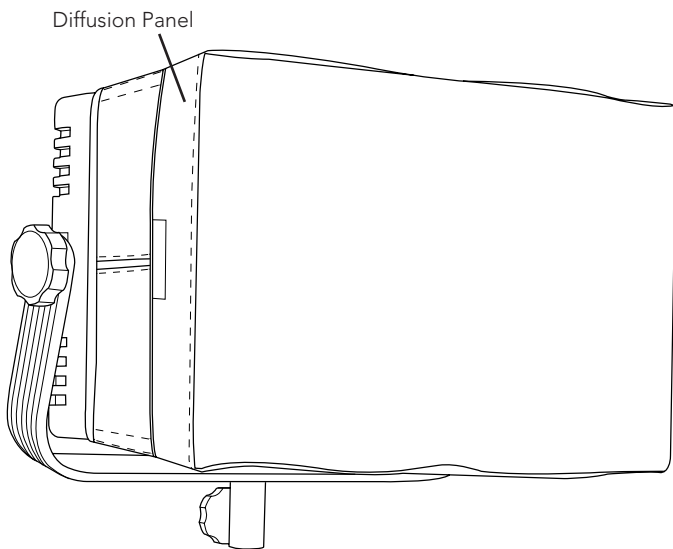

3. Once the outer frame is attached, the front diffusion panel can be placed on the light.

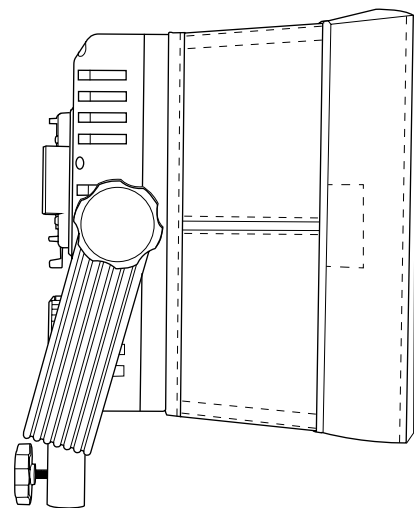

## Learn More

More dynamic information at official website: [www.ikancorp.com](http://www.ikancorp.com)

## Support

Contact email: [support@ikancorp.com](mailto:support@ikancorp.com)

### CONDITIONS OF WARRANTY SERVICE

- Free service for one year from the day of purchase if the problem is caused by manufacturing errors.
- The components and maintenance service fee will be charged if the warranty period is expired.

Free Service will not be Provided in the Following Situations:(\*Even if the product is still within the warranty period.)

- Damage caused by abuse or misuse, dismantling, or changes to the product not made by the company.
- Damage caused by natural disaster, abnormal voltage, and environmental factors, etc.