

Manual

HS-USB-MIC

ikan

USB Condenser Cardioid Microphone w/ Gain Control

HOMESTREAM™

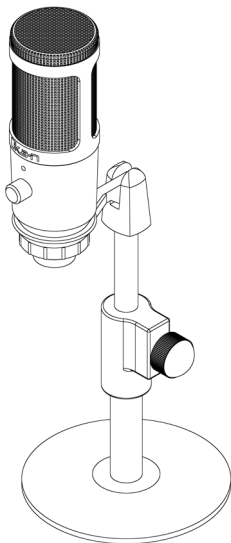

Condenser Microphone Specifications

- Sensitivity: $-32 \text{ dB} \pm 2 \text{ dB}$
- Output Impedance: Low Impedance($<680\Omega$)
- Directivity: Unidirectional
- Frequency Range:100Hz-18000Hz
- Operation Voltage Range: DC-5V
- Max. Operation Voltage: DC-5V
- S/N Ratio: $> 68\text{dB}$
- Current Consumption: $<0.5\text{mA}$
- Standard Operation Voltage: DC-5V
- Max. Input Sound Pressure Level: 115dB
- Decreasing Voltage Characteristic: Within 3dB at 1V

Condenser Microphone Specifications

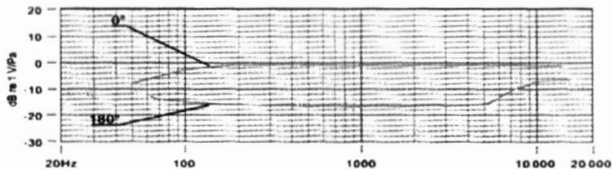

Polar Response

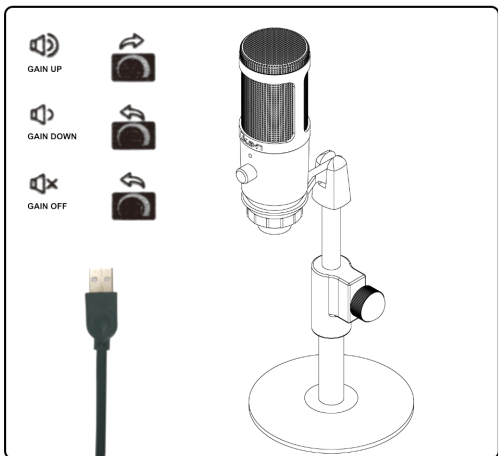
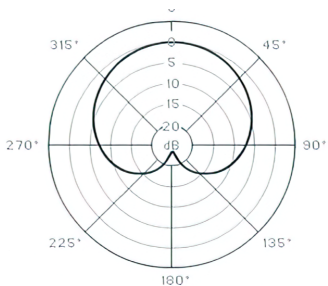

Power Requirements

1. The microphone is powered by your device's USB port, meaning that in most instances you can just plug the microphone in and get started right away. For non-standard USB ports, a powered USB hub may be required.
2. This is a "plug/play" USB device, compatible with both Windows and Mac computers.
3. An ideal starting point for the reference is to place MIC directly in front of the vocalist. 15 cm (6") distance. Moving the vocalist, a little closer will make the vocal sound more intimate and fuller, while moving the vocalist back will give the vocal a little more air or room sound, (you will hear increased bass or low frequency response when the sound source is very close to the mic).
4. Experimentation should be made with the angle from which the microphone is set, as different results can be achieved depending on the angle and distance of the microphone.

General Operation

To manually adjust your input level via your computer's system preferences, use the following instructions relevant to your device platform/operating system.

Microphone Setup

1. Plug one end of the USB cable into the USB port of the microphone and connect the other end to the computer. After connecting the audio cable, you can start using the microphone.
2. If you need to adjust the gain control, turn the knob on the front of the mic to the right.

Adjusting the input level on a Mac OS computer:

1. Click on the Apple symbol at the top left of your screen and select System Preferences.

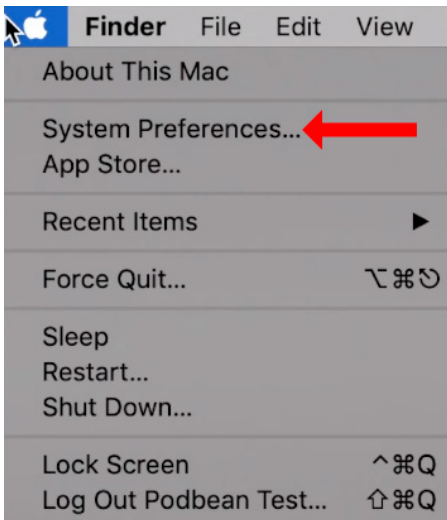

Accessing Mac OS System Preferences

2. Click on 'Sound' to open the sound options

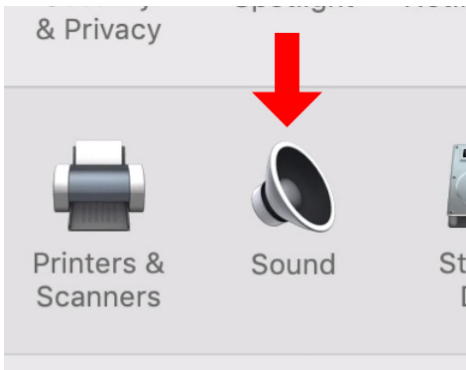

Opening 'Sound' Options

3. Open the 'Input' tab

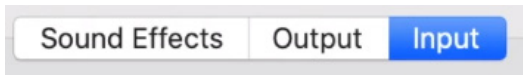

4. From here, select the 'USB AUDIO' from the list of devices, and adjust the input level using the slider.

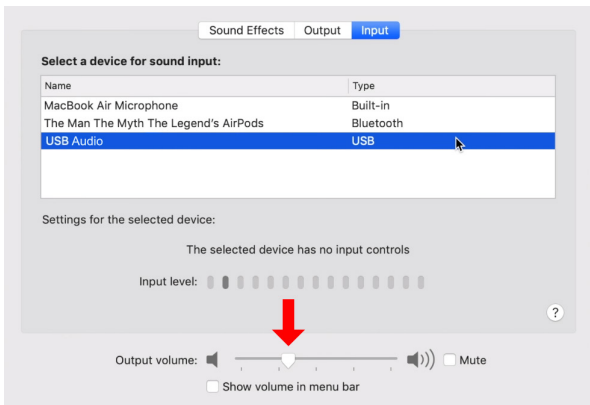

Adjusting Mic Input Level

Adjusting the input level on a Windows computer:

1. Open the Start menu and type 'Sound Settings'



Accessing Windows Control Panel

2. Once the "Sound Settings" section is highlighted, push enter to open the sound settings menu

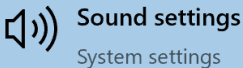

Opening 'Sound settings'

- Under the input, click the dropdown menu and make sure the 'USB AUDIO' device is selected from the list of devices.

The screenshot shows the Windows 'Sound' settings window. It is divided into two main sections: 'Output' and 'Input'. In the 'Output' section, the 'Choose your output device' dropdown is set to 'Digital Audio (S/PDIF) (High Definiti...'. Below this is a 'Master volume' slider set to 100. In the 'Input' section, the 'Choose your input device' dropdown is set to 'Microphone (2- Usb Audio Device)'. A prominent red arrow points to this dropdown menu. Below the dropdown is a 'Test your microphone' slider and a 'Troubleshoot' button. The overall layout is clean with a white background and blue accents.

Sound

Output

Choose your output device

Digital Audio (S/PDIF) (High Definiti... ▾

Certain apps may be set up to use different sound devices than the one selected here. Customize app volumes and devices in advanced sound options.

[Device properties](#)

Master volume

🔊 100

[Troubleshoot](#)

[Manage sound devices](#)

Input

Choose your input device

Microphone (2- Usb Audio Device) ▾

Certain apps may be set up to use different sound devices than the one selected here. Customize app volumes and devices in advanced sound options.

[Device properties](#)

Test your microphone

🔊

[Troubleshoot](#)

[Manage sound devices](#)

Selecting Input Device

4. To adjust the input level, click “Device properties” in the sound settings menu.

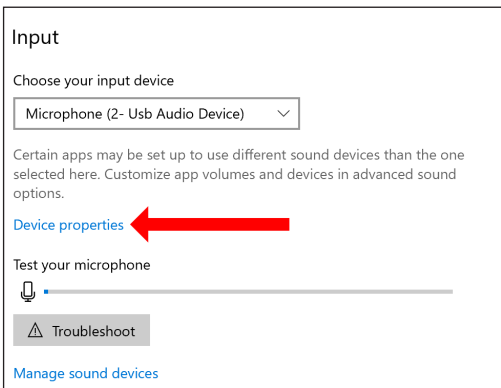

Adjusting Mic Input Level

5. Once the 'Device Properties' menu is open, you can adjust the Volume slider.

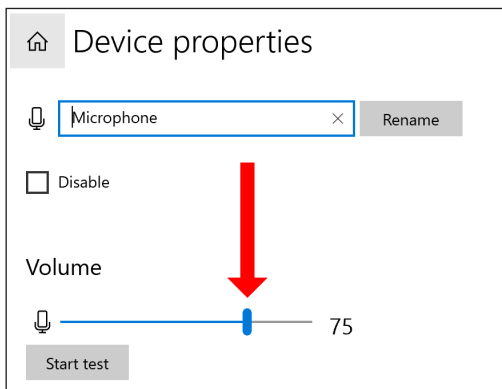

Adjusting Mic Input Level

Notes

1. Do not cover the microphone grille with your hand.
2. Regular maintenance is recommended to avoid electricity and acoustic problems.

Warranty

For warranty information, please visit the following link or scan the QR Code

<https://ikancorp.com/support/return-refund-policy/>



Support

Contact email: support@ikancorp.com

CONDITIONS OF WARRANTY SERVICE

- Free service for one year from the day of purchase if the problem is caused by manufacturing errors.
- The components and maintenance service fee will be charged if the warranty period is expired.

Free Service will not be Provided in the Following Situations:(*Even if the product is still within the warranty period.)

- Damage caused by abuse or misuse, dismantling, or changes to the product not made by the company.
- Damage caused by natural disaster, abnormal voltage, and environmental factors, etc.