



SUPPORT YOUR IMAGE

NINGBO EIMAGE STUDIO EQUIPMENT CO., LTD

Address: No.373 South Hangyong Rd,Luotuo Industry zone, Zhenhai,

Ningbo, China. 315202

Tel:86-0574-55681753,86-0574-55681675

Fax:0574-86590078

E-mail: sales@eimagevideo.com

Visit www.eimagevideo.com for more information



E-IMAGE
Official QR Code



E-IMAGE

V1.0
2019.07

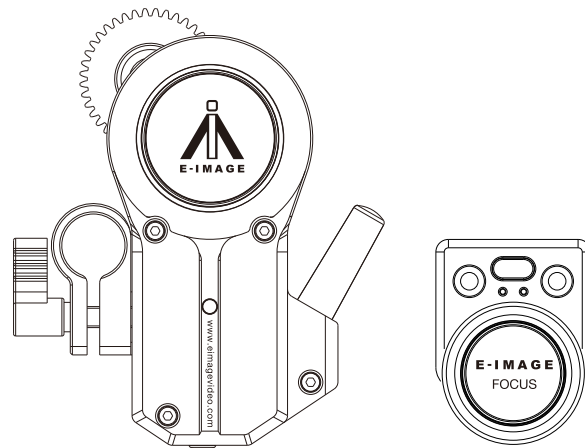

— www.eimagevideo.com —

Focus User Manual

Contents

Packing List	02
Assemble Manual	03
Focus Motor	08
Focus Controller	10
Route calibration & Start A-B operation	11
Specifications	12
Warranty Card	13

Packing List

The product package comes with the following items. In case that any item is found missing, please contact E-IMAGE or your local selling agent.

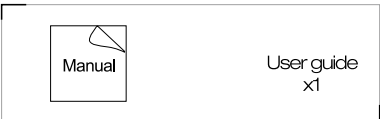
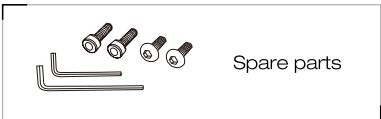
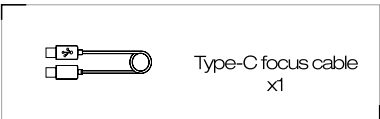
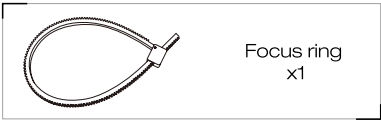
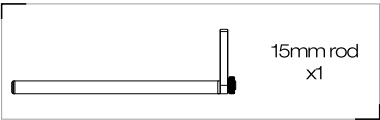

Assemble Manual

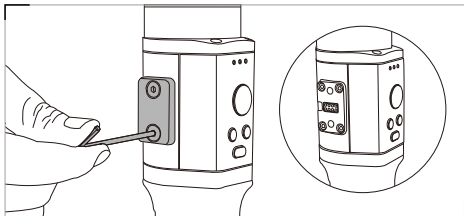

1. There are two 8-pin ports on each side of gimbal. The focus wheel can be mounted on both left side or right side by removing the 8-pin port cover first, according to user's operation habit. (Please note that other accessories from e-image also can be mounted to the 8-pin port. Please mount the cover back when the port is out of use.)

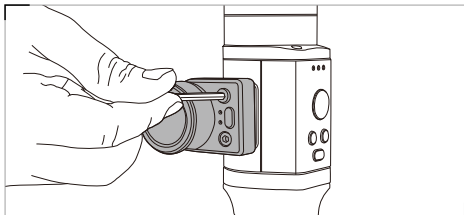

2. Use the accompanying big hexagon wrench to lock the focus wheel with the screws comes with the package. (Please ensure the assemble direction as the diagrams shows).

Assemble Manual

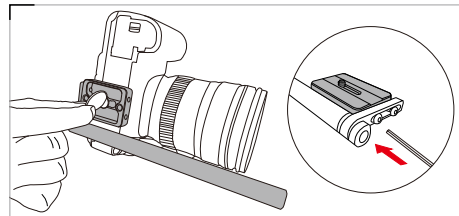

3. Use the accompanying small hexagon wrench and screws to connect the heighten plate with connection pole and then tighten the heighten plate onto the camera. (Please ensure the assemble direction as the diagrams shows).

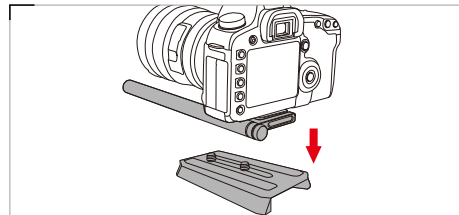

4. Attach the quick release plate to the components of step 3. (Ensure two screws both fixed.).

Assemble Manual

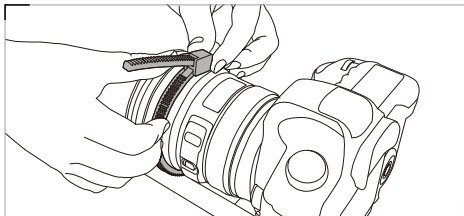

5. Assemble the focus ring to the camera lens tightly. (Please ensure the focus ring can drive the lens easily after right assembling).

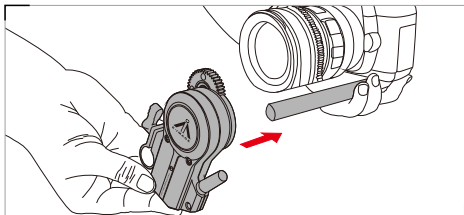

6. Attach the lens motor to the connection pole, and then adjust the position and make sure the focus gear against the lens ring teeth to teeth closely, and then tighten the locking knob.

Assemble Manual

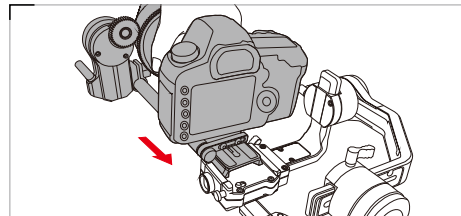

7. Assemble the components of step 6 to Horizon One gimbal.

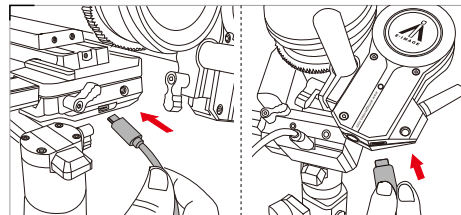

8. Use the accompanying type-c cable, one end connection with focus motor, the other end connect with type-c port on the quick release base of Horizon One. Then adjust the whole gimbal in full balance.

Assemble Manual

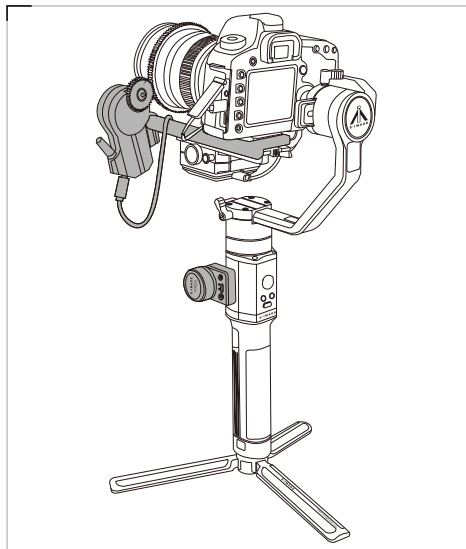

9. Ready to go .

Focus Motor

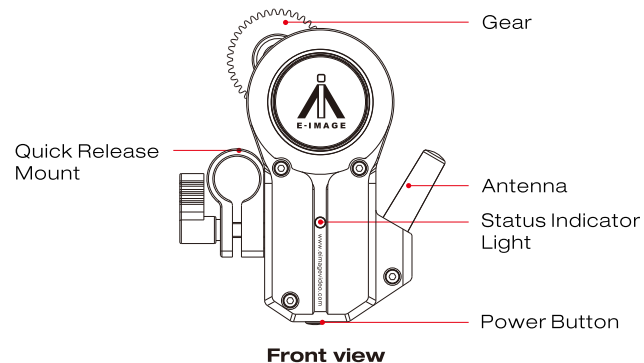

Power On

- Press and hold for 1 second, and release after the indicator turns green (normal power-on).
- If red light flashes quickly, it indicates firmware errors, and needs to re-up grade firmware.

Charging the Batteries

- Solid blue light indicates in the charging, and light turns off when the charging is completed.

Battery level

- Green light : 60%-100%
- Blue light : 30%-59%
- Red light : 0%-29%

Focus Motor

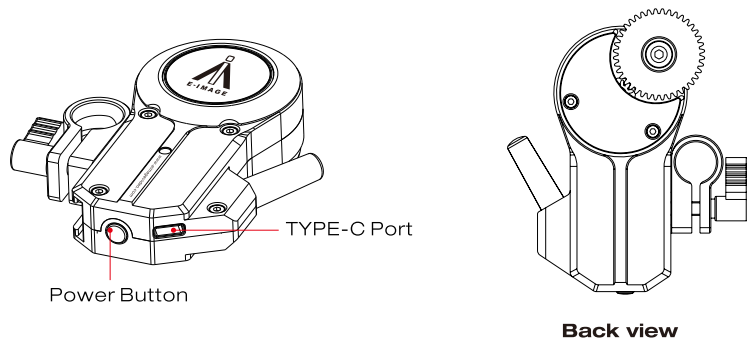

Upgrades

1. Please download the "E-IMAGE Assistant-Gimbal" application at first.
2. Please connect the focus motor with computer by the Type-C to USB cable (it is included in the gimbal packing).
3. Long press the focus motor button until the light turns to bright color.
4. Then follow the instruction step by step.

Focus Controller

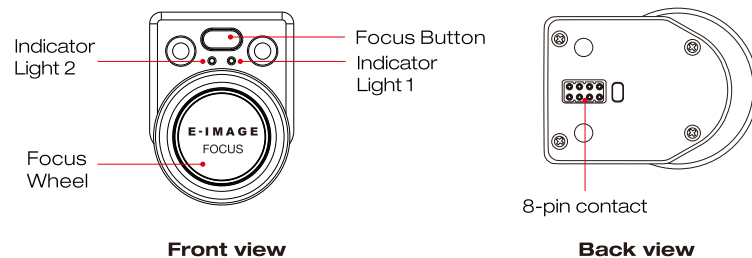

Indicator Light 1

Light off	Connect failed.
Single blinking	Connect with motor successfully, no route calibration.
Double blinking	Route calibration ^① is settled.

Indicator Light 2

Light off	A-B point ^② is not settled.
Single blinking	Start A point is settled
Double blinking	End B point is settled.

① (Route calibration: the upper and lower travel limits of the focus, like Limit A-B).

② (Start A-B point: your desired upper and lower travel distance of the focus).

Manual-Hand route calibration setting (Limit A-B)

- 1.Double press focus controller button, the Motor LED light blinks quickly.
2. Set Limit A: Hold the focus lens and rotate it in one direction, until it reach the upper limit A ,then rotate it slightly in opposite direction.
3. Set Limit B: Hold the camera focus and rotate it in the other direction, until it reach the lower limit B, then rotate it slightly in opposite direction.
4. Calibration is completed, the motor indicator light blinks normally, the indicate light 1 blinks in twice.

Start A-B point setting

(Note: please make sure the limit A-B is setted in advance).

1. Set Start A: Turn the focus wheel to rotate the focus to your desired upper start point A and single press the focus button.
2. Set End B: Turn the focus wheel to rotate the focus to your desired lower point B and single press the focus button.
3. Start A-B is setted successfully. The indicate light 2 blinks in twice.
4. Cancel start A-B: single press the focus button.

Specifications

General	
Operating Frequency	2.4G
Max Transmission Distance	100m(Outdoors and unobstructed)
Operating Temperature	-20°C ~ 55°C
Motor	
Weight	200g
Dimensions	90x30x105mm
Max. Torque	0.18Nm
Operating Current	Free current: 35mA(@7.4V) Stall current : 3A(@7.4V)
Operating Voltage	7.4V
Noise	<25dB
Rod Clamp Inner Diameter	15mm
Gear	0.8 Mod, 40 Teeth
Controller	
Weight	80g
Dimensions	35x30x45mm
Battery	LiPo7.4V, 300mAh

Warranty Card

Warranty period Statement:

1. Customers are entitled to replacement or free repair service in case of quality defects found in the product within 7 days upon receipt of the product.
2. Customers are entitled to free repair service for any product proven defective in material or workmanship that results in product failure during normal consumer usage and conditions within one year from the date of purchase.

This warranty does not apply to the following:

1. Products subjected to unauthorized repair, misuse, collision, neglect, mishandling, soaking, accident, and unauthorized alteration.
2. Products subjected to improper use or whose labels or security tags have been torn off or altered.
3. Products whose warranty has expired.
4. Products damaged due to force majeure, such as fire, flood, lightning.

To obtain the warranty service, please follow these steps:

1. If failure or any problem occurs to your product after purchase, please contact a local agent for assistance. If there is no local agent, you can always contact our customer service through email or website.
2. Your local agent or customer service will guide you through the whole service procedure regarding any product issue or problem you have encountered.
3. EIMAGE reserves the right to reexamine damaged or returned products.

Customer Information

Customer Name	Contact No.
Address	

Sales Manager

Sales Date	Dealer
Dealer Contact No.	

#1 Maintenance Record

Service Date	Signature of Repairman
Cause of Problem	
Service Result:	<input type="checkbox"/> Solved <input type="checkbox"/> Unsolved <input type="checkbox"/> Refunded/ Replaced

* Contents are subject to change without prior notice, you can download the latest version from www.eimagevideo.com.

If you have any questions about this document, please contact E-IMAGE by sending a message to sales@eimagevideo.com