

CB6

ikan

Canvas Bi-Color 2800K-6500K Round Bendable LED Panel



What's Included

- 1 x CB6 Bi-color Round LED Panel Light
- 1 x 5/8" Baby Pin with 90 degree Mount Holes
- 1 x Controller box
- 1 x Egg Crate
- 1 x Hanging Strap
- 1 x Power Cord
- 1 x Power Supply
- 1 x Soft Box
- 1 x Soft ½ stop round cover
- 1 x X-Holder with Ball Mount

Getting Started

Thank you for buying the CB6 Canvas Round Bendable Panel Light from Ikan. Please carefully read the instructions and guide before operating the products. The guide includes product usage and maintenance. When you operate the product, please make sure that you have read the instructions carefully. All the content of the manual is based on up-to-date information; technical data subject to change without notice.

Safety Instructions

1. Connect the AC power cable to the controller box before plugging into the power source. You risk electrocution by not following this instruction.
2. Don't drag cables with excessive force. Any repairs on the products should be performed by Ikan technicians. Users should not remove the power supply, or substitute a different power supply. This might damage the unit and will not be covered under warranty.
3. Be sure that the power is off before connecting and changing the fixture head or disconnecting your cable from the power source. We recommend using Ikan connecting cables and connectors to avoid electrical shock.
4. The voltage shouldn't exceed the value in the technical specifications. If the voltage is greater than, or less than the regulated values, it could damage the product.

Overview

The care and cleaning of the Canvas Round Bendable LED light. The CB6 should be placed back into the carrying bag when not in use. The LEDs should be facing out when placed into the carrying bag.



If the LED's should get dirty or covered in dust the unit can be cleaned with mild soap and water on a damp cloth.

DO NOT SUBMERGE THE UNIT IN WATER

Connecting the 4 prong cable between the controller box and the panel light.

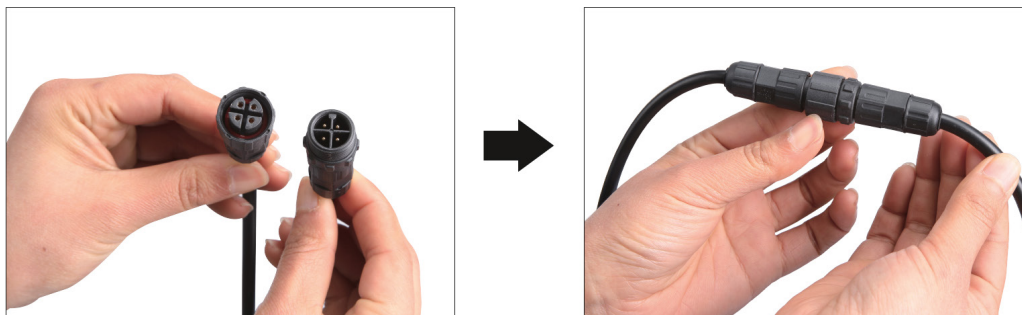

Align the male and female plugs so they line up and screw together until the cable is tight.

Color & Brightness

Color temperatures for today's film and TV production are 5600K (daylight) and 3200K (tungsten). Ikan developed the CB6 Bendable Light to handle both these temperatures. With patented technologies, the CB6 offers a professional and customizable LED light source. In addition, the light features cooling flex system for optimizing heat dissipation. Specifically, the CB6 offers the following features:

1. The 0-100% brightness incremental adjustment of the 2800K-6500K temperature enable fine-tuning your color range.
2. A panel of 326 Bi-color led light gives out 90FC of light.
3. Ultra-low noise and active cooling technology contribute to excellent thermal stability.
4. The bright LCD readout is easy to view, enabling smooth adjustment of functions.
5. Digitally adjustable knob allows you to adjust menu settings quickly and accurately.
6. AC/DC power control box allows the light to be powered by battery or DC power supply.
7. The softbox with grid cloth and 50 degree egg crate is included with the light.

Installation of the X-Holder with ball mount

The X-holder should be loose before inserting the struts into the hook & loop corners.

1. Place the struts into the hook & loop flaps at the corners of the panel.
2. Place them in opposite of each other for them to stay in place.
3. Tighten the tension knob at the center to keep the struts locked in place.



Note: To avoid damage to the LED's, place the panel light LED side down on soft material.

When placing the light mount on the 5/8" baby pin, this allows you to adjust the light in any desirable position.



Appearance & Structure

CB6 is illustrated as follows

5/8 Receiver: attaches to a stand or a 5/8" baby pin w/ 90 degree holes

Mount: Adjustable lighting direction

Hook & Loop around the edge of the light



Cover Installation

1/2-stop Round Cover



Soft Box Installation

Soft Box & Egg Crate

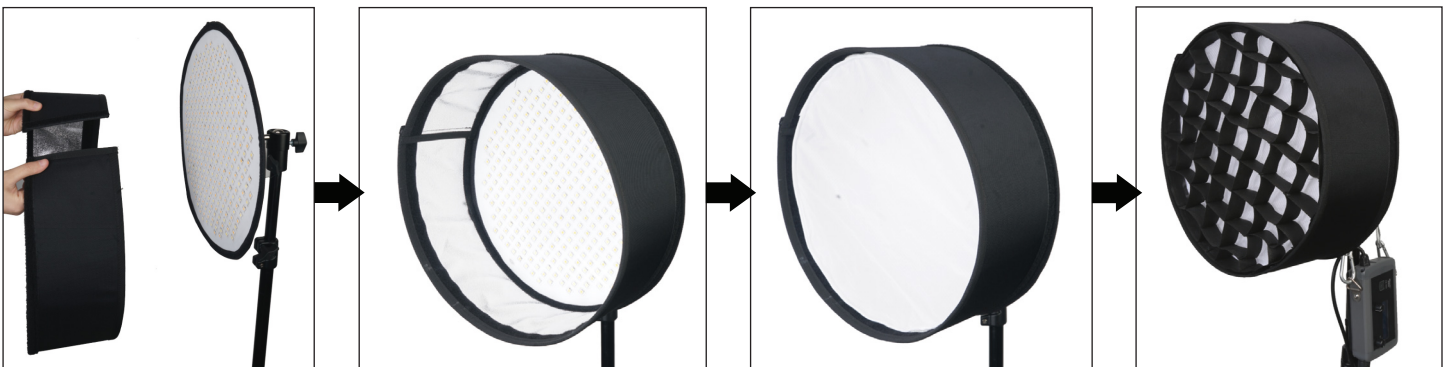

What's in the box?

Please carry and place the packing box carefully. Check the lighting equipment and accessories upon opening the box. Please contact us if anything is damaged or missing. Please save the packing materials for replacing and repairing the products in the future.

Method for Restoring the Soft Box Shape After Travel

The soft box applicator will be out of shape from flat packaging or travel. Using the following steps, the round shape can be restored. Roll the soft box into a cylinder about 4-6 inches in diameter. Secure this cylinder for 24 hours before use. This will allow it to retain it's round shape when applying.

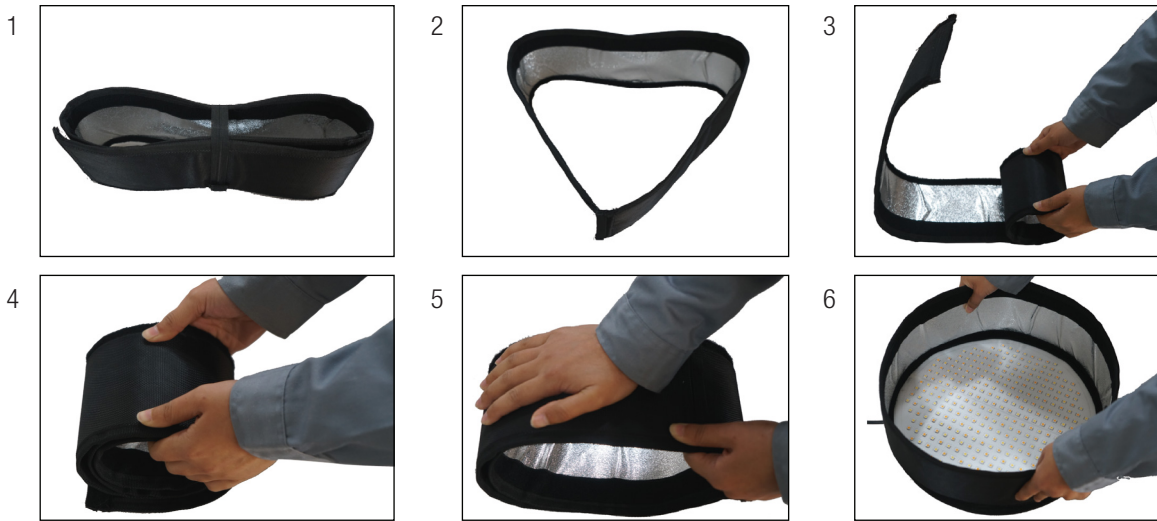

Appearance & Structure - Control Box

Power switch: Turn on/turn off power

AC 110-220V Power Connector: Connecting with 110-220V power cable

LED Display: Changing the brightness 0-100%, changing the color 2800K-6500K

Color Knob: Adjust the color from 2800K-6500K (press in on button to control the Warm white 0-100% and press brightness to control Cool white 0-100%)

Brightness Knob: Adjusts brightness from 0%-100%



- A. Battery Release Button
- B. Power on/off Switch
- C. Color Adjustment Knob
- D. Brightness Adjustment Knob
- E. LCD Display Screen

Screen Display Functions

Illustration of light's dimmer:

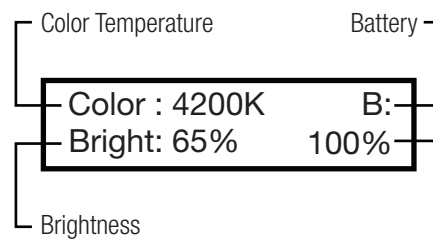

Installation & Power Supply

1. Ensure power is off before setting up light.
2. Place the light on the Ikan customized stands, release the tension knob on the 5/8" receiver, adjust the light in the desired direction, and then tighten the tension knob on the 5/8" receiver.
3. When connecting the power cords, plug the 4-pin XLR power cord into the controller box.

Notice & Maintenance

- The CB6 working temperature range must be regulated. Overheating will reduce the LED working life. Please allow adequate ventilation when using the Canvas light.
- Products must be placed on a stable, dry, flat surface. Avoid exposure to sunlight and operating in an environment with high humidity or extreme moisture levels.
- Don't beat, knock or shake the lighting equipment during the operation.
- If the CB6 isn't working normally, please contact the Ikan repair department. Please don't disassemble/re-assemble by yourself.
- Please place the CB6 in a cool and dry place when you don't use it for an extended period of time.

Troubleshooting

Failure	Failure Cause	Troubleshooting
Unit Won't Turn On	The power is connected incorrectly or the power switch is not turned on.	Turn on the light with the switch on the controller box. Make sure the unit is plugged into AC power.
During the operation lamp is out.	The unit may have malfunctioned. The unit's connecting cable may not be properly secured.	Try turning the control box off then on again. The cable can be disconnected and then reconnected.

Specifications

Light Source	326 x 1.0watt LEDs
Head Type	Bi-Color 3200K-5600K
Beam Angle	120 Degree
Control/Dimming	Knob Control
Build Material	Flexible Fabric Material
Cooling System	Passive Cooling
Mounting System	Baby 5/8" receiver
Fixture Size	14 in. diameter
Fixture Weight	1lb

Electrical Specifications

Power Supply Input	110-240VAC
Power Supply Output	15VDC
Fixture Power Consumption	24W; 7.4-14.8VDC



Optional Accessories

Some other products that work well with the CB6 available from Ikan include:

IBG-STND	Stand Bag
IBG-SB15	Saddle Sandbag & Weight Bag - 15 lb
CP-STND-V3	Compact Light Stand
HD-STND-V2	Heavy Duty Light Stand

Learn More

More dynamic information at official website: www.ikancorp.com

Support

Contact email: support@ikancorp.com

CONDITIONS OF WARRANTY SERVICE

- Free service for one year from the day of purchase if the problem is caused by manufacturing errors.
- The components and maintenance service fee will be charged if the warranty period is expired.

Free Service will not be Provided in the Following Situations:(*Even if the product is still within the warranty period.)

- Damage caused by abuse or misuse, dismantling, or changes to the product not made by the company.
- Damage caused by natural disaster, abnormal voltage, and environmental factors, etc.

©2018 ikan Corporation. All rights reserved

