

BZ500

500FT WIRELESS HDMI/SDI TRANSMISSION SYSTEM

PACKING LIST

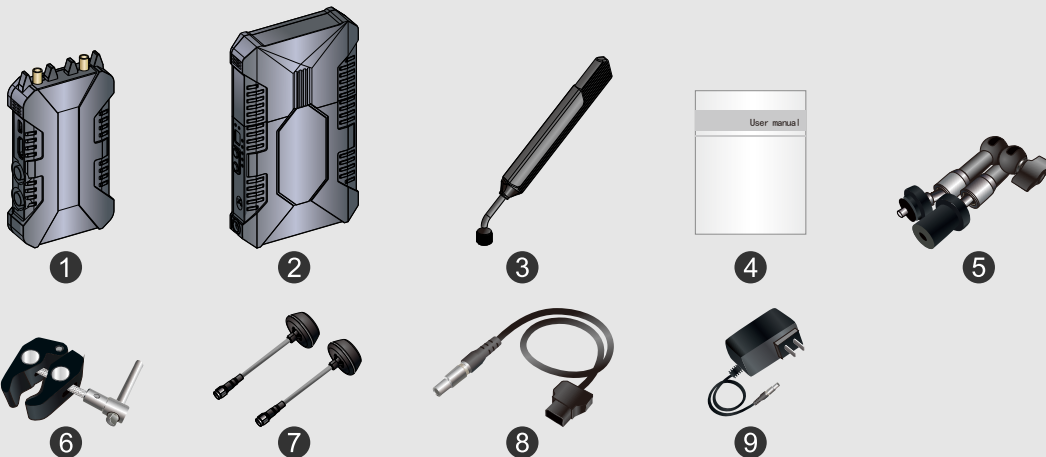

- 1 Transmitter x1
- 2 Receiver x1
- 3 5GHz Antennasx3
- 4 User Manual x1
- 5 Magic Armx1
- 6 Crab Clamp x1
- 7 Mushroom Antenna x 2
- 8 2PIN to D-Tap cables x2
- 9 Wall Plug x 1

* Please subject to actual shipment as the standard if any difference in accessories.

PARAMETERS

	Transmitter	Receiver
Interface	SD Input (BNC female) SD Loop Out (BNC female) 2 Antenna Port (RP-SMA female) DC Input, Mini USB 3.5mm Stereo In	SDI Output SDI 2 Output HDMI Output DC Input Mini USB
Supply Voltage Range	7–36V DC	7–36V DC
Power Consumption	<6W	<8W
Weight	210g	250g
Size	(L x W x H): 130.5*70.5*21mm, not include antennas and battery plate	(L x W x H): 161*93*23mm, not include antennas and battery plate
Input Video Format	HDMI: 480p60, 576p50, 720p50/59, 94/60, 1080i50/59, 94/60, 1080p23, 98/24/25/29, 9/30/50/59, 94/60; HDMI Type A SDI: 3G, HD, and SD-SDI (auto-selected), SMPTE-259/274/292/296/372/424/425; 1x BNC; 1x BNC Loopout;	/
Output Video Format	/	HDMI: 480p60, 576p50, 720p50/59, 94/60, 1080i50/59, 94/60, 1080p23, 98/24/25/29, 9/30/50/59, 94/60; HDMI Type A SDI: 3G, HD, and SD-SDI (auto-selected), SMPTE-259/274/292/296/372/424/425; 2x BNC output;
Input Audio	SDI embedded 2 channels 24 bit/48KHz	/
Output Audio	/	SDI embedded 2 channel 24bit/48KHz
Frequency Band	5.1–5.9GHz, configurable with China North America, Europe, etc	5.1–5.9GHz, configurable with China North America, Europe, etc
Modulation Mode	OFDM—16QAM	OFDM—16QAM
Transmission Power	Maximum 17dBm	/
Receiver Sensitivity	/	–75dBm
Occupied Bandwidth	20/40MHz	20/40MHz

INTRODUCTION

The wireless high-definition video transmission system, using today's highest level of wireless communication technology, transmits broadcast-quality uncompressed, non-delayed 3G SDI or HDMI1080P HD signals. Transmitter supports SDI, HDMI and SDI loop out; receiver support dual SDI output and HDMI output. Both transmitter and receiver working in broadcast mode, the transmission distance can reach 600ft.

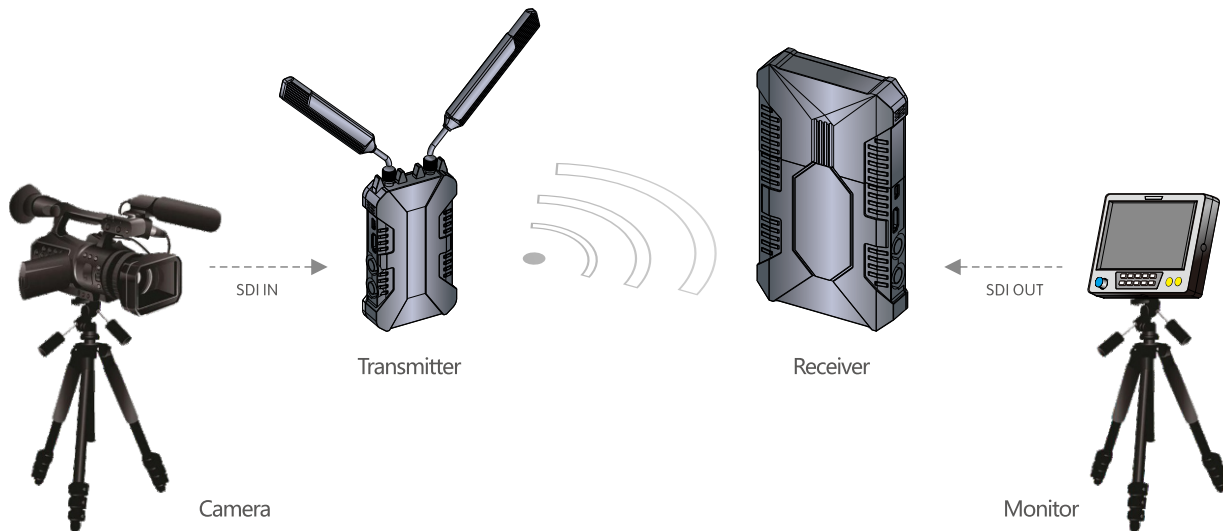

MUSHROOM ANTENNAS APPLICATION

When the height difference between the transmitter and the receiver is large, the mushroom antenna is recommended to enhance the stability of the wireless transmission.

Scene 1

The camera shoots at high altitude

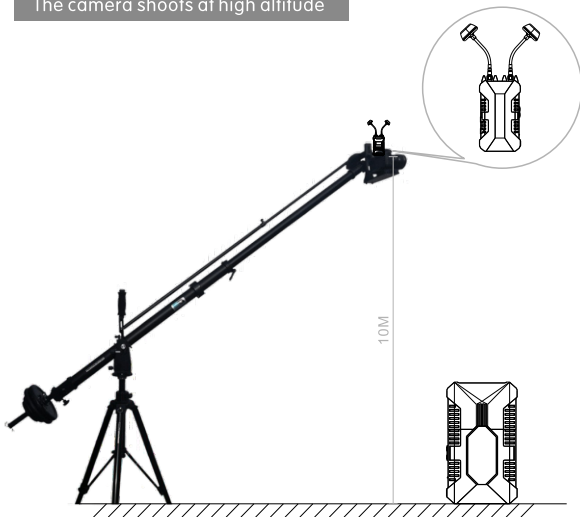

Scene 2

Camera close to the ground

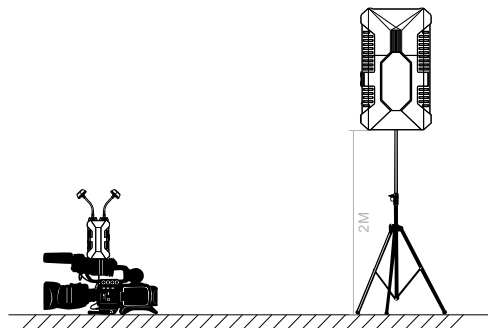

PRODUCT INTRODUCTION

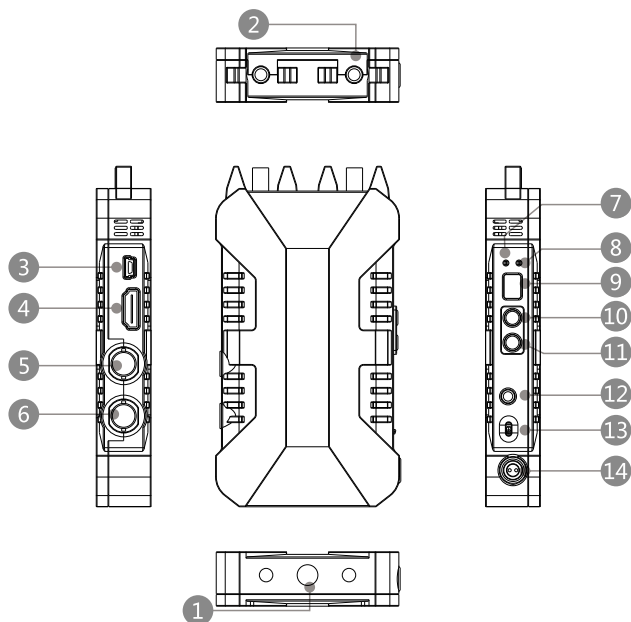

Transmitter

- ① 1/4-20 Screw hole
- ② Antenna Port (RP-SMA male)
- ③ Mini USB
- ④ HDMI Input
- ⑤ 3G SDI Loop Out
- ⑥ 3G SDI Input
- ⑦ Link Indicator
- ⑧ Video Indicator
- ⑨ Digital tube
- ⑩ Channel Selection Button
- ⑪ Frequency Adjustment and Confirm Button
- ⑫ 3.5mm Stereo In
- ⑬ Power Switch
- ⑭ DC Input

PRODUCT INTRODUCTION

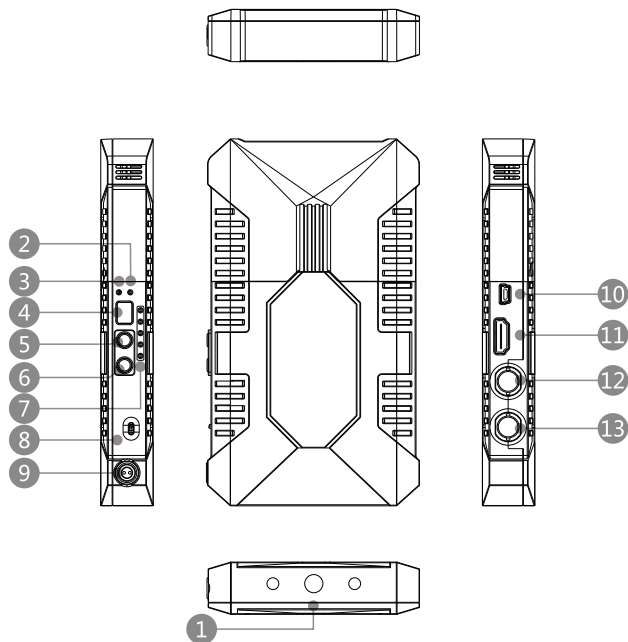

Receiver

- 1 1/4-20 Screw hole
- 2 Video Indicator
- 3 Link Indicator
- 4 Digital Tube
- 5 Channel Selection Button
- 6 Frequency Adjustment and Confirm Button
- 7 Signal Indicator
- 8 Power Switch
- 9 DC Input
- 10 Mini USB
- 11 HDMI Output
- 12 3G SDI Output1
- 13 3G SDI Output2

■ Installation details and cautions

Install the antennas

Stabilize transmitter and receiver

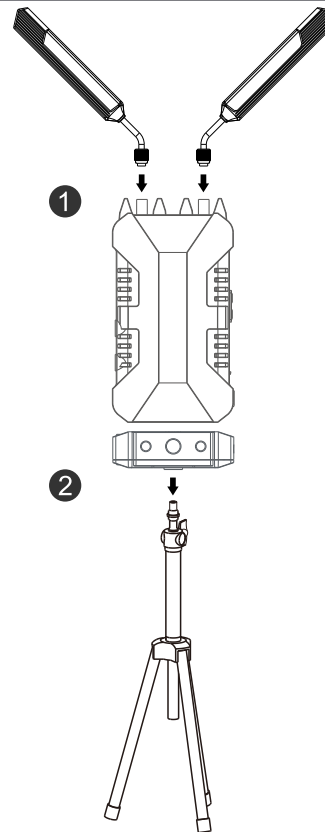

OPERATION INTRODUCTION

■ Installation details and cautions

Connect power supply

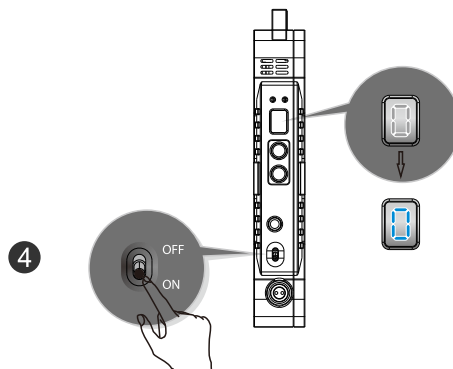
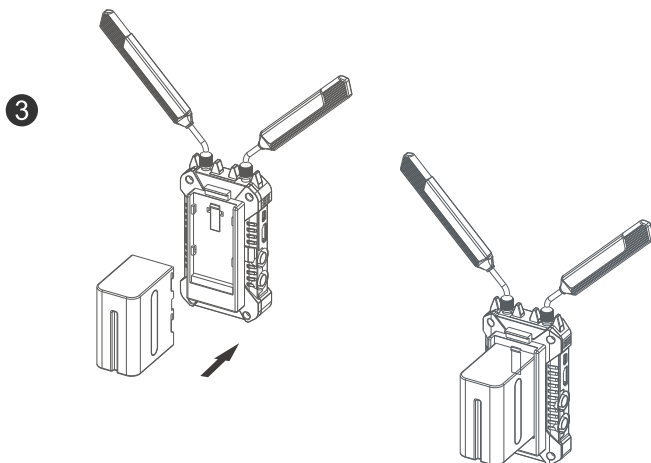

Turn on the switch

OPERATION INTRODUCTION

■ Installation details and cautions

Transmitter and Receiver should be set up in same channel

5

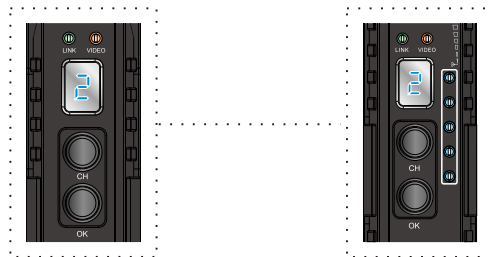

Build connection

6

Before connection



After connection



■ Installation details and cautions

When both SDI and HDMI have valid video input, the system will take SDI input as priority



HDMI signal

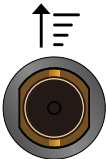

SDI signal

RSSI Indicators

Strong



Middle

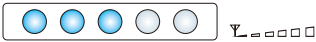

Weak

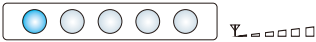

TROUBLE SHOOTING

1 No output on display

- a) Please check TX and RX power first. If power supply through battery or external power source, please make sure the battery or external power source works normally ;
- b) Check if TX antenna and RX antenna installed right and steady ;
- c) After that, check 'Video' indicator, if TX 'Video' indicator is not light, then check SDI or HDMI cable is plugged in and video source is ready please ;
- d) Finally check input video format is compatible with this product specs .

2 Poor output video quality

- a) Check if SDI or HDMI input or output cable is plugged well ;
- b) Make sure the transmitter and receiver are placed at least 1.5 meters above the ground ;
- c) Please check the wireless signal strength indicator "RSSI" status. There should be 2-3 RSSI LED lit if the user wants to get better video quality; if there is only 1 RSSI LED or no LED light, that means the received wireless signal is weak, and should decrease the transmission distance or try to change to other frequency channels in case some exist interference .

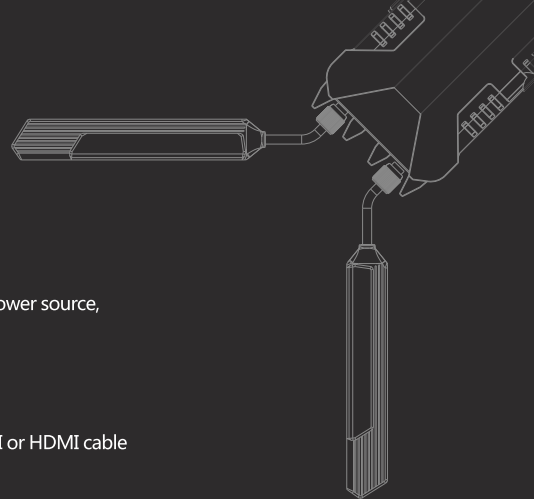

FCC STATEMENT

1, This device complies with Part 15 of the FCC Rules. Operation is subject to the following two conditions:

(1) This device may not cause harmful interference.

(2) This device must accept any interference received, including interference that may cause undesired operation.

2, Changes or modifications not expressly approved by the party responsible for compliance could void the user's authority to operate the equipment.

■ NOTE

This equipment has been tested and found to comply with the limits for a Class B digital device, pursuant to Part 15 of the FCC Rules. These limits are designed to provide reasonable protection against harmful interference in a residential installation.

This equipment generates uses and can radiate radio frequency energy and, if not installed and used in accordance with the instructions, may cause harmful interference to radio communications. However, there is no guarantee that interference will not occur in a particular installation. If this equipment does cause harmful interference to radio or television reception, which can be determined by turning the equipment off and on, the user is encouraged to try to correct the interference by one or more of the following measures:

Reorient or relocate the receiving antenna.

Increase the separation between the equipment and receiver.

Connect the equipment into an outlet on a circuit different from that to which the receiver is connected.

Consult the dealer or an experienced radio/TV technician for help.

■ RF WARNING STATEMENT

The device has been evaluated to meet general RF exposure requirement. The device can be used in portable exposure condition without restriction.

HEALTH AND SAFETY DISCLAIMER

This device complies with Part 15 of the FCC Rules. Operation is subject to the following two conditions:

(1) this device may not cause harmful interference, and (2) this device must accept any interference received, including interference that may cause undesired operation.

Please review FCC's Radio Frequency Safety before the operation at <https://www.fcc.gov/general/radio-frequency-safety-0>.

The following recommendations are made to help maintain RF safety in the Film and Television production environment:

1. All IKAN transmitters are certified for FCC Part 15 and comply with the following:
 - a. The transmitter has a legible FCC ID number on the manufacturer's product tag affixed to the unit.
 - b. The transmitter has not been modified in any way from its original state as delivered by the manufacturer.
 - c. All transmitter cabling is in good condition and properly attached.
2. The operator should have a clear understanding of the requirements for operating the equipment to maintain unconditional compliance with the MPE* (Maximum Permissible Exposure) limits for both controlled and uncontrolled environments.
3. The operator should review the FCC policy on human exposure to radio frequency on FCC's website: <https://www.fcc.gov/general/radio-frequency-safety-0>.
4. When the "unconditionally compliant" condition cannot be met, the operator should mitigate the exposure danger by observing the time limit for RFR exposure so as not to exceed the MPE*.

HEALTH AND SAFETY DISCLAIMER

5. When a wireless video transmitter is used that is not certified under FCC Part 15 and requires a Special Temporary Authorization (STA) from the FCC, the operator should understand the potential for RFR exposure and take precautions to not exceed the MPE* during the course of work. (Such equipment is typically used for long-range shots and uses high-powered transmitters and high-gain directional antennas.)

6. The operator should be aware of the RF environment to understand what other transmitters may contribute to the total exposure to RFR.

7. Cinematographers should receive specialized training regarding the identification and mitigation of RF Safety issues in the workplace.

By using this product, you hereby acknowledge that you have read this disclaimer and warnings carefully and that you understand and agree to abide by the terms and conditions herein. You agree that you are solely responsible for your own conduct while using this product, and for any consequences thereof. You agree to use this product only for purposes that are proper and in accordance with all applicable laws, rules, and regulations, and all terms, precautions, practices, policies and guidelines IKAN has made and may make available.

IKAN accepts no liability for damage, injury or any legal responsibility incurred directly or indirectly from the use of this product. The user shall observe safe and lawful practices including, but not limited to, those set forth in this document.

*This means that as long as a distance of at least 5 in. from the transmitting antenna is maintained, it is not possible to exceed the MPE limits set forth by the FCC.



Ikan International

11500 S. Sam Houston Pkwy West
Houston, TX 77031
TEL:+1.713.272.8822
FAX:+1.713.995.4994

SALES

Reseller and Consumer
sales@ikancorp.com

MARKETING

Sponsorship, Partnership, Brand Ambassadors, and Media
marketing@ikancorp.com

SUPPORT

Returns, exchanges, and general support
support@ikancorp.com